

**圖例 LEGEND**

- 方案界線  
BOUNDARY OF THE SCHEME
- 可收回地層的土地  
LAND UNDER WHICH UNDERGROUND STRATA MAY BE RESUMED
- 可收回的地層  
UNDERGROUND STRATA WHICH MAY BE RESUMED
- 擬建的鐵路車站  
PROPOSED RAILWAY STATION
- 擬建的鐵路軌道中心線  
PROPOSED RAILWAY TRACK CENTRE LINE
- 地層界線  
LOT BOUNDARY
- 參照線  
REFERENCE LINE MARK
- 參照線  
REFERENCE LINE
- IL  
RP  
& EXT  
S.  
SS.
- 內地段  
INLAND LOT
- 剩餘部分  
REMAINING PORTION
- 及其延伸部分  
AND THE EXTENSION THERE TO
- 分段  
SECTION
- 小分段  
SUB-SECTION

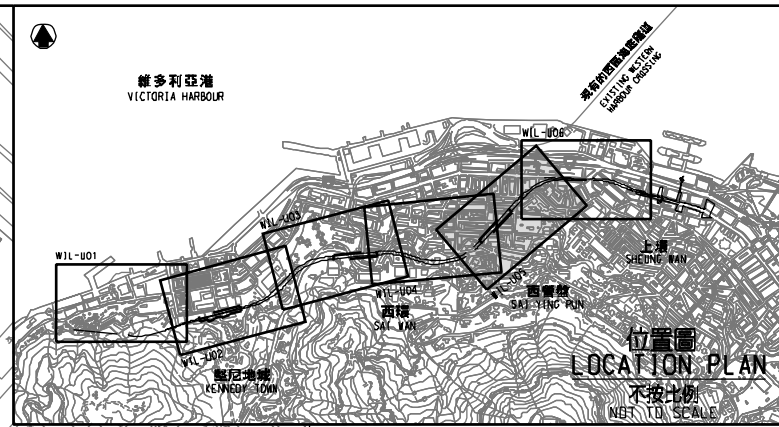
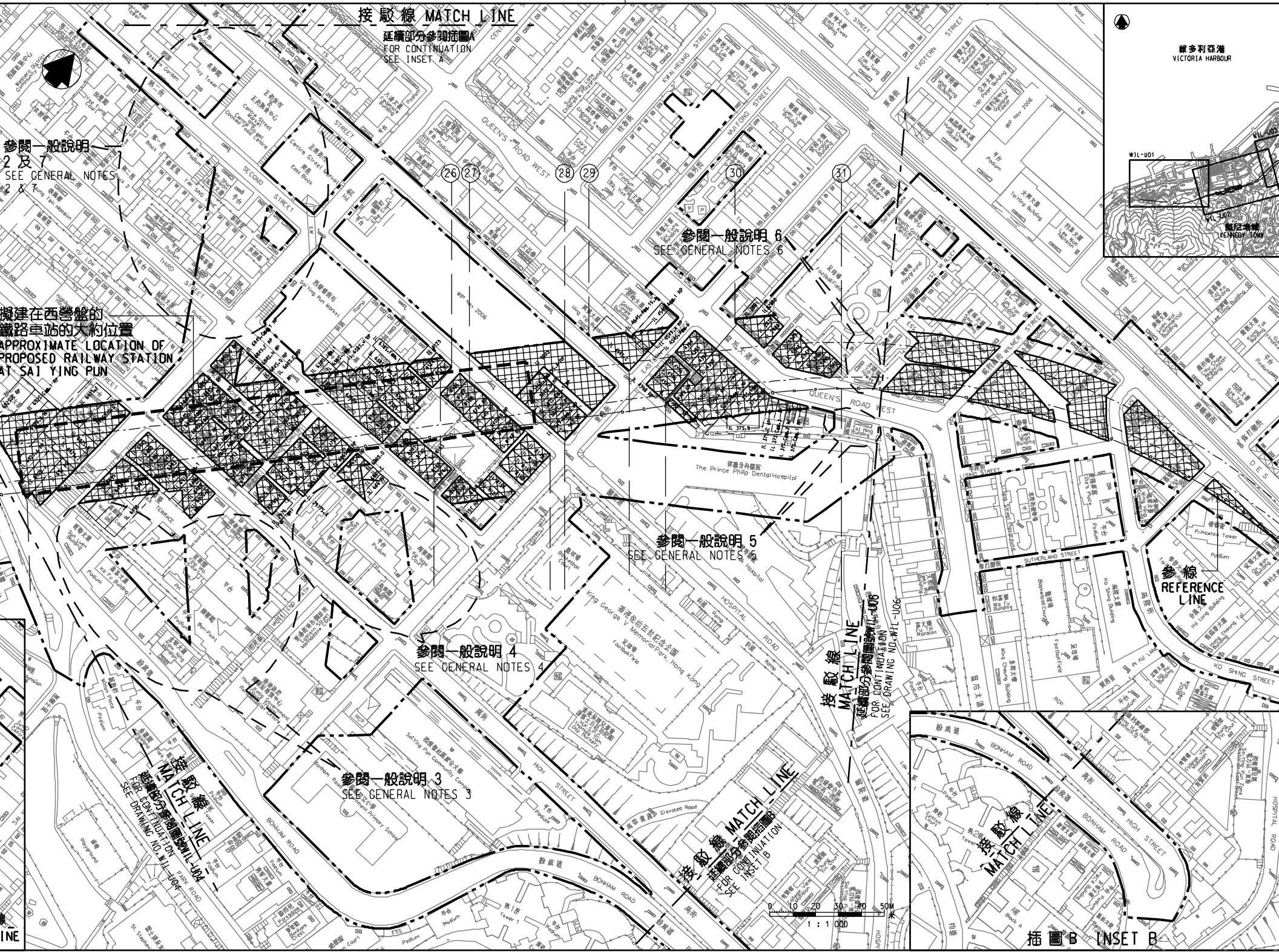

- 一般說明 GENERAL NOTES**
- 收回地層的細節在圖則第WIL-U10至WIL-U13號顯示。  
DETAILS OF UNDERGROUND STRATA RESUMPTION ARE SHOWN IN DRAWING NOS. WIL-U10 TO WIL-U13.
  - 收回的地層在圖則第WIL-U09號中以參照線-D的切面立視圖顯示。  
UNDERGROUND STRATA TO BE RESUMED ARE SHOWN IN THE SECTIONAL ELEVATION ALONG THE REFERENCE LINE D-D IN DRAWING NO. WIL-U09.
  - 收回的地層在圖則第WIL-U08號中以參照線-E的切面立視圖顯示。  
UNDERGROUND STRATA TO BE RESUMED ARE SHOWN IN THE SECTIONAL ELEVATION ALONG THE REFERENCE LINE E-E IN DRAWING NO. WIL-U08.
  - 收回的地層在圖則第WIL-U09號中以參照線-F的切面立視圖顯示。  
UNDERGROUND STRATA TO BE RESUMED ARE SHOWN IN THE SECTIONAL ELEVATION ALONG THE REFERENCE LINE F-F IN DRAWING NO. WIL-U09.
  - 收回的地層在圖則第WIL-U09號中以參照線-G的切面立視圖顯示。  
UNDERGROUND STRATA TO BE RESUMED ARE SHOWN IN THE SECTIONAL ELEVATION ALONG THE REFERENCE LINE G-G IN DRAWING NO. WIL-U09.
  - 收回的土地在圖則第WIL-L03號顯示。  
DETAILS OF LAND RESUMPTION ARE SHOWN IN DRAWING NO. WIL-L03.
  - 收回的土地在圖則第WIL-L02號顯示。  
DETAILS OF LAND RESUMPTION ARE SHOWN IN DRAWING NO. WIL-L02.
  - 沿參照線的切面立視圖顯示的±0.15米基準均為約數。  
THE ±0.15 MPDs SHOWN IN THE SECTIONAL ELEVATION ALONG REFERENCE LINE ARE APPROXIMATE.

修訂表  
TABLE OF AMENDMENTS

REV	DATE	BY	SUB	APP	DESCRIPTION

林超雄 LAM CHIU HUNG  
政府工程師/鐵路發展處(1)  
GOVERNMENT ENGINEER/RAILWAY DEVELOPMENT (1)  
高路局

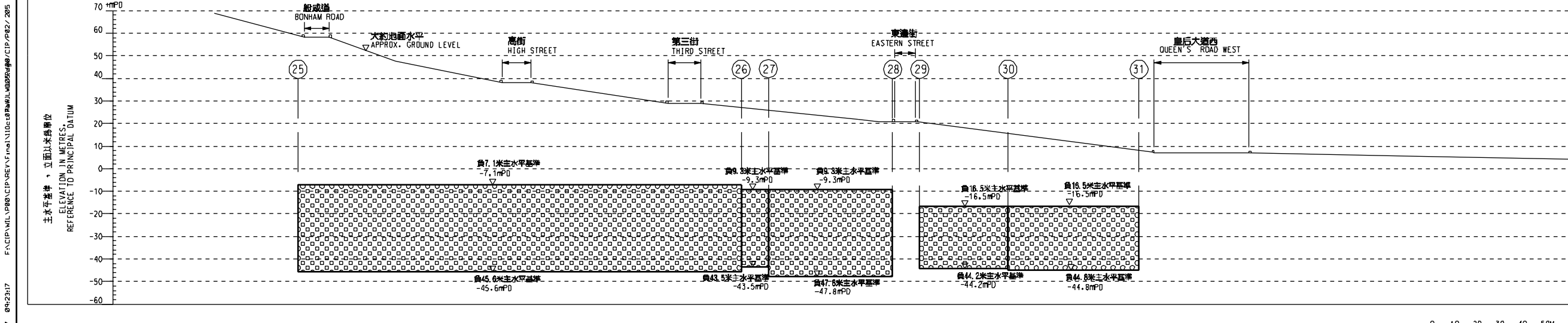

圖則名稱 DRAWING TITLE  
鐵路條例(第519章)  
地下鐵路(「地鐵」) - 西港高線  
收回地層圖則 13頁的第5頁

RAILWAYS ORDINANCE (CHAPTER 519)  
MASS TRANSIT RAILWAY (MTR) - WEST ISLAND LINE  
UNDERGROUND STRATA RESUMPTION PLAN  
SHEET 5 OF 13

圖號 DRAWING NO.  
WIL-U05

比例 SCALE  
1:1000 (A1)  
或如圖示  
AS SHOWN

香港特別行政區政府  
THE GOVERNMENT OF THE HONG KONG  
SPECIAL ADMINISTRATIVE REGION

路政署  
HIGHWAYS DEPARTMENT

鐵路拓展處  
RAILWAY DEVELOPMENT OFFICE

16/10/2007 08:23:17