

15/10/2007 16:22:43 F:\CIP\WIL\900\CIP\REV\Final\110\00\WIL\00\0000\CIP\002\001

DRAWING NO. WIL-G04

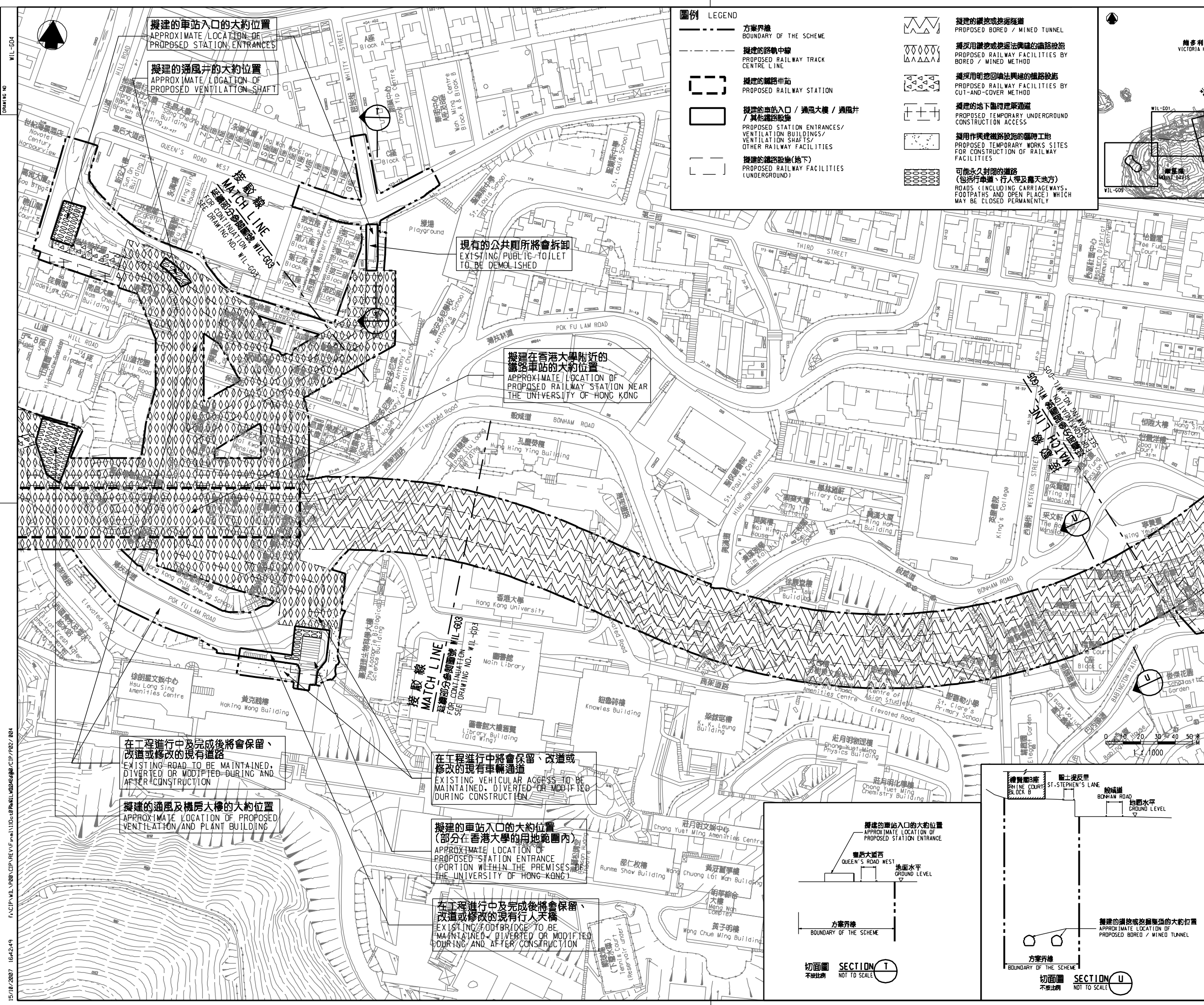

圖例 LEGEND

- 方案界線
BOUNDARY OF THE SCHEME
- 擬建的鐵路中線
PROPOSED RAILWAY TRACK CENTRE LINE
- 擬建的鐵路車站
PROPOSED RAILWAY STATION
- 擬建的車站入口 / 通風大樓 / 通風井 / 其他鐵路設施
PROPOSED STATION ENTRANCES / VENTILATION BUILDINGS / VENTILATION SHAFTS / OTHER RAILWAY FACILITIES
- 擬建的鐵路設施(地下)
PROPOSED RAILWAY FACILITIES (UNDERGROUND)

- 擬建的鑽挖或掘地隧道
PROPOSED BORED / MINED TUNNEL
- 擬採用鑽挖或掘地法興建的鐵路設施
PROPOSED RAILWAY FACILITIES BY BORED / MINED METHOD
- 擬採用明挖回填法興建的鐵路設施
PROPOSED RAILWAY FACILITIES BY CUT-AND-COVER METHOD
- 擬建的地下臨時建築通道
PROPOSED TEMPORARY UNDERGROUND CONSTRUCTION ACCESS
- 擬用作興建鐵路設施的臨時工地
PROPOSED TEMPORARY WORKS SITES FOR CONSTRUCTION OF RAILWAY FACILITIES
- 可能永久封閉的道路 (包括行車道、行人徑及露天地方)
ROADS (INCLUDING CARRIAGEWAYS, FOOTPATHS AND OPEN PLACE) WHICH MAY BE CLOSED PERMANENTLY

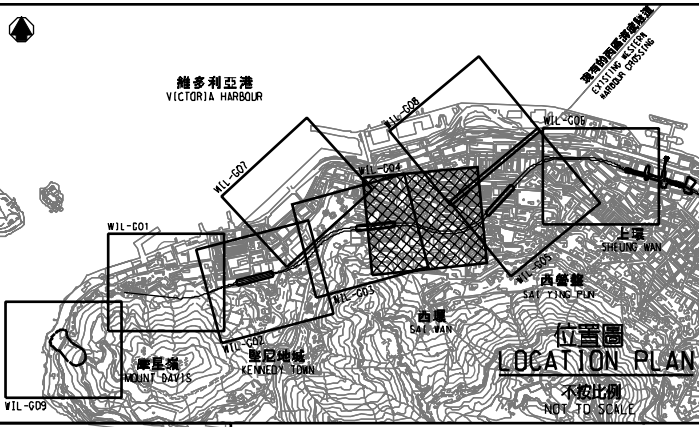

- 一般說明 GENERAL NOTES**
1. 剖面圖所示鐵路設施的形狀和輪廓均屬示意性質。 GEOMETRY AND CONFIGURATION OF RAILWAY FACILITIES SHOWN IN SECTIONS ARE SCHEMATIC.
 2. 所有在劃定方案界線內的道路 (包括行車道、行人徑及露天地方), 無論有否在圖則中顯示, 都有可能永久或暫時封閉或大幅改動。 ALL ROADS INCLUDING CARRIAGEWAYS, FOOTPATHS AND OPEN PLACE WITHIN THE BOUNDARY OF THE SCHEME, WHETHER OR NOT SHOWN ON THE DRAWINGS MAY BE CLOSED OR ALTERED SUBSTANTIALLY ON A PERMANENT OR TEMPORARY BASIS.
 3. 除非圖則中特別註明, 否則在方案界線內, 或與方案界線毗鄰的所有建築物的汽車進道及行人通道, 包括逃生路徑, 將會保留。 UNLESS NOTED OTHERWISE ON THE DRAWINGS, VEHICULAR AND PEDESTRIAN ACCESSES (INCLUDING MEANS OF ESCAPE TO AND FROM ALL BUILDINGS WITHIN OR ADJACENT TO THE BOUNDARY OF THE SCHEME ARE TO BE MAINTAINED.
 4. 所有水平均為約數, 以米為單位, 並高於香港的主水平基準。 ALL LEVELS ARE APPROXIMATE AND IN METRES ABOVE HONG KONG PRINCIPAL DATUM (mPD).
 5. 圖則顯示的建造方法分界線只是大略位置, 有關界線可因應當時的地盤情況而作出改動。 BOUNDARIES SHOWN ON DRAWINGS FOR THE CONSTRUCTION METHODS TO BE CARRIED OUT ARE APPROXIMATE ONLY. THESE BOUNDARIES MAY BE ALTERED ON SITE TO SUIT PREVAILING SITE CONDITIONS.

修訂表 TABLE OF AMENDMENTS

修改日期 REV DATE	日期 DATE	修訂 BY	審核 SUB	批准 APP	說明 DESCRIPTION

審批人: 林超雄 LAM CHEU HUNG
 審批職銜: 鐵路發展處處長(1) 政府工程師 / 鐵路發展處處長(1) 高級工程師
 發出日期 DATE OF ISSUE:

鐵路條例(第519章)
地下鐵路(「地鐵」) - 西港島線
總體規劃圖則 9頁的第4頁

RAILWAYS ORDINANCE (CHAPTER 519)
 MASS TRANSIT RAILWAY (MTR) - WEST ISLAND LINE
 GENERAL LAYOUT PLAN SHEET 4 OF 9

圖號 DRAWING NO. **WIL-G04** 比例 SCALE 1:1000 (A1) 或如顯示 AS SHOWN

香港特別行政區政府
 THE GOVERNMENT OF THE HONG KONG SPECIAL ADMINISTRATIVE REGION

路政署
 HIGHWAYS DEPARTMENT

鐵路拓展處
 RAILWAY DEVELOPMENT OFFICE

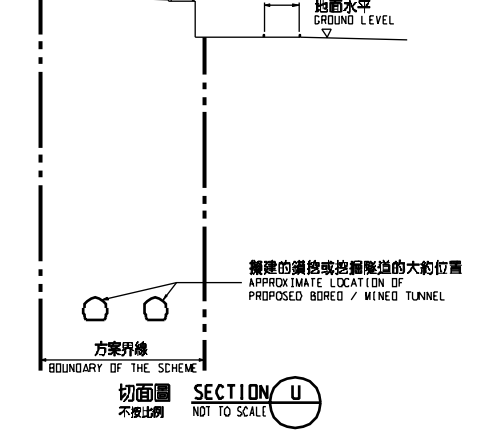
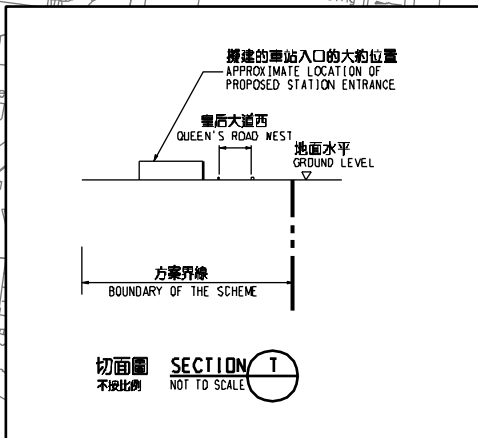

擬建的車站入口的大約位置
 APPROXIMATE LOCATION OF PROPOSED STATION ENTRANCES

擬建的通風井的大約位置
 APPROXIMATE LOCATION OF PROPOSED VENTILATION SHAFT

現有的公共廁所將會拆卸
 EXISTING PUBLIC TOILET TO BE DEMOLISHED

擬建在香港大學附近的鐵路車站的大約位置
 APPROXIMATE LOCATION OF PROPOSED RAILWAY STATION NEAR THE UNIVERSITY OF HONG KONG

在工程進行中及完成後將會保留、改道或修改的現有道路
 EXISTING ROAD TO BE MAINTAINED, DIVERTED OR MODIFIED DURING AND AFTER CONSTRUCTION

在工程進行中將會保留、改道或修改的現有車輛通道
 EXISTING VEHICULAR ACCESS TO BE MAINTAINED, DIVERTED OR MODIFIED DURING CONSTRUCTION

擬建的通風及機房大樓的大約位置
 APPROXIMATE LOCATION OF PROPOSED VENTILATION AND PLANT BUILDING

擬建的車站入口的大約位置 (部分在香港大學的用地範圍內)
 APPROXIMATE LOCATION OF PROPOSED STATION ENTRANCE (PORTION WITHIN THE PREMISES OF THE UNIVERSITY OF HONG KONG)

在工程進行中及完成後將會保留、改道或修改的現有行人天橋
 EXISTING FOOTBRIDGE TO BE MAINTAINED, DIVERTED OR MODIFIED DURING AND AFTER CONSTRUCTION