

DRAWING NO. WIL-U01

13/3/2009 13:34:04 D:\Print\Frontier\Leung\13\9\09\WIL-U01\WIL-U01.dwg\CIP/P02/201

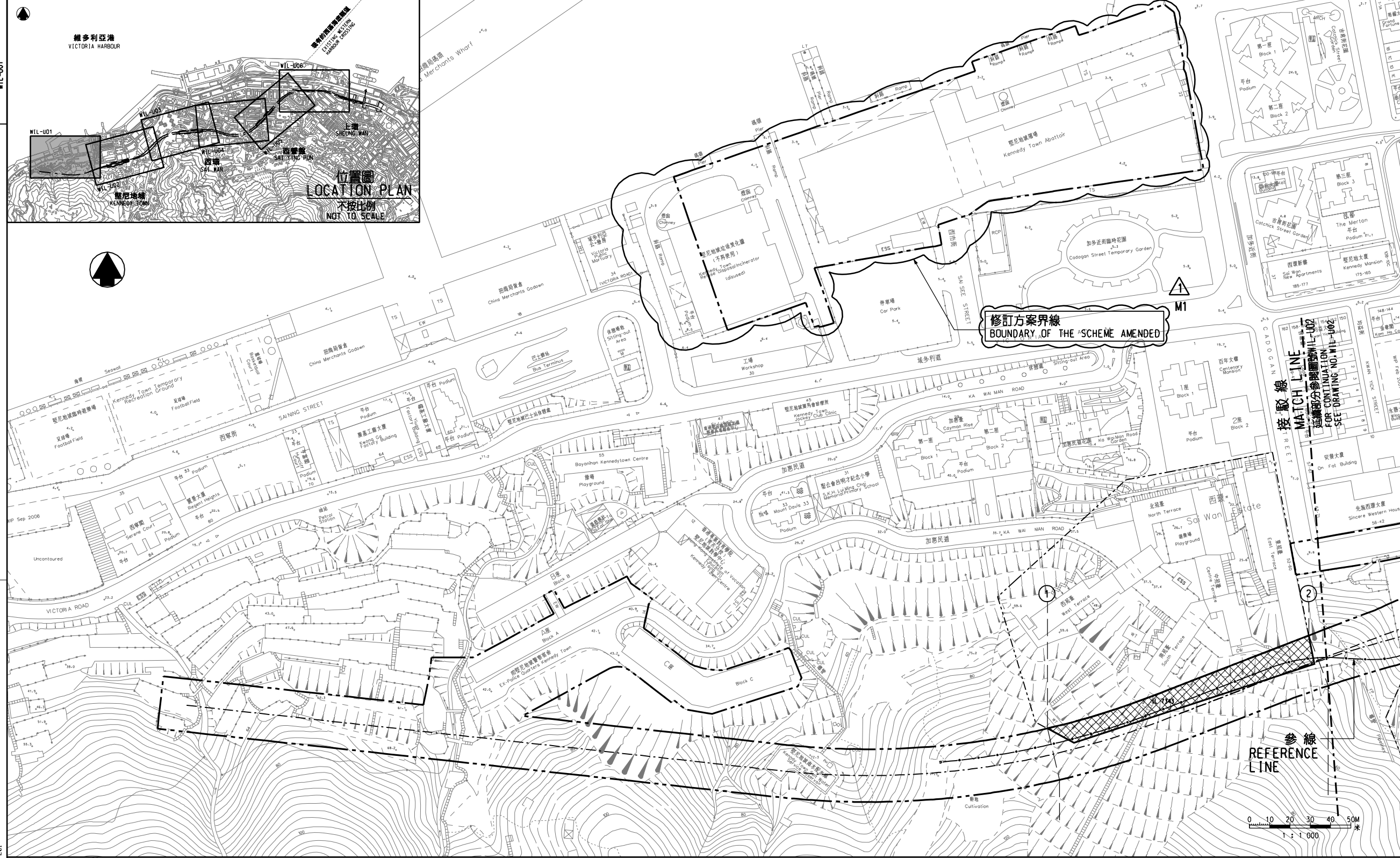

- 圖例 LEGEND**
- 方案界線
BOUNDARY OF THE SCHEME
 - 可收回地層的土地
LAND UNDER WHICH UNDERGROUND STRATA MAY BE RESUMED
 - 可收回的地層
UNDERGROUND STRATA WHICH MAY BE RESUMED
 - 擬議的軌道中線
PROPOSED RAILWAY TRACK CENTRE LINE
 - 地段界線
LOT BOUNDARY
 - 參線
REFERENCE LINE MARK
 - 參線
REFERENCE LINE
 - IL
內地段 INLAND LOT
 - 圖則修改
DRAWING REVISION
 - 修改參考編號(參看憲報公告)
MODIFICATION REFERENCE NUMBER (SEE GAZETTE NOTICE)
 - 修改範圍
MODIFICATION AREA

- 一般說明 GENERAL NOTES**
- 收回地層的細節在圖則第WIL-U10至WIL-U13號顯示。
DETAILS OF UNDERGROUND STRATA RESUMPTION ARE SHOWN IN DRAWING NOS. WIL-U10 TO WIL-U13.
 - 沿參線的切面立視圖顯示的正/負主水平基準均為約數。
THE +/- mPDs SHOWN IN THE SECTIONAL ELEVATION ALONG REFERENCE LINE ARE APPROXIMATE.

**AUTHORIZED BY
CHIEF EXECUTIVE IN COUNCIL
經行政長官會同行政會議批准**

**修訂表
TABLE OF AMENDMENTS**

修改日期 REV DATE	編者 BY	核對 SUB	負責 APP	修改項目 MODIFICATION ITEM	說明 DESCRIPTION
02 MAR 2009	KW	DN	PP	修改項目 M1 MODIFICATION ITEM M1	

批准發出
APPROVED FOR ISSUE

林超雄 LAM CHIU HUNG
路政署
鐵路拓展處處長(1)
GOVERNMENT ENGINEER/
RAILWAY DEVELOPMENT (1)
HIGHWAYS DEPARTMENT

發出日期 DATE OF ISSUE

圖則名稱 DRAWING TITLE

**鐵路條例(第519章)
地下鐵路(「地鐵」) - 西港島線
收回地層圖則 13頁的第1頁**

RAILWAYS ORDINANCE (CHAPTER 519)
MASS TRANSIT RAILWAY (MTR) - WEST ISLAND LINE
UNDERGROUND STRATA RESUMPTION PLAN
SHEET 1 OF 13

圖號 DRAWING NO. **WIL-U01**

比例 SCALE 1:1000 (A1)
或如顯示
AS SHOWN

**香港特別行政區政府
THE GOVERNMENT OF THE HONG KONG
SPECIAL ADMINISTRATIVE REGION**

**路政署
HIGHWAYS DEPARTMENT**

**鐵路拓展處
RAILWAY DEVELOPMENT OFFICE**

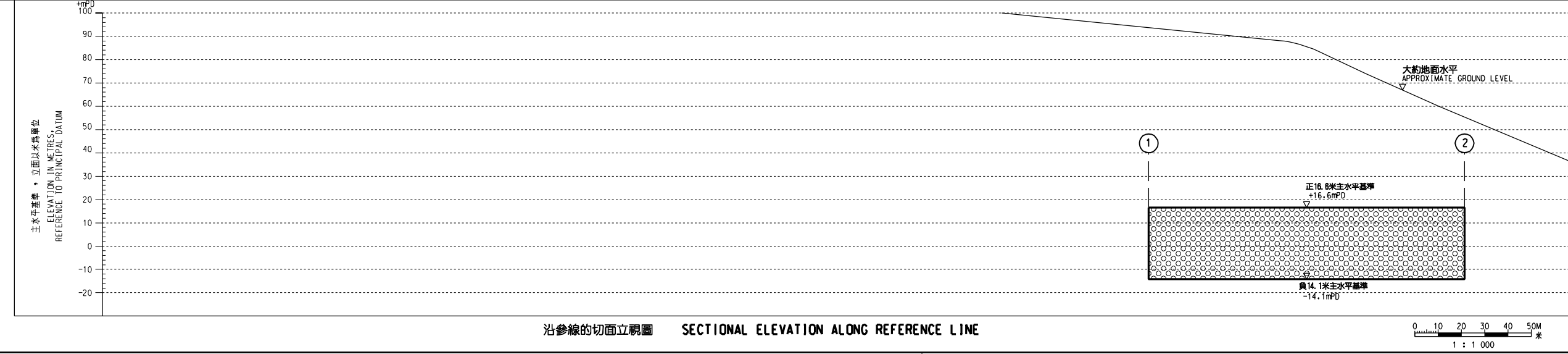

沿參線的切面立視圖 SECTIONAL ELEVATION ALONG REFERENCE LINE

