

DRAWING NO. WIL/G08/0005/1
 PLOT DRW: E:\lib\p1\118\vb\p1\inter.plt
 PRINTED BY: ka/mw 23/02/2010 14:41:36
 FILENAME: f:\csp\w\p00\csp\road\cbsure\wil-g08-0005-ldgn

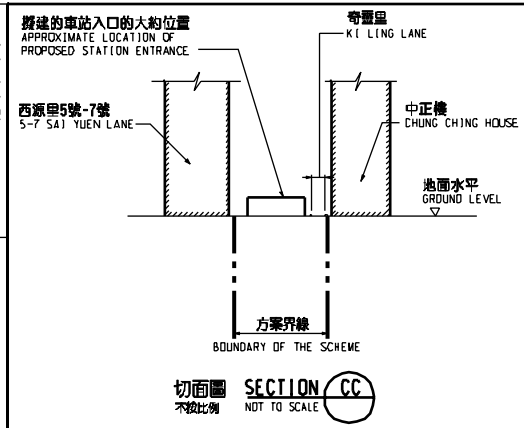

圖例 LEGEND

- 方案界線
BOUNDARY OF THE SCHEME
- 擬建的車站入口 / 通風大樓 / 通風井 / 其他鐵路設施
PROPOSED STATION BUILDINGS / VENTILATION BUILDINGS / VENTILATION SHAFTS / OTHER RAILWAY FACILITIES
- 擬建的鐵路設施(地下)
PROPOSED RAILWAY FACILITIES (UNDERGROUND)
- 擬採用鑽挖或掘掘法興建的鐵路設施
PROPOSED RAILWAY FACILITIES BY BORED / MINED METHOD
- 擬採用明挖回填法興建的鐵路設施
PROPOSED RAILWAY FACILITIES BY CUT-AND-COVER METHOD
- 擬用作興建鐵路設施的臨時工地
PROPOSED TEMPORARY WORKS SITES FOR CONSTRUCTION OF RAILWAY FACILITIES
- 可能永久封閉的道路 (包括行車道、行人徑及露天地方)
ROADS (INCLUDING CARRIAGEWAYS, FOOTPATHS AND OPEN PLACE) WHICH MAY BE CLOSED PERMANENTLY
- 圖則修改
DRAWING REVISION
- A1 修訂參考編號(參考憲報公告)
AMENDMENT REFERENCE NUMBER (SEE GAZETTE NOTICE)
- 修訂範圍
AMENDMENT AREA

說明 NOTES

此圖根據第WIL - G08號(修改 1)圖則制訂, 以黃色標明奇靈里遊樂場將暫時封閉的休憩用地, 分別以紅色和藍色標明奇靈里和毗鄰奇靈里遊樂場的道路將暫時封閉部分行人路路面的路面, 分別以粉紅色和啡色標明德輔道西和皇后大道西將暫時封閉部分行車道及行人路路面的路面, 及分別以綠色和棕色標明奇靈里及德輔道西將暫時封閉的部分行人路路面的路面。

THIS DRAWING IS PREPARED BASED ON DRAWING NO. WIL-G08 (REVISION 1) AND IS INTENDED TO SHOW THE OPEN SPACE IN KI LING LANE PLAYGROUND (HIGHLIGHTED IN YELLOW) TO BE TEMPORARILY CLOSED, SECTIONS OF KI LING LANE AND THE ROAD ADJACENT TO KI LING LANE PLAYGROUND (HIGHLIGHTED IN RED AND BLUE RESPECTIVELY) OF WHICH PARTS OF THE FOOTPATH WIDTHS ARE TO BE TEMPORARILY CLOSED, SECTIONS OF DES VOEUX ROAD WEST AND QUEEN'S ROAD WEST (HIGHLIGHTED IN PINK AND BROWN RESPECTIVELY) OF WHICH PARTS OF THE CARRIAGEWAY AND FOOTPATH WIDTHS ARE TO BE TEMPORARILY CLOSED, AND SECTIONS OF KI LING LANE AND DES VOEUX ROAD WEST (HIGHLIGHTED IN GREEN AND ORANGE RESPECTIVELY) OF WHICH PARTS OF THE FOOTPATH WIDTHS ARE TO BE TEMPORARILY ALTERED.

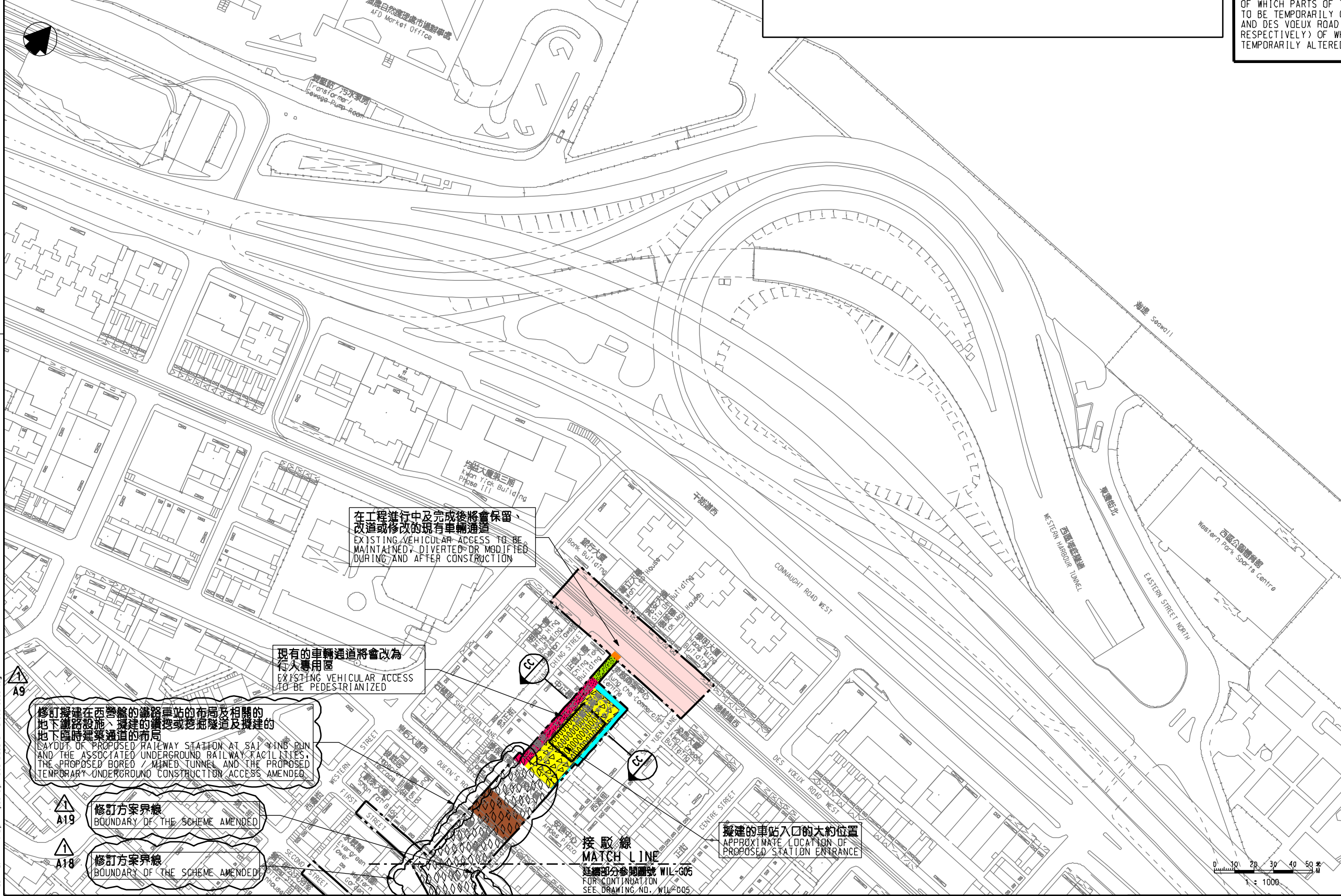

- 無論有否在圖則中顯示, 所有可能自來水或電氣時均或因人為改動。ALL ROADS INCLUDING CARRIAGEWAYS, FOOTPATHS AND OPEN PLACE WITHIN THE BOUNDARY OF THE SCHEME, WHETHER OR NOT SHOWN ON THE DRAWINGS MAY BE CLOSED OR ALTERED SUBSTANTIALLY ON A PERMANENT OR TEMPORARY BASIS.
- 除非圖則中特別註明, 否則在方案界線內, 或與方案界線毗鄰的所有建築物的汽車進出及行人通道, 包括逃生路徑, 將會保留。UNLESS NOTED OTHERWISE ON THE DRAWINGS, VEHICULAR AND PEDESTRIAN ACCESSES INCLUDING MEANS OF ESCAPE TO AND FROM ALL BUILDINGS WITHIN OR ADJACENT TO THE BOUNDARY OF THE SCHEME ARE TO BE MAINTAINED.
- 所有水平均為約數, 以米為單位, 並高於香港的主水平基準。ALL LEVELS ARE APPROXIMATE AND IN METRES ABOVE HONG KONG PRINCIPAL DATUM (mPD).
- 圖則顯示的建造方法分界線只是大體位置, 有關界線可因應當時的地盤情況而作出改動。BOUNDARIES SHOWN ON DRAWINGS FOR THE CONSTRUCTION METHODS TO BE CARRIED OUT ARE APPROXIMATE ONLY. THESE BOUNDARIES MAY BE ALTERED ON SITE TO SUIT PREVAILING SITE CONDITIONS.

修訂表 TABLE OF AMENDMENTS					
修訂號 REV	日期 DATE	修訂 BY	檢核 SUB	審批 APP	說明 DESCRIPTION

SIGNED

何博權 HO PING KUEN
 鐵路發展處工程師 (2-1)
 CHIEF ENGINEER / RAILWAY DEVELOPMENT (2-1)
 HIGHWAYS DEPARTMENT

10/2/2010
 發出日期 DATE OF ISSUE

圖則名稱 DRAWING TITLE
鐵路條例(第519章)
地下鐵路(「地鐵」) - 西港島線
 暫時封閉奇靈里遊樂場的休憩用地, 部分奇靈里、毗鄰奇靈里遊樂場的道路、德輔道西和皇后大道西及暫時改動部分奇靈里和德輔道西作為車輛出入通道
 RAILWAYS ORDINANCE (CHAPTER 519)
 MASS TRANSIT RAILWAY (MTR) - WEST ISLAND LINE
 TEMPORARY CLOSURE OF THE OPEN SPACE IN KI LING LANE PLAYGROUND, SECTIONS OF KI LING LANE, THE ROAD ADJACENT TO KI LING LANE PLAYGROUND, DES VOEUX ROAD WEST AND QUEEN'S ROAD WEST, AND TEMPORARY ALTERATION OF SECTIONS OF KI LING LANE AND DES VOEUX ROAD WEST AS VEHICULAR ACCESS

圖號 DRAWING NO.
WIL/G08/0005/1

比例 SCALE
 1:1000 (A1)
 或如顯示
 OR AS SHOWN

香港特別行政區政府
 THE GOVERNMENT OF THE HONG KONG
 SPECIAL ADMINISTRATIVE REGION

路政署
 HIGHWAYS DEPARTMENT

鐵路拓展處
 RAILWAY DEVELOPMENT OFFICE