

圖例 LEGEND

- 方案界線
BOUNDARY OF THE SCHEME
- 擬議的車站入口 / 通風大樓 / 通風井 / 其他鐵路設施
PROPOSED STATION ENTRANCES / VENTILATION BUILDINGS / VENTILATION SHAFTS / OTHER RAILWAY FACILITIES
- 擬議的鐵路設施(地下)
PROPOSED RAILWAY FACILITIES (UNDERGROUND)
- 掘穿用掘進或掘孔法開挖的鐵路設施
PROPOSED RAILWAY FACILITIES BY BORED / MINED METHOD
- 掘穿用掘進即掘孔開挖的鐵路設施
PROPOSED RAILWAY FACILITIES BY CUT-AND-COVER METHOD
- 擬用作興建鐵路設施的臨時工地
PROPOSED TEMPORARY WORKS SITES FOR CONSTRUCTION OF RAILWAY FACILITIES
- 可能永久封閉的道路 (包括行車道、行人地及露天地方)
ROADS (INCLUDING CARRIAGEWAYS, FOOTPATHS AND OPEN PLACES) WHICH MAY BE CLOSED PERMANENTLY
- 圖則修改
DRAWING REVISION
- A1 修訂參考編號(參考憲報公告)
AMENDMENT REFERENCE NUMBER (SEE GAZETTE NOTICE)
- 修訂範圍
AMENDMENT AREA

說明 NOTES

此圖根據第WIL-G08號(修改 1)圖則制訂, 以紫色標明將永久封閉的部分奇靈里兒童遊樂場; 以黃色標明將暫時封閉的部分奇靈里兒童遊樂場; 分別以紅色、藍色和粉紅色標明將暫時封閉的部分奇靈里、毗鄰奇靈里兒童遊樂場的道路和德輔道西路段, 及分別以綠色和橙色標明將暫時改動的奇靈里和德輔道西路段為車輛通道。

THIS DRAWING IS PREPARED BASED ON DRAWING NO. WIL-G08 (REVISION 1) AND IS INTENDED TO SHOW THE PERMANENT CLOSURE OF PART OF KI LING LANE CHILDREN'S PLAYGROUND (HIGHLIGHTED IN PURPLE), THE TEMPORARY CLOSURE OF PART OF KI LING LANE CHILDREN'S PLAYGROUND (HIGHLIGHTED IN YELLOW), THE TEMPORARY PARTIAL CLOSURE OF SECTIONS OF KI LING LANE, THE ROAD ADJACENT TO KI LING LANE CHILDREN'S PLAYGROUND AND DES VOEUX ROAD WEST (HIGHLIGHTED IN RED, BLUE AND PINK RESPECTIVELY), AND THE TEMPORARY ALTERATION OF SECTIONS OF KI LING LANE AND DES VOEUX ROAD WEST AS VEHICULAR ACCESS (HIGHLIGHTED IN GREEN AND ORANGE RESPECTIVELY).

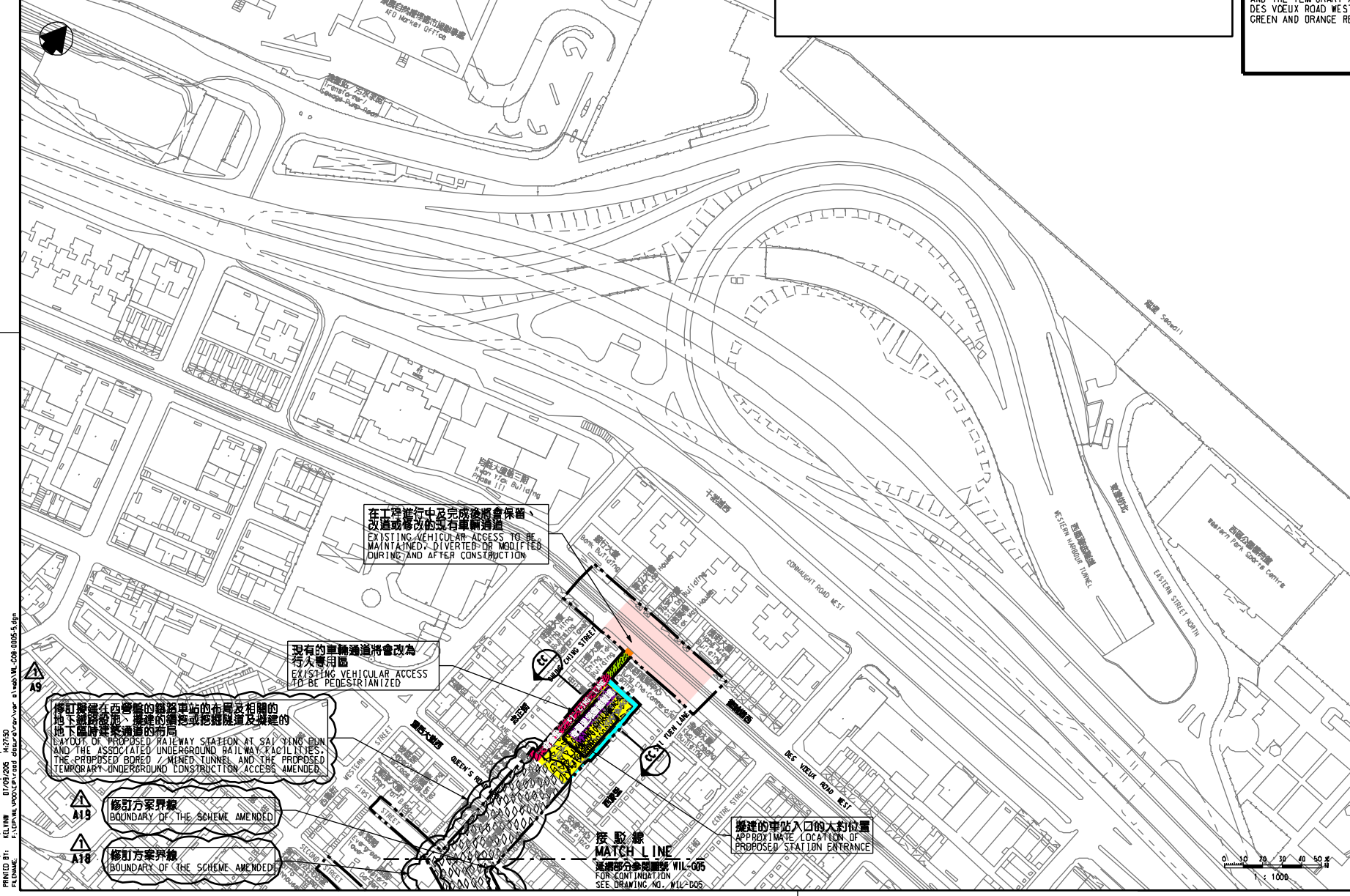

- WITHIN THE BOUNDARY OF THE SCHEME, WHETHER OR NOT SHOWN ON THE DRAWINGS MAY BE CLOSED OR ALTERED SUBSTANTIALLY ON A PERMANENT OR TEMPORARY BASIS.
- 除非圖則中特別註明, 否則在方案界線內, 或與方案界線毗鄰的所有建築物均將保留及人進入, 包括逃生通道。將會保留。UNLESS NOTED OTHERWISE ON THE DRAWINGS, VEHICULAR AND PEDESTRIAN ACCESSES INCLUDING MEANS OF ESCAPE TO AND FROM ALL BUILDINGS WITHIN OR ADJACENT TO THE BOUNDARY OF THE SCHEME ARE TO BE MAINTAINED.
 - 所有水平均為約數, 以米為單位, 並應以香港的主水平基準。HONG KONG PRINCIPAL DATUM (mPD).
 - 圖則顯示的邊地方法界線只是大概位置, 有關界線可因應地勢的改變而作出修改。BOUNDARIES SHOWN ON DRAWINGS FOR THE CONSTRUCTION METHODS TO BE CARRIED OUT ARE APPROXIMATE ONLY. THESE BOUNDARIES MAY BE ALTERED ON SITE TO SUIT PREVAILING SITE CONDITIONS.

6.1A
TABLE OF AMENDMENTS

圖則 REV	日期 DATE	類別 BY	說明 DESCRIPTION

SIGNED

批准人
APPROVED FOR ISSUE

4/9/2015

簽發日期
DATE OF ISSUE

圖則名稱
DRAWING TITLE

**鐵路條例(第519章)
地下鐵路(「地鐵」) - 西港島綫**

本圖則顯示奇靈里兒童遊樂場; 暫時封閉部分奇靈里兒童遊樂場; 以及奇靈里、毗鄰奇靈里兒童遊樂場的道路和德輔道西路段; 以及奇靈里和德輔道西路段為車輛通道。

RAILWAYS ORDINANCE (CHAPTER 519)
MASS TRANSIT RAILWAY (MTR) - WEST ISLAND LINE

圖則號碼
DRAWING NO.

WIL/G08/0005/5

比例
SCALE

1:1000 (A1)

或
OR
AS SHOWN

**香港特別行政區政府
THE GOVERNMENT OF THE HONG KONG
SPECIAL ADMINISTRATIVE REGION**

**路政署
HIGHWAYS DEPARTMENT**

**鐵路拓展處
RAILWAY DEVELOPMENT OFFICE**

PLOT DRY: E:\16\Re\16\04\Printer.dwt
PRINTED BY: RELIANT 01/09/2005 14:27:50
FILENAME: F:\P\16\04\01\16_04_01\16_04_01_005_5.dgn