

SECTION Z
切面圖 不按比例

擬建作連接高街及般咸道的樓梯及樓梯的大約位置
APPROXIMATE LOCATION OF PROPOSED LIFT AND STAIR LINKING BONHAM ROAD AND HIGH STREET

SECTION V
切面圖 不按比例

擬建作連接高街及般咸道的樓梯及樓梯的大約位置
APPROXIMATE LOCATION OF PROPOSED LIFT AND STAIR LINKING BONHAM ROAD AND HIGH STREET

SECTION W
切面圖 不按比例

擬建作連接高街及般咸道的樓梯及樓梯的大約位置
APPROXIMATE LOCATION OF PROPOSED LIFT AND STAIR LINKING BONHAM ROAD AND HIGH STREET

SECTION X
切面圖 不按比例

擬建作連接高街及般咸道的樓梯及樓梯的大約位置
APPROXIMATE LOCATION OF PROPOSED LIFT AND STAIR LINKING BONHAM ROAD AND HIGH STREET

SECTION Y
切面圖 不按比例

擬建作連接高街及般咸道的樓梯及樓梯的大約位置
APPROXIMATE LOCATION OF PROPOSED LIFT AND STAIR LINKING BONHAM ROAD AND HIGH STREET

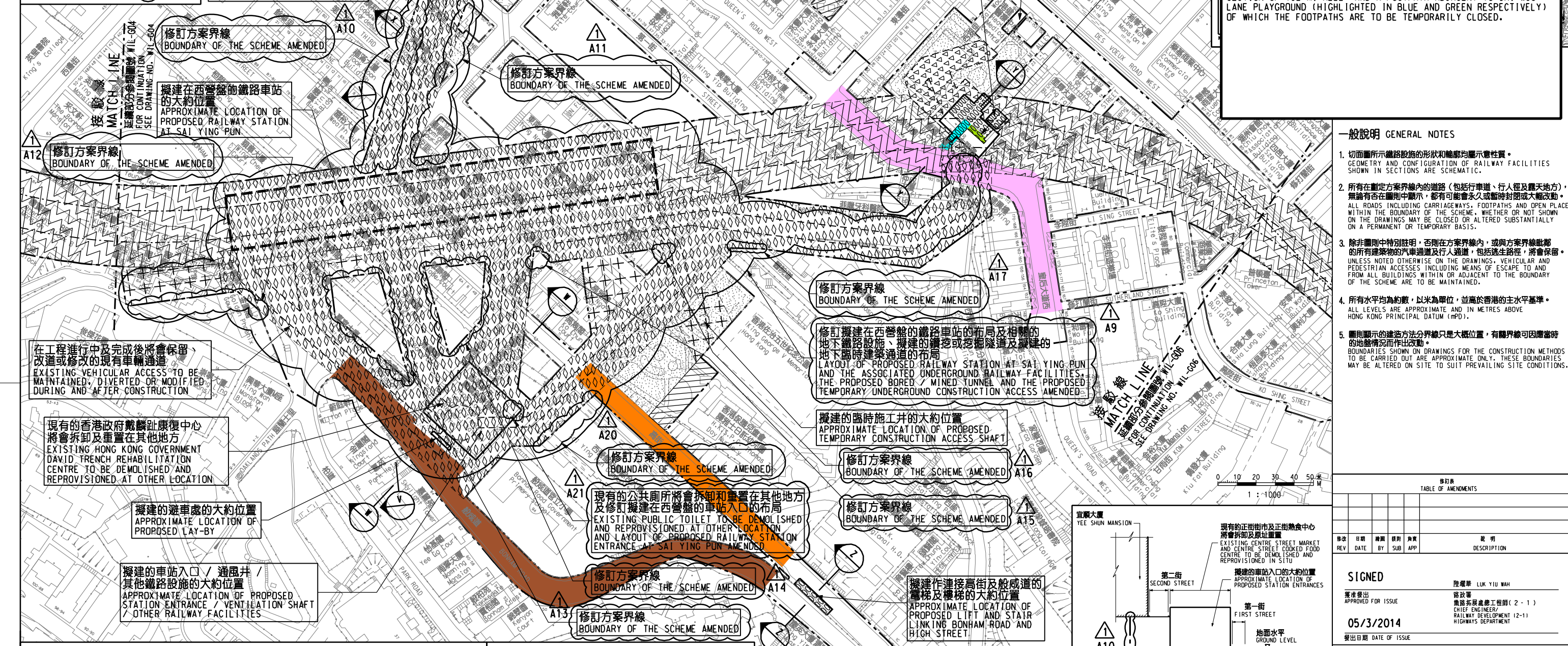

說明 NOTES

此圖根據第WIL-G05號(修改 1)圖則制訂，分別以橙色、啡色和粉紅色標明將暫時封閉的高街、般咸道和皇后大道西的部分行車道及行人路路面的路面，以及分別以藍色和綠色標明將暫時封閉的紫薇街路段和毗鄰西湖里遊樂場的行人徑的路面。

THIS DRAWING IS PREPARED ON DRAWING NO. WIL-G05 (REVISION 1) AND IS INTENDED TO SHOW SECTIONS OF HIGH STREET, BONHAM ROAD AND QUEEN'S ROAD WEST (HIGHLIGHTED IN ORANGE, BROWN AND PINK RESPECTIVELY) OF WHICH PARTS OF THE CARRIAGEWAY AND FOOTPATH WIDTHS ARE TO BE TEMPORARILY CLOSED, AND A SECTION OF TSZ MI ALLEY AND A FOOTPATH ADJACENT TO SAI WOO LANE PLAYGROUND (HIGHLIGHTED IN BLUE AND GREEN RESPECTIVELY) OF WHICH THE FOOTPATHS ARE TO BE TEMPORARILY CLOSED.

- 一般說明 GENERAL NOTES**
1. 切面圖所示鐵路設施的形狀和輪廓均屬示意性質。
GEOMETRY AND CONFIGURATION OF RAILWAY FACILITIES SHOWN IN SECTIONS ARE SCHEMATIC.
 2. 所有在劃定方案界線內的道路(包括行車道、行人徑及露天地方)，無論有否在圖則中顯示，都有可能永久或暫時封閉或大範圍改動。
ALL ROADS INCLUDING CARRIAGEWAYS, FOOTPATHS AND OPEN PLACE WITHIN THE BOUNDARY OF THE SCHEME, WHETHER OR NOT SHOWN ON THE DRAWINGS MAY BE CLOSED OR ALTERED SUBSTANTIALLY ON A PERMANENT OR TEMPORARY BASIS.
 3. 除非圖則中特別註明，否則在方案界線內，或與方案界線毗鄰的所有建築物的汽車通道及行人通道，包括逃生路徑，將會保留。
UNLESS NOTED OTHERWISE ON THE DRAWINGS, VEHICULAR AND PEDESTRIAN ACCESSES INCLUDING MEANS OF ESCAPE TO AND FROM ALL BUILDINGS WITHIN OR ADJACENT TO THE BOUNDARY OF THE SCHEME ARE TO BE MAINTAINED.
 4. 所有水平均為約數，以米為單位，並高於香港的主水平基準。
ALL LEVELS ARE APPROXIMATE AND IN METRES ABOVE HONG KONG PRINCIPAL DATUM (HPD).
 5. 圖則顯示的建造方法分界線只是大抵位置，有關界線可因應當時的地盤情況而作出改動。
BOUNDARIES SHOWN ON DRAWINGS FOR THE CONSTRUCTION METHODS TO BE CARRIED OUT ARE APPROXIMATE ONLY. THESE BOUNDARIES MAY BE ALTERED ON SITE TO SUIT PREVAILING SITE CONDITIONS.

修訂表
TABLE OF AMENDMENTS

修訂	日期	繪圖	類別	性質	說明
REV	DATE	BY	SUB	APP	DESCRIPTION

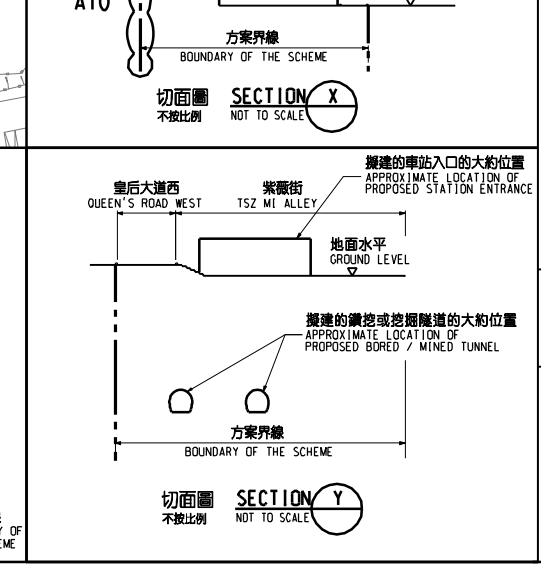
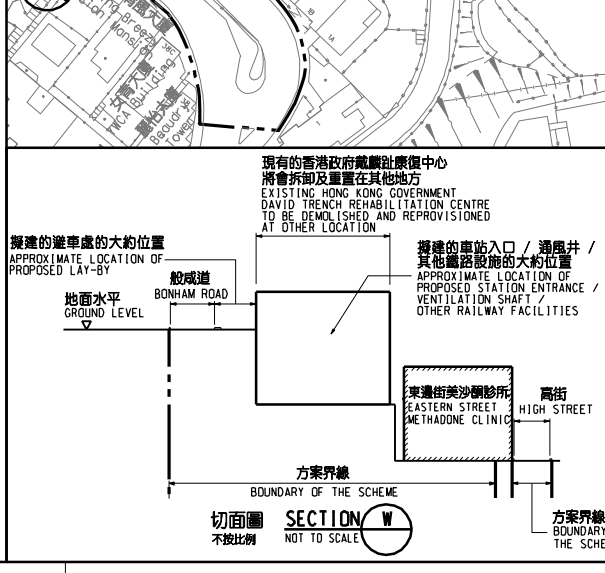
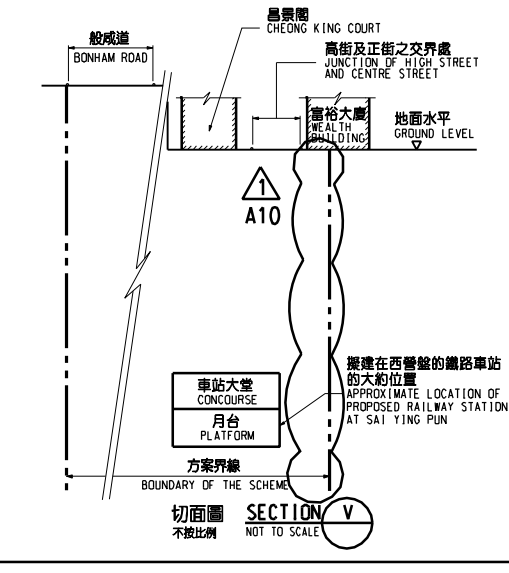
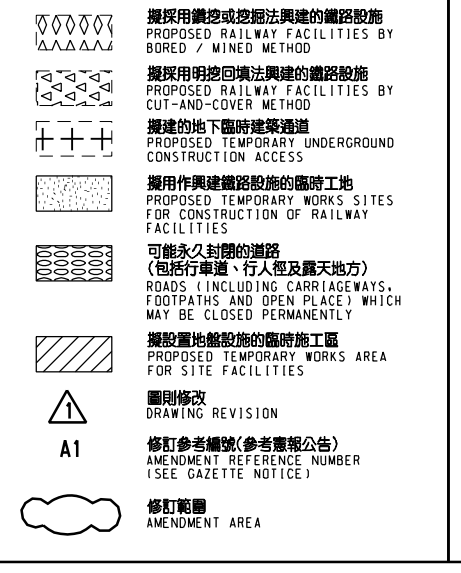
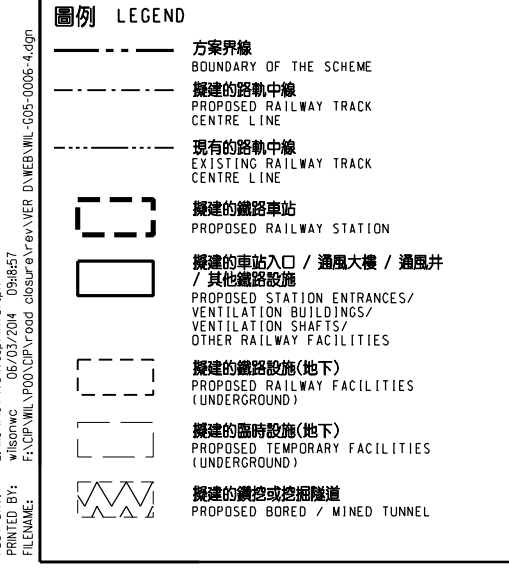

SIGNED

陸耀華 LUK YIU WAH
路政署
鐵路拓展處處長(2-1)
CHIEF ENGINEER
RAILWAY DEVELOPMENT (2-1)
HIGHWAYS DEPARTMENT

05/3/2014
發出日期 DATE OF ISSUE

鐵路條例(第519章)
地下鐵路(「地鐵」) - 西港島線
暫時封閉高街、般咸道、皇后大道西和紫薇街路段，及毗鄰西湖里遊樂場的行人徑

RAILWAYS ORDINANCE (CHAPTER 519)
MASS TRANSIT RAILWAY (MTR) - WEST ISLAND LINE
TEMPORARY CLOSURE OF SECTIONS OF HIGH STREET, BONHAM ROAD, QUEEN'S ROAD WEST AND TSZ MI ALLEY, AND A FOOTPATH ADJACENT TO SAI WOO LANE PLAYGROUND

圖號 DRAWING NO. WIL/G05/0006/4
比例 SCALE 1:1000 (A1)
或如顯示 OR AS SHOWN

香港特別行政區政府
THE GOVERNMENT OF THE HONG KONG
SPECIAL ADMINISTRATIVE REGION
路政署
HIGHWAYS DEPARTMENT
鐵路拓展處
RAILWAY DEVELOPMENT OFFICE