

DRAWING NO. SCL-G38

1:1000

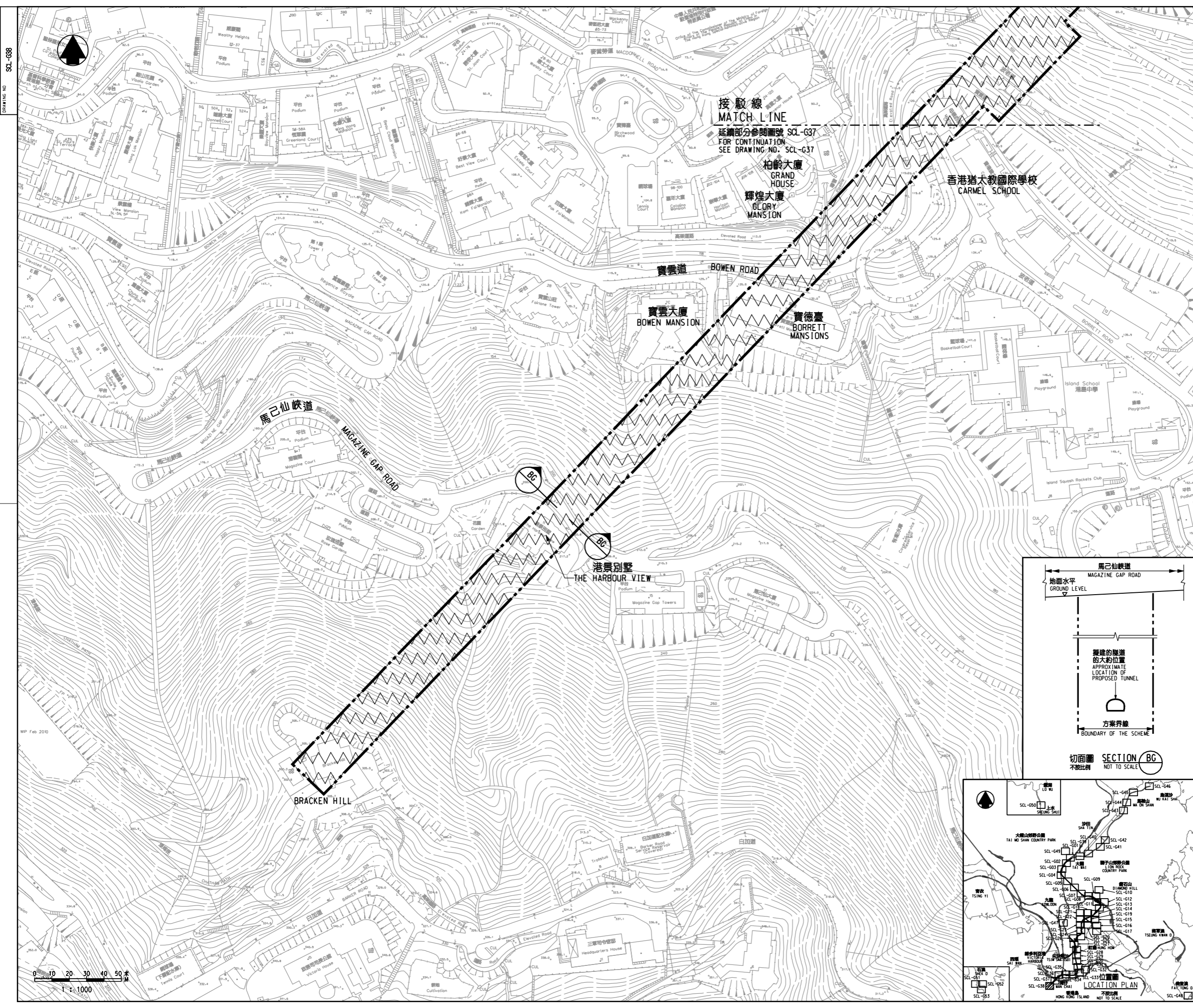

圖例 LEGEND

- 方案界線
BOUNDARY OF THE SCHEME
- 擬建的鐵路車站及其他鐵路設施(地下)
PROPOSED RAILWAY STATION AND OTHER RAILWAY FACILITIES (UNDERGROUND)
- 擬建的車站 / 車站入口 / 通風大樓 / 通風井
其他鐵路設施永久建築物
PROPOSED RAILWAY STATION/STATION ENTRANCES/VENTILATION BUILDINGS/VENTILATION SHAFTS/OTHER RAILWAY FACILITIES OR PERMANENT STRUCTURES
- 現有的車站及其他鐵路設施
EXISTING STATION AND OTHER RAILWAY FACILITIES
- 擬採用鑽探或掘削的鐵路設施或隧道(地下)
PROPOSED RAILWAY FACILITIES/TUNNEL BY BORED/MINED/DRILL AND BLAST METHOD (UNDERGROUND)
- 擬採用明挖回填法興建的鐵路設施或隧道(地下)
PROPOSED RAILWAY FACILITIES/TUNNEL BY CUT-AND-COVER METHOD (UNDERGROUND)
- 可能永久封閉的道路(包括行車道、行人徑及露天地方)
WHICH MAY BE CLOSED PERMANENTLY
ROADS INCLUDING CARRIAGEWAYS, FOOTPATHS AND OPEN PLACES WHICH MAY BE CLOSED PERMANENTLY
- 擬設置地盤設施的臨時施工區
PROPOSED TEMPORARY WORKS AREA FOR SITE FACILITIES
- 擬於政府前濱或海床設置地盤設施的臨時施工區
(可能在其上進行填海工程(非為形成土地)或其他工程)
PROPOSED TEMPORARY WORKS AREA FOR SITE FACILITIES ON GOVERNMENT FORESHORE OR SEABED (COVER OR UPON WHICH RECLAMATION UNDERTAKEN FOR THE PURPOSE OF FORMING LAND) OR OTHER WORKS MAY BE CARRIED OUT
- 擬建的行人天橋 / 扶手電梯 / 升降機 / 樓梯
PROPOSED FOOTBRIDGE/ESCALATOR/LIFT/STAIRCASE
- 擬建的有蓋行人通道
PROPOSED COVERED WALKWAY
- 擬於政府前濱或海床採用明挖回填法興建的鐵路設施或隧道
(可能在其上進行填海工程(非為形成土地)或其他工程)
PROPOSED RAILWAY FACILITIES/TUNNEL BY CUT-AND-COVER METHOD ON GOVERNMENT FORESHORE OR SEABED (COVER OR UPON WHICH TEMPORARY RECLAMATION (FOR THE PURPOSE OF FORMING TEMPORARY LAND) OR OTHER WORKS MAY BE CARRIED OUT)
- 擬於政府前濱或海床採用沉箱法興建的鐵路設施或隧道(包括保護層 / 護面層)
(可能在其上進行填海工程(非為形成土地)或其他工程)
PROPOSED RAILWAY FACILITIES/TUNNEL (INCLUDING PROTECTION LAYER/ROCK ARMOUR) BY IMMERSED TUBE METHOD ON GOVERNMENT FORESHORE OR SEABED (COVER OR UPON WHICH RECLAMATION (NOT FOR THE PURPOSE OF FORMING LAND) OR OTHER WORKS MAY BE CARRIED OUT)
- 擬建於保護結構的鐵路設施 / 隧道(地下)
PROPOSED RAILWAY FACILITIES/TUNNELS (UNDERGROUND) AT PROTECTION STRUCTURES
- 擬建於沙田至中環線及另一項正在規劃的鐵路項目(下稱「另一鐵路項目」)使用的隧道(地下) / 車站 / 車站大樓 / 車站入口 / 通風大樓 / 通風井 / 其他鐵路設施永久建築物(下稱「設施」) / 設施的布局已刊載於另一項鐵路項目方案內
PROPOSED RAILWAY TUNNEL (UNDERGROUND)/RAILWAY STATION/STATION CONCOURSE/STATION ENTRANCES/VENTILATION BUILDINGS/VENTILATION SHAFTS/OTHER RAILWAY FACILITIES OR PERMANENT STRUCTURES (HEREAFTER REFERRED TO AS "THE FACILITIES") FOR SHATIN TO CENTRAL LINK AND ANOTHER RAILWAY PROJECT UNDER PLANNING (HEREAFTER REFERRED TO AS "ANOTHER RAILWAY PROJECT"); THE LAYOUT OF THE FACILITIES IS GAZETTED UNDER ANOTHER RAILWAY PROJECT
- 受影響的政府前濱或海床的大約範圍
APPROXIMATE EXTENT OF AFFECTED GOVERNMENT FORESHORE OR SEABED

一般說明 GENERAL NOTES
1. 有關一般說明參閱圖號 SCL-G01.
FOR GENERAL NOTES, REFER TO DRAWING NO. SCL-G01.

修訂表
TABLE OF AMENDMENTS

修訂	日期	繪圖	類別	負責	說明
REV	DATE	BY	SUB	APP	DESCRIPTION

SIGNED
伍德榮 NG TAK WING
路政署
鐵路拓展處處長(1)
GOVERNMENT ENGINEER/
RAILWAY DEVELOPMENT (1)
HIGHWAYS DEPARTMENT

10 NOV 2010
發出日期 DATE OF ISSUE

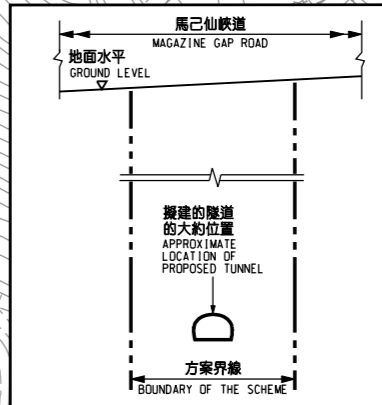

切面圖 SECTION BG
不按比例 NOT TO SCALE

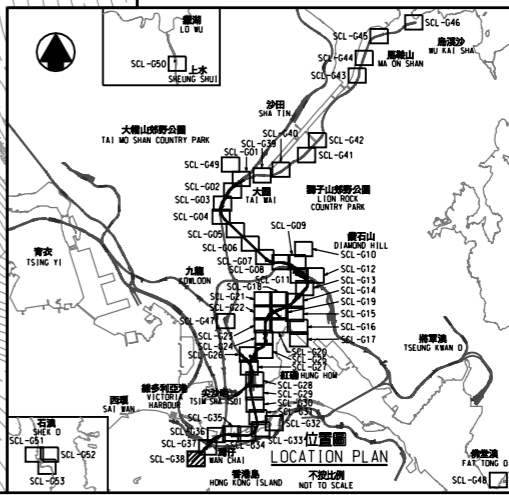

圖則名稱 DRAWING TITLE
鐵路條例(第519章)
沙田至中環線
總體規劃圖則 53頁的第38頁

RAILWAYS ORDINANCE (CHAPTER 519)
SHATIN TO CENTRAL LINK
GENERAL LAYOUT PLAN SHEET 38 OF 53

圖號 DRAWING NO. **SCL-G38** 比例 SCALE 1:1000 (A1)
或如顯示 OR AS SHOWN

香港特別行政區政府
THE GOVERNMENT OF THE HONG KONG
SPECIAL ADMINISTRATIVE REGION

路政署
HIGHWAYS DEPARTMENT

鐵路拓展處
RAILWAY DEVELOPMENT OFFICE