

**圖例 LEGEND**

- 方案界線  
BOUNDARY OF THE SCHEME
- 擬建的車站及其他鐵路設施  
PROPOSED STATION AND OTHER RAILWAY FACILITIES
- 擬建的車站及其他鐵路設施(地下)  
PROPOSED STATION AND OTHER RAILWAY FACILITIES (UNDERGROUND)
- 擬採用鑽挖或掘鑽或鑽爆的鐵路設施或隧道(地下)  
PROPOSED RAILWAY FACILITIES/TUNNEL BY BORED / MINED / DRILL AND BLAST METHOD (UNDERGROUND)
- 擬採用明挖回填法興建的鐵路設施或隧道(地下)  
PROPOSED RAILWAY FACILITIES/TUNNEL BY CUT-AND-COVER METHOD (UNDERGROUND)
- 可能永久封閉的道路(包括行車道和行人徑)  
ROADS (INCLUDING CARRIAGEWAY AND FOOTPATH) WHICH MAY BE CLOSED PERMANENTLY
- 擬建的鐵路高架橋  
PROPOSED RAILWAY VIADUCT
- 現有的行人天橋將受影響  
EXISTING FOOTBRIDGE TO BE AFFECTED
- 擬建的臨時行人天橋/地面行人過路處  
PROPOSED TEMPORARY FOOTBRIDGE / AT-GRADE PEDESTRIAN CROSSING
- 擬建的行人天橋  
PROPOSED FOOTBRIDGE
- 可能在其上進行填海工程或其他工程的政府前灘或海床  
GOVERNMENT FORE SHORE OR SEABED OVER OR UPON WHICH RECLAMATION OR OTHER WORKS MAY BE CARRIED OUT
- 現有的車站及其他鐵路設施  
EXISTING STATION AND OTHER RAILWAY FACILITIES
- 擬建的臨時架空輸送帶系統  
PROPOSED TEMPORARY OVERHEAD CONVEYANCE SYSTEM
- 擬建的鐵路隧道入口  
PROPOSED RAILWAY TUNNEL APPROACH
- 以主水平基準為依據之擬建路軌大約水平(米)  
TRACK LEVEL IN m P.D.

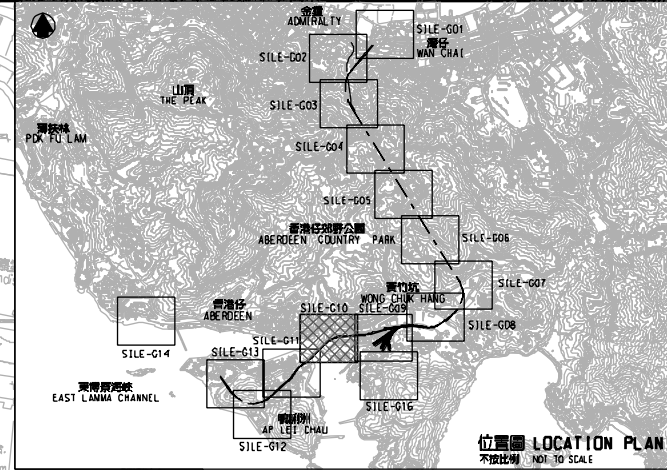
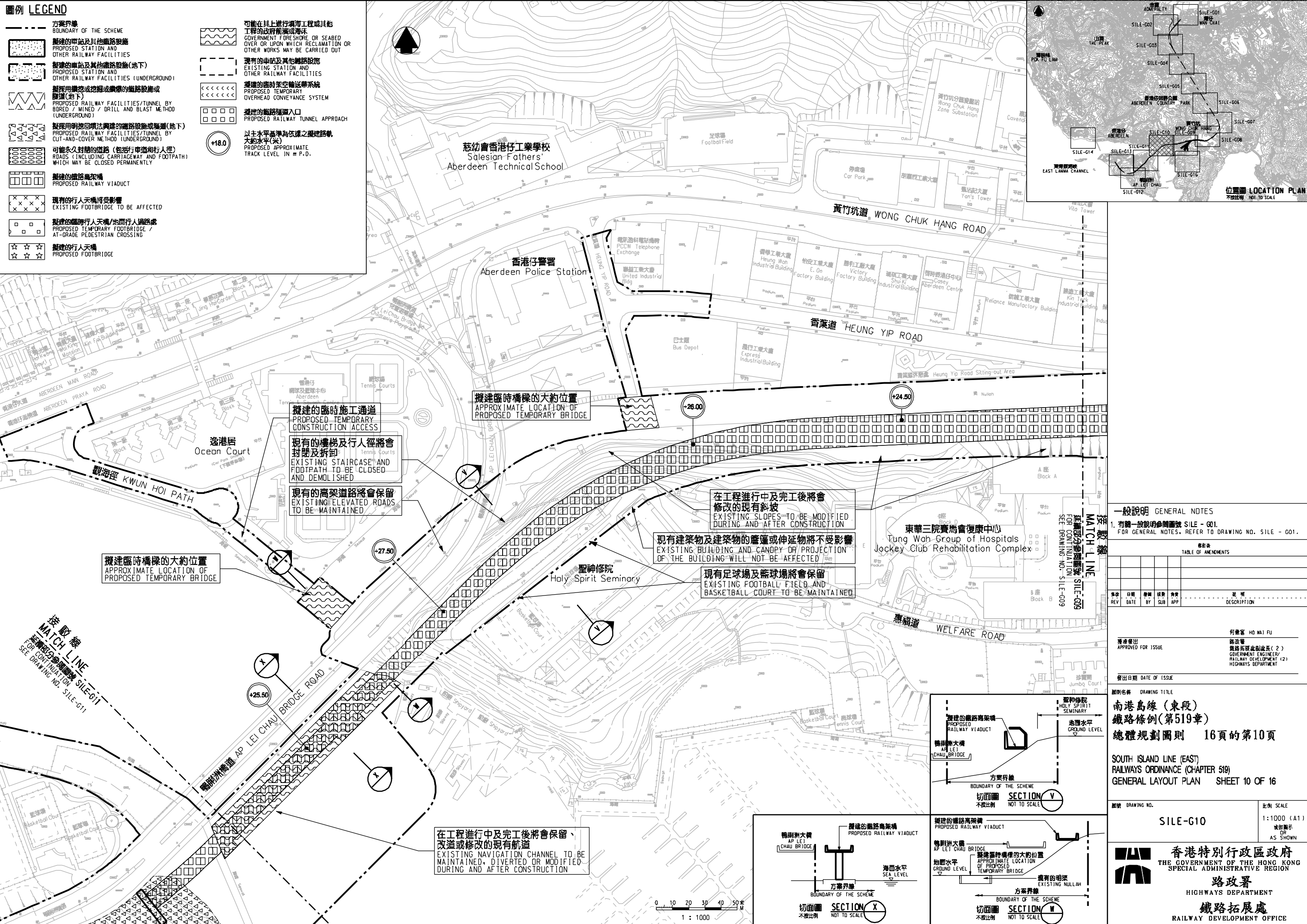

**一般說明 GENERAL NOTES**  
1. 有關一般說明參閱圖號 SILE - G01.  
FOR GENERAL NOTES, REFER TO DRAWING NO. SILE - G01.

修訂表  
TABLE OF AMENDMENTS

修訂號	日期	修訂人	核對人	用途	說明
REV	DATE	BY	SUB	APP	DESCRIPTION

行書官 HO MAI FU  
核准發出  
APPROVED FOR ISSUE  
鐵路發展處副處長(2)  
GOVERNMENT ENGINEER (2)  
RAILWAY DEVELOPMENT (2)  
HIGHWAYS DEPARTMENT

圖則名稱 DRAWING TITLE  
**南港島線(東段)  
鐵路條例(第519章)  
總體規劃圖則 16頁的第10頁**  
SOUTH ISLAND LINE (EAST)  
RAILWAYS ORDINANCE (CHAPTER 519)  
GENERAL LAYOUT PLAN SHEET 10 OF 16

圖號 DRAWING NO. **SILE-G10** 比例 SCALE 1:1000 (A1)  
或部顯示 OR AS SHOWN  
**香港特別行政區政府**  
THE GOVERNMENT OF THE HONG KONG  
SPECIAL ADMINISTRATIVE REGION  
**路政署**  
HIGHWAYS DEPARTMENT  
**鐵路拓展處**  
RAILWAY DEVELOPMENT OFFICE

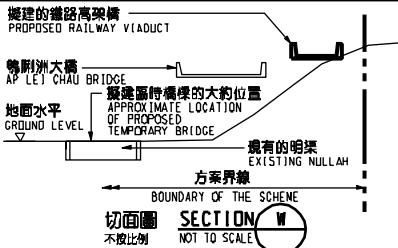
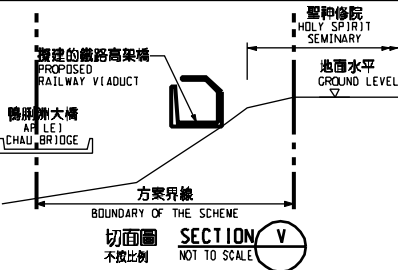
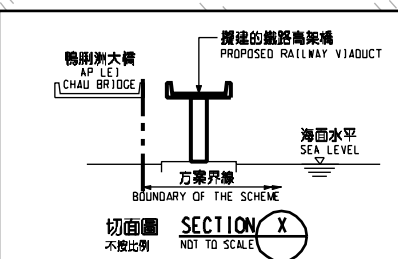
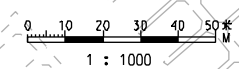

在工程進行中及完工後將會保留、  
改道或修改的現有航運  
EXISTING NAVIGATION CHANNEL TO BE  
MAINTAINED, DIVERTED OR MODIFIED  
DURING AND AFTER CONSTRUCTION

在工程進行中及完工後將會  
修改的現有斜坡  
EXISTING SLOPES TO BE MODIFIED  
DURING AND AFTER CONSTRUCTION

現有建築物及建築物的簷蓬或伸延物將不受影響  
EXISTING BUILDING AND CANOPY OR PROJECTION  
OF THE BUILDING WILL NOT BE AFFECTED

現有足球場及籃球場將會保留  
EXISTING FOOTBALL FIELD AND  
BASKETBALL COURT TO BE MAINTAINED

擬建的臨時施工通道  
PROPOSED TEMPORARY  
CONSTRUCTION ACCESS

現有的樓梯及行人徑將會  
封閉及拆卸  
EXISTING STAIRCASE AND  
FOOTPATH TO BE CLOSED  
AND DEMOLISHED

現有的高架道路將會保留  
EXISTING ELEVATED ROADS  
TO BE MAINTAINED

擬建臨時橋樑的大約位置  
APPROXIMATE LOCATION OF  
PROPOSED TEMPORARY BRIDGE

擬建臨時橋樑的大約位置  
APPROXIMATE LOCATION OF  
PROPOSED TEMPORARY BRIDGE

接駁線  
MATCH LINE  
FOR CONTINUATION SEE DRAWING NO. SILE-G11