

圖例 LEGEND

- 方案界線 BOUNDARY OF THE SCHEME
擬建的車站及其他鐵路設施 PROPOSED STATION AND OTHER RAILWAY FACILITIES
擬建的車站及其他鐵路設施(地下) PROPOSED STATION AND OTHER RAILWAY FACILITIES (UNDERGROUND)
擬採用鑽挖或掘鑽或鑽孔的鐵路設施或隧道(地下) PROPOSED RAILWAY FACILITIES/TUNNEL BY BORED / MINED / DRILL AND BLAST METHOD (UNDERGROUND)
擬採用明挖回填法興建的鐵路設施或隧道(地下) PROPOSED RAILWAY FACILITIES/TUNNEL BY CUT-AND-COVER METHOD (UNDERGROUND)
可能永久封閉的道路(包括行車道和行人徑) ROADS (INCLUDING CARRIAGEWAY AND FOOTPATH) WHICH MAY BE CLOSED PERMANENTLY
擬建的鐵路高架橋 PROPOSED RAILWAY VIADUCT
現有的行人天橋將受影響 EXISTING FOOTBRIDGE TO BE AFFECTED
擬建的臨時行人天橋/地面行人過路處 PROPOSED TEMPORARY FOOTBRIDGE / AT-GRADE PEDESTRIAN CROSSING
擬建的行人天橋 PROPOSED FOOTBRIDGE

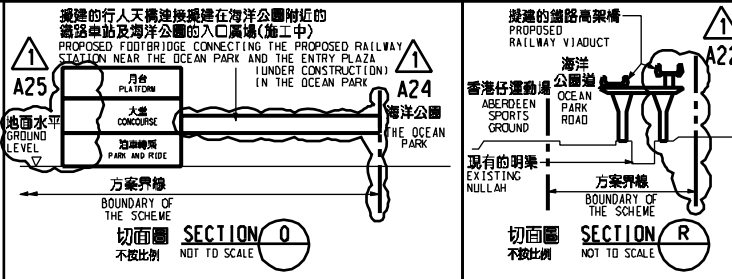

說明 NOTES

此圖根據第SILE-G08號(修改)圖則制訂,以紅色標明將永久封閉的部分位於黃竹坑道南面、黃竹坑道花園附近的休憩處;以杏色標明將暫時封閉香港仔隧道至壽山村道的部分支路路段,及分別以灰色和淺藍色標明將暫時封閉的部分海洋公園道和香葉道路段。

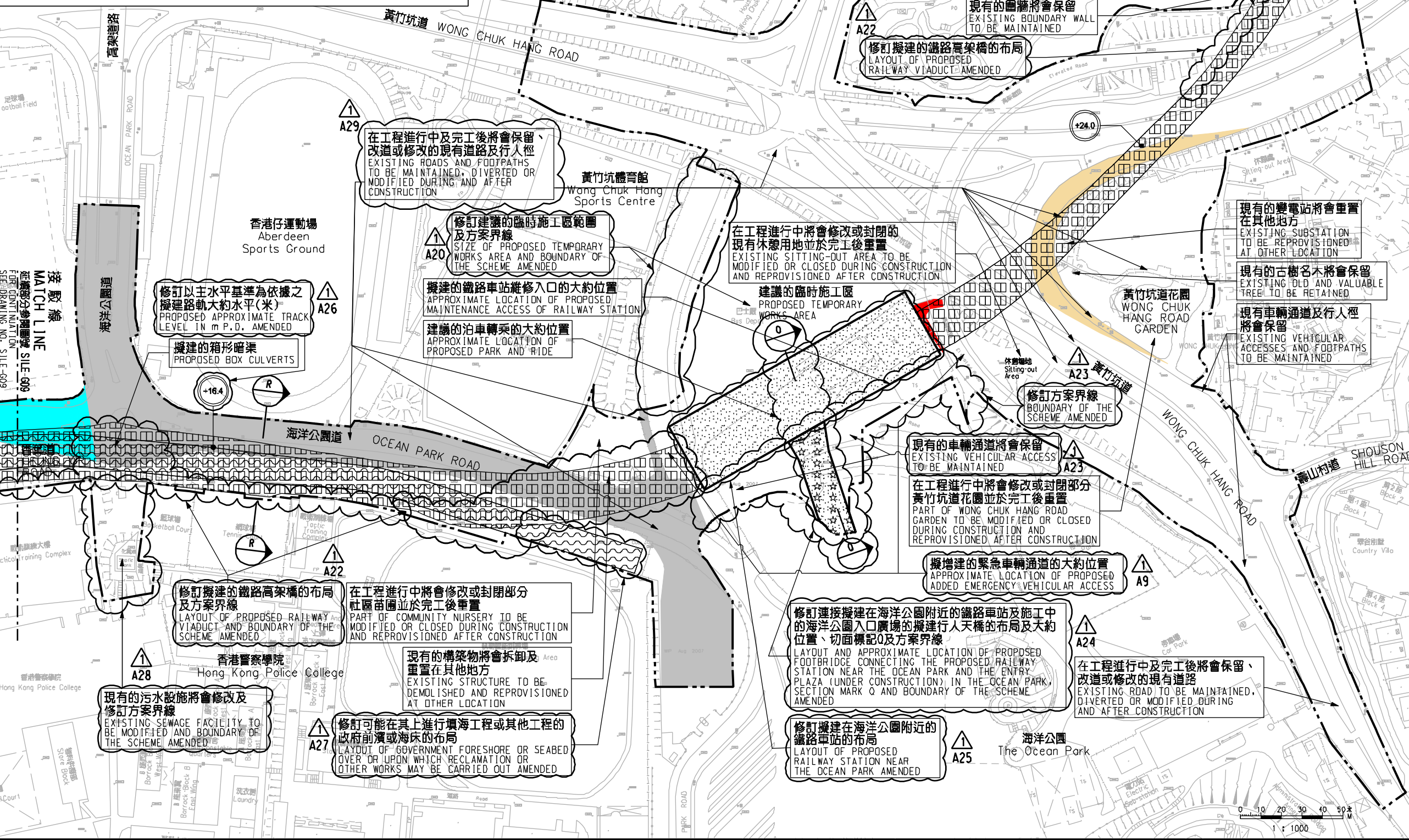

一般說明 GENERAL NOTES

1. 有關一般說明請參閱圖號 SILE - G01. FOR GENERAL NOTES, REFER TO DRAWING NO. SILE - G01.

Table with columns: REV, DATE, BY, SUB, APP, DESCRIPTION. It contains a table of amendments.

SIGNED YUEN MOU KOK, ANTHONY
15/12/2016
DATE OF ISSUE

鐵路條例(第519章)
南港島線(東段)
永久封閉部分位於黃竹坑道南面、黃竹坑道花園附近的休憩處;以及暫時封閉香港仔隧道至壽山村道的支路、海洋公園道和香葉道路段

香港特別行政區政府 THE GOVERNMENT OF THE HONG KONG SPECIAL ADMINISTRATIVE REGION
路政署 HIGHWAYS DEPARTMENT
鐵路拓展處 RAILWAY DEVELOPMENT OFFICE

Plot, Print, File names and other technical details.