

說明 NOTES

此圖根據第 SILE-G16 號 (修改) 圖則制訂, 以紅色標明將暫時封閉的部分警校道、以啡色標明將暫時封閉的部分深灣道路段, 及以黃色標明將暫時改動的南朗山道路段。

THIS DRAWING IS PREPARED BASED ON DRAWING NO. SILE-G16 (REVISION 1) AND IS INTENDED TO SHOW THE TEMPORARY PARTIAL CLOSURE OF POLICE SCHOOL ROAD (HIGHLIGHTED IN RED), THE TEMPORARY PARTIAL CLOSURE OF THE SECTION OF SHUM WAN ROAD (HIGHLIGHTED IN BROWN), AND THE TEMPORARY ALTERATION OF THE SECTION OF NAM LONG SHAN ROAD (HIGHLIGHTED IN YELLOW).

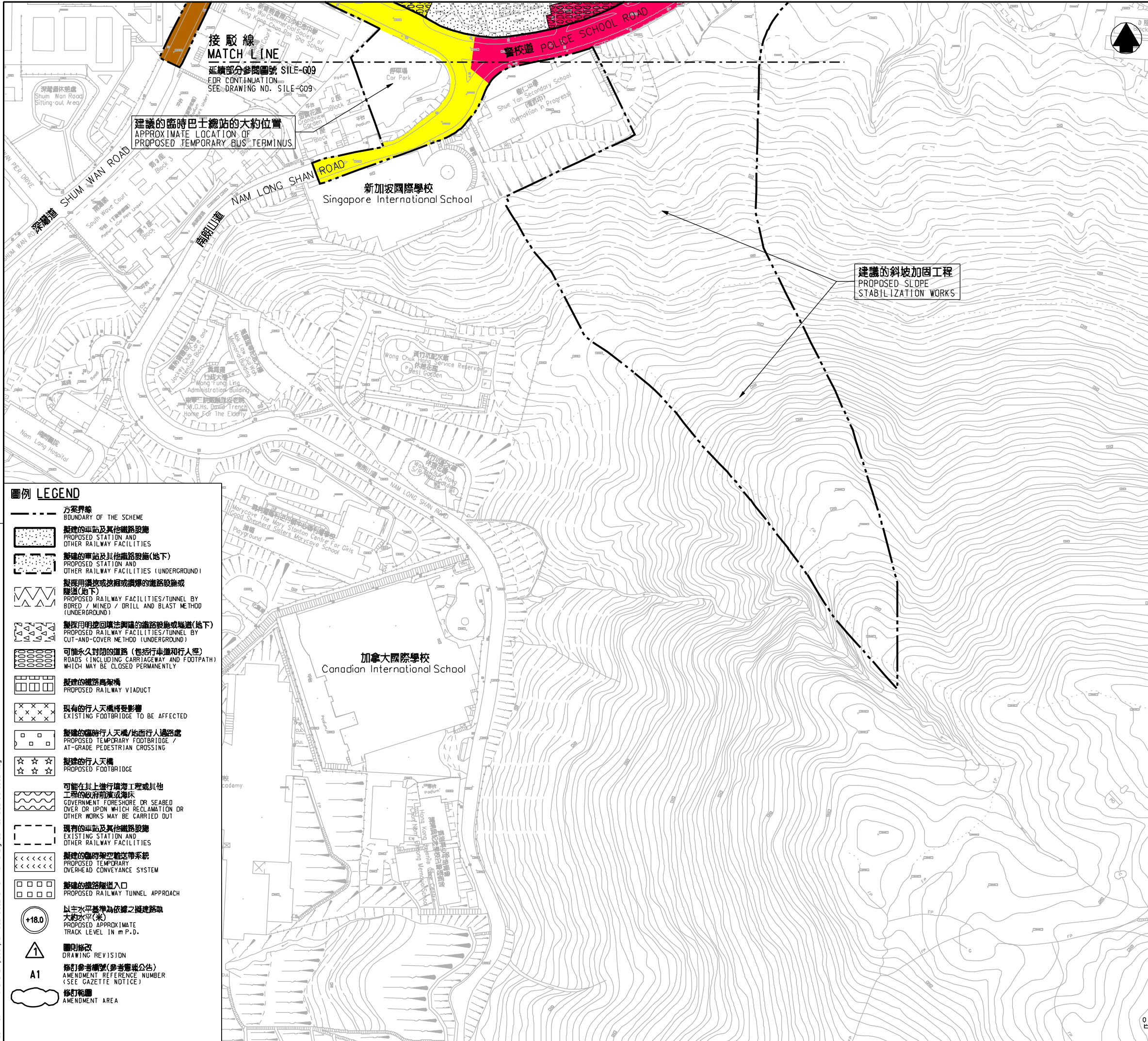

接駁線
MATCH LINE
延續部分參閱圖號 SILE-G09
FOR CONTINUATION
SEE DRAWING NO. SILE-G09

建議的臨時巴士總站的大約位置
**APPROXIMATE LOCATION OF
PROPOSED TEMPORARY BUS TERMINUS**

新加坡國際學校
Singapore International School

建議的斜坡加固工程
**PROPOSED SLOPE
STABILIZATION WORKS**

圖例 LEGEND

- 方案界線
BOUNDARY OF THE SCHEME
- 擬建的車站及其他鐵路設施
PROPOSED STATION AND OTHER RAILWAY FACILITIES
- 擬建的車站及其他鐵路設施(地下)
PROPOSED STATION AND OTHER RAILWAY FACILITIES (UNDERGROUND)
- 擬採用鑽挖或掘鑽或鑽爆的鐵路設施或隧道(地下)
PROPOSED RAILWAY FACILITIES/TUNNEL BY BORED / MINED / DRILL AND BLAST METHOD (UNDERGROUND)
- 擬採用明挖回填法興建的鐵路設施或隧道(地下)
PROPOSED RAILWAY FACILITIES/TUNNEL BY CUT-AND-COVER METHOD (UNDERGROUND)
- 可能永久封閉的道路(包括行車道和行人徑)
ROADS (INCLUDING CARRIAGEWAY AND FOOTPATH) WHICH MAY BE CLOSED PERMANENTLY
- 擬建的鐵路高架橋
PROPOSED RAILWAY VIADUCT
- 現有的行人天橋將受影響
EXISTING FOOTBRIDGE TO BE AFFECTED
- 擬建的臨時行人天橋/地面行人過路處
PROPOSED TEMPORARY FOOTBRIDGE / AT-GRADE PEDESTRIAN CROSSING
- 擬建的行人天橋
PROPOSED FOOTBRIDGE
- 可能在其上進行填海工程或其他工程的政府前灘或海床
GOVERNMENT FORE SHORE OR SEABED OVER OR UPON WHICH RECLAMATION OR OTHER WORKS MAY BE CARRIED OUT
- 現有的車站及其他鐵路設施
EXISTING STATION AND OTHER RAILWAY FACILITIES
- 擬建的臨時架空輸送帶系統
PROPOSED TEMPORARY OVERHEAD CONVEYANCE SYSTEM
- 擬建的鐵路隧道入口
PROPOSED RAILWAY TUNNEL APPROACH
- 以主水平基準為依據之擬建路線的大約水平(米)
PROPOSED APPROXIMATE TRACK LEVEL IN m P.D.
- 圖則修改
DRAWING REVISION
- 修訂參考編號(參考電報公告)
AMENDMENT REFERENCE NUMBER (SEE GAZETTE NOTICE)
- 修訂範圍
AMENDMENT AREA

一般說明 GENERAL NOTES

1. 有關一般說明參閱圖號 SILE - G01.
FOR GENERAL NOTES, REFER TO DRAWING NO. SILE - G01.

修訂表 TABLE OF AMENDMENTS

修訂號	日期	修訂	核對	備註	
REV	DATE	BY	SUB	APP	DESCRIPTION

SIGNED

核准發出
APPROVED FOR ISSUE

8/5/2015

發出日期 DATE OF ISSUE

伍德榮 NG TAK WING
总工程师/鐵路拓展
CHIEF ENGINEER/
RAILWAY DEVELOPMENT 1-1
HIGHWAYS DEPARTMENT

鐵路條例(第519章)
南港島線(東段)
暫時封閉警校道和深灣道路段; 以及暫時改動南朗山道路段

RAILWAYS ORDINANCE (CHAPTER 519)
SOUTH ISLAND LINE (EAST)
TEMPORARY CLOSURE OF POLICE SCHOOL ROAD AND A SECTION OF SHUM WAN ROAD; AND TEMPORARY ALTERATION OF A SECTION OF NAM LONG SHAN ROAD

圖號 DRAWING NO.
SILE/G16/0003/4

比例 SCALE
1:1000 (A1)
或如顯示
OR AS SHOWN

香港特別行政區政府
THE GOVERNMENT OF THE HONG KONG
SPECIAL ADMINISTRATIVE REGION

路政署
HIGHWAYS DEPARTMENT

鐵路拓展處
RAILWAY DEVELOPMENT OFFICE

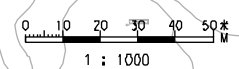

PLOT DRW: E:\lib\Plot\1818\1818.plt
 PRINTED BY: ftko 12/05/2015 11:29:42
 FILENAME: x:\ton\lan\p000\p000\road_closure\view\var_d\signed\web\sile-g16-0003-4.dgn