

**圖例 LEGEND**

- 方案界線  
BOUNDARY OF THE SCHEME
- 擬建的車站及其他鐵路設施  
PROPOSED STATION AND OTHER RAILWAY FACILITIES
- 擬建的車站及其他鐵路設施(地下)  
PROPOSED STATION AND OTHER RAILWAY FACILITIES (UNDERGROUND)
- 擬採用鑽挖或鑽爆的鐵路設施或隧道(地下)  
PROPOSED RAILWAY FACILITIES/TUNNEL BY BORED / MINED / DRILL AND BLAST METHOD (UNDERGROUND)
- 擬採用明挖回填法興建的鐵路設施或隧道(地下)  
PROPOSED RAILWAY FACILITIES/TUNNEL BY CUT-AND-COVER METHOD (UNDERGROUND)
- 可能永久封閉的道路(包括行人道和行人徑)  
ROADS (INCLUDING CARRIAGEWAY AND FOOTPATH) WHICH MAY BE CLOSED PERMANENTLY
- 擬建的鐵路高架橋  
PROPOSED RAILWAY VIADUCT
- 現有的行人天橋將受影響  
EXISTING FOOTBRIDGE TO BE AFFECTED
- 擬建的臨時行人天橋/地面行人過路處  
PROPOSED TEMPORARY FOOTBRIDGE / AT-GRADE PEDESTRIAN CROSSING
- 擬建的行人天橋  
PROPOSED FOOTBRIDGE
- 可能在其上進行填海工程或其他工程的政府前濱或海床  
GOVERNMENT FORESHORE OR SEABED OVER OR UPON WHICH RECLAMATION OR OTHER WORKS MAY BE CARRIED OUT
- 現有的車站及其他鐵路設施  
EXISTING STATION AND OTHER RAILWAY FACILITIES
- 擬建的臨時架空輸送帶系統  
PROPOSED TEMPORARY OVERHEAD CONVEYANCE SYSTEM
- 擬建的鐵路隧道入口  
PROPOSED RAILWAY TUNNEL APPROACH
- 以主水平基準為依據之擬建路軌  
大約水平(米)  
PROPOSED APPROXIMATE TRACK LEVEL IN m P.D.
- 圖則修改  
DRAWING REVISION
- 修訂參考編號(參考憲報公告)  
AMENDMENT REFERENCE NUMBER (SEE GAZETTE NOTICE)
- 修訂範圍  
AMENDMENT AREA

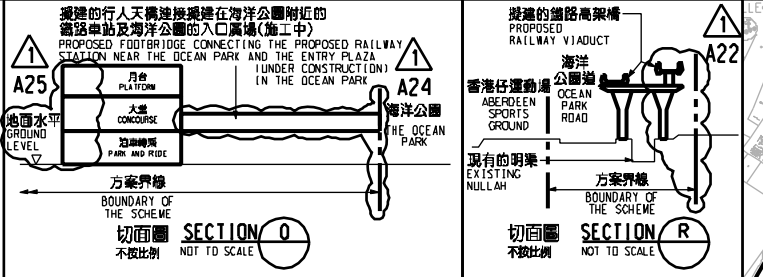

**說明 NOTES**

此圖根據第 SILE-G08 號 (修改) 圖則制訂, 以黃色標明將永久封閉香港仔隧道引道與黃竹坑道至香港仔隧道的支路交界處附近的部分行人路; 分別以紅色、粉紅色和橙色標明將永久封閉的海洋公園道、香港仔隧道引道和香葉道路段的部分行人路路面; 以深紫色標明將暫時封閉香港仔隧道引道與黃竹坑道至香港仔隧道的支路交界處附近的行人路和黃竹坑道花園北面的行人路; 分別以灰色、深綠色、深藍色、淺藍色和杏色標明將暫時封閉的部分海洋公園道、香港仔隧道引道、黃竹坑道、南風道、香葉道和香港仔隧道引道附近的支路路段, 及以啡色標明將暫時封閉位於黃竹坑道兩面、黃竹坑道花園附近的休憩處。

THIS DRAWING IS PREPARED BASED ON DRAWING NO. SILE-G08 (REVISION 1) AND IS INTENDED TO SHOW THE PERMANENT CLOSURE OF PARTS OF THE FOOTPATH NEAR THE JUNCTION OF ABERDEEN TUNNEL APPROACH ROAD AND THE SLIP ROAD FROM WONG CHUK HANG ROAD TO ABERDEEN TUNNEL (HIGHLIGHTED IN YELLOW), THE PERMANENT CLOSURE OF PARTS OF THE FOOTPATH WIDTHS OF SECTIONS OF OCEAN PARK ROAD, ABERDEEN TUNNEL APPROACH ROAD AND HEUNG YIP ROAD (HIGHLIGHTED IN RED, PINK AND ORANGE RESPECTIVELY); THE TEMPORARY CLOSURE OF THE FOOTPATH NEAR THE JUNCTION OF ABERDEEN TUNNEL APPROACH ROAD AND THE SLIP ROAD FROM WONG CHUK HANG ROAD TO ABERDEEN TUNNEL, AND THE FOOTPATH ON THE NORTHERN SIDE OF WONG CHUK HANG ROAD GARDEN (HIGHLIGHTED IN DARK PURPLE), THE TEMPORARY PARTIAL CLOSURE OF SECTIONS OF OCEAN PARK ROAD, ABERDEEN TUNNEL APPROACH ROAD, WONG CHUK HANG ROAD, NAM FUNG ROAD, HEUNG YIP ROAD AND SLIP ROADS NEAR ABERDEEN TUNNEL APPROACH ROAD (HIGHLIGHTED IN GREY, DARK GREEN, LIGHT GREEN, DARK BLUE, LIGHT BLUE AND BEIGE RESPECTIVELY), AND THE TEMPORARY CLOSURE OF THE SITTING-OUT AREA ON THE SOUTHERN SIDE OF WONG CHUK HANG ROAD NEAR WONG CHUK HANG ROAD GARDEN (HIGHLIGHTED IN BROWN).

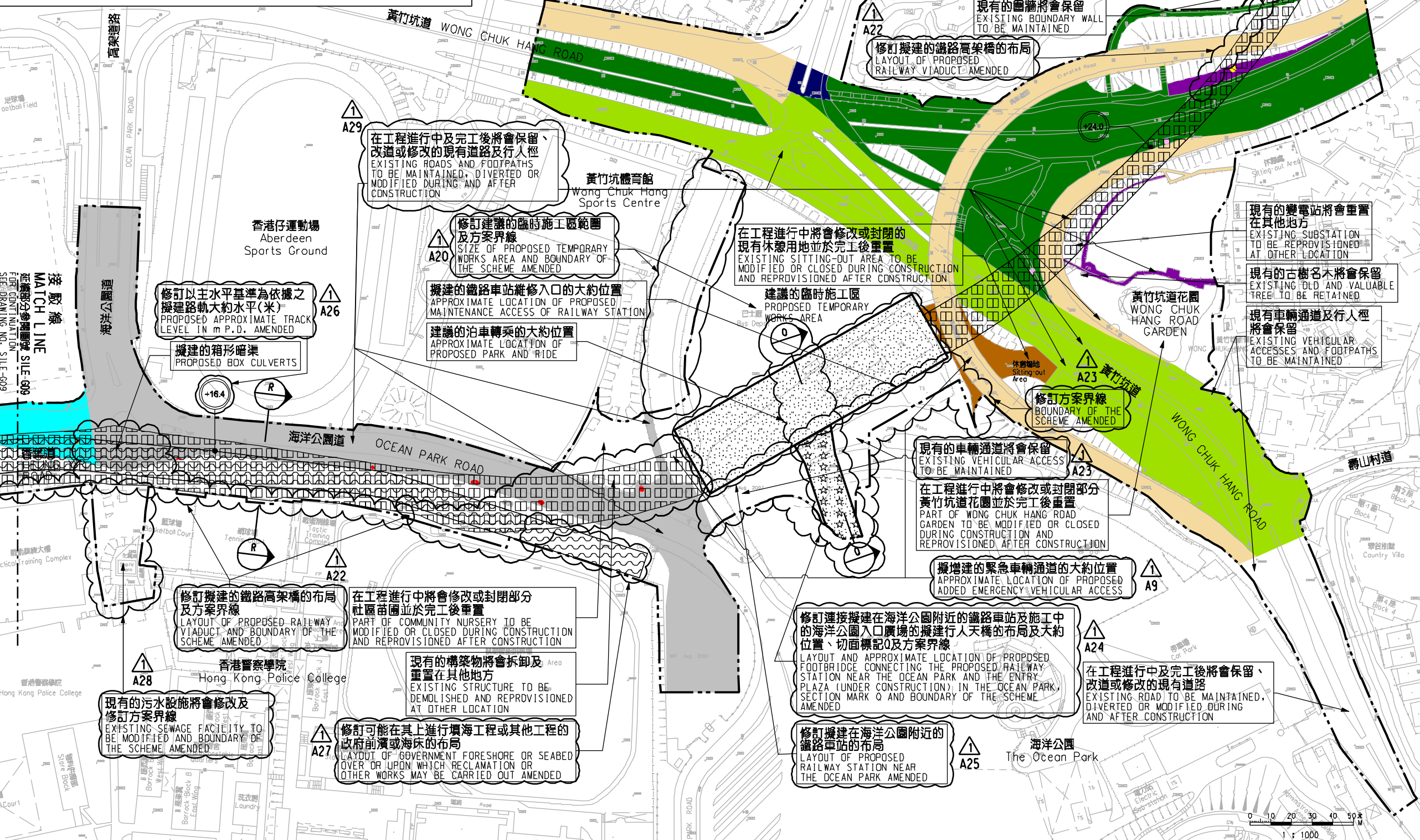

**一般說明 GENERAL NOTES**

1. 有關一般說明請參閱圖號 SILE - G01.  
FOR GENERAL NOTES, REFER TO DRAWING NO. SILE - G01.

修訂表  
TABLE OF AMENDMENTS

修訂號	日期	修訂人	修訂理由	說明	
REV	DATE	BY	SUB	APP	DESCRIPTION

**SIGNED**

核准發出  
APPROVED FOR ISSUE

13/5/2016

發出日期 DATE OF ISSUE

簽署人  
YUEN MOU KOK, ANTHONY  
总工程师 / 鐵路發展 1-1  
高級工程師  
CHIEF ENGINEER / RAILWAY DEVELOPMENT 1-1  
HIGHWAYS DEPARTMENT

圖則名稱 DRAWING TITLE  
**鐵路條例 (第519章)  
南港島綫 (東段)**

永久封閉香港仔隧道引道與黃竹坑道至香港仔隧道的支路交界處附近的部分行人路; 海洋公園道、香港仔隧道引道和香葉道路段的部分行人路面; 分別以紅色、粉紅色和橙色標明將永久封閉的海洋公園道、香港仔隧道引道和香葉道路段的部分行人路路面; 以深紫色標明將暫時封閉香港仔隧道引道與黃竹坑道至香港仔隧道的支路交界處附近的行人路和黃竹坑道花園北面的行人路; 分別以灰色、深綠色、深藍色、淺藍色和杏色標明將暫時封閉的部分海洋公園道、香港仔隧道引道、黃竹坑道、南風道、香葉道和香港仔隧道引道附近的支路路段, 及以啡色標明將暫時封閉位於黃竹坑道兩面、黃竹坑道花園附近的休憩處。

RAILWAYS ORDINANCE (CHAPTER 519)  
SOUTH ISLAND LINE (EAST)

圖號 DRAWING NO.  
**SILE/G08/0003/5**

比例 SCALE  
1:1000 (A1)  
或顯示  
OR  
AS SHOWN

**香港特別行政區政府**  
THE GOVERNMENT OF THE HONG KONG  
SPECIAL ADMINISTRATIVE REGION

**路政署**  
HIGHWAYS DEPARTMENT

**鐵路拓展處**  
RAILWAY DEVELOPMENT OFFICE

Plot: 17/05/2016  
Printed by: ftkko  
File name: x:\london\p00\p001\road\_closure\view\VER E\_SIGNED\WEB\SILE-G08-0003-5.dgn