

圖例 LEGEND

- 方案界線
BOUNDARY OF THE SCHEME
- 擬建的車站及其他鐵路設施
PROPOSED STATION AND OTHER RAILWAY FACILITIES
- 擬建的車站及其他鐵路設施(地下)
PROPOSED STATION AND OTHER RAILWAY FACILITIES (UNDERGROUND)
- 擬採用鑽挖或掘鑽或鑽爆的鐵路設施或隧道(地下)
PROPOSED RAILWAY FACILITIES/TUNNEL BY BORED / MINED / DRILL AND BLAST METHOD (UNDERGROUND)
- 擬採用明挖回填法興建的鐵路設施或隧道(地下)
PROPOSED RAILWAY FACILITIES/TUNNEL BY CUT-AND-COVER METHOD (UNDERGROUND)
- 可能永久封閉的道路(包括行車道和行人徑)
ROADS (INCLUDING CARRIAGEWAY AND FOOTPATH) WHICH MAY BE CLOSED PERMANENTLY
- 擬建的鐵路高架橋
PROPOSED RAILWAY VIADUCT
- 現有的行人天橋將受影響
EXISTING FOOTBRIDGE TO BE AFFECTED
- 擬建的臨時行人天橋/地面行人過路處
PROPOSED TEMPORARY FOOTBRIDGE / AT-GRADE PEDESTRIAN CROSSING
- 擬建的行人天橋
PROPOSED FOOTBRIDGE
- 可能在其上進行填海工程或其他工程的政府前濱或海床
GOVERNMENT FORESHORE OR SEABED OVER OR UPON WHICH RECLAMATION OR OTHER WORKS MAY BE CARRIED OUT
- 現有的車站及其他鐵路設施
EXISTING STATION AND OTHER RAILWAY FACILITIES
- 擬建的臨時架空輸送帶系統
PROPOSED TEMPORARY OVERHEAD CONVEYANCE SYSTEM
- 擬建的鐵路隧道入口
PROPOSED RAILWAY TUNNEL APPROACH
- 以主水平基準為依據之擬建路軌大約水平(米)
PROPOSED APPROXIMATE TRACK LEVEL IN m P.D.
- 圖則修改
DRAWING REVISION
- 修訂參考編號(參考憲報公告)
AMENDMENT REFERENCE NUMBER (SEE GAZETTE NOTICE)
- 修訂範圍
AMENDMENT AREA



說明 NOTES

此圖根據第SILE-G18號圖則制訂，分別以黃色、綠色和橙色標明將暫時封閉的城西道、堅彌地城、新海旁和山市街部分行車道及行人路路面的路面。

THIS DRAWING IS PREPARED BASED ON DRAWING NO. SILE-G18 AND IS INTENDED TO SHOW SECTIONS OF SHING SAI ROAD, NEW PRAYA, KENNEDY TOWN AND SANDS STREET (HIGHLIGHTED IN YELLOW, GREEN AND ORANGE RESPECTIVELY) OF WHICH PARTS OF THE CARRIAGEWAY AND FOOTPATH WIDTHS ARE TO BE TEMPORARILY CLOSED.

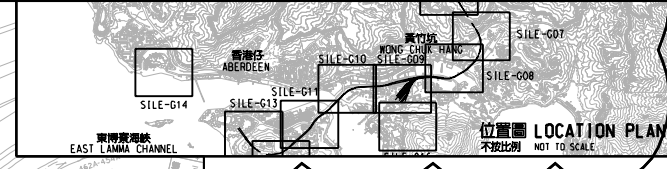

在工程進行中及完工後將會保留、改道或修改的現有道路及行人徑
EXISTING ROADS AND FOOTPATHS TO BE MAINTAINED, DIVERTED OR MODIFIED DURING AND AFTER CONSTRUCTION

為配合南港島線(東段)鐵路建造工程建議共用西港島線鐵路建造工程(施工中)下的臨時疊船起卸設施
TEMPORARY BARGE LOADING FACILITIES FOR WEST ISLAND LINE (EAST) RAILWAY WORKS CONSTRUCTION PROPOSED TO BE ALSO USED TO FACILITATE THE CONSTRUCTION OF SOUTH ISLAND LINE (EAST) RAILWAY WORKS

建議的臨時施工區
PROPOSED TEMPORARY WORKS AREA

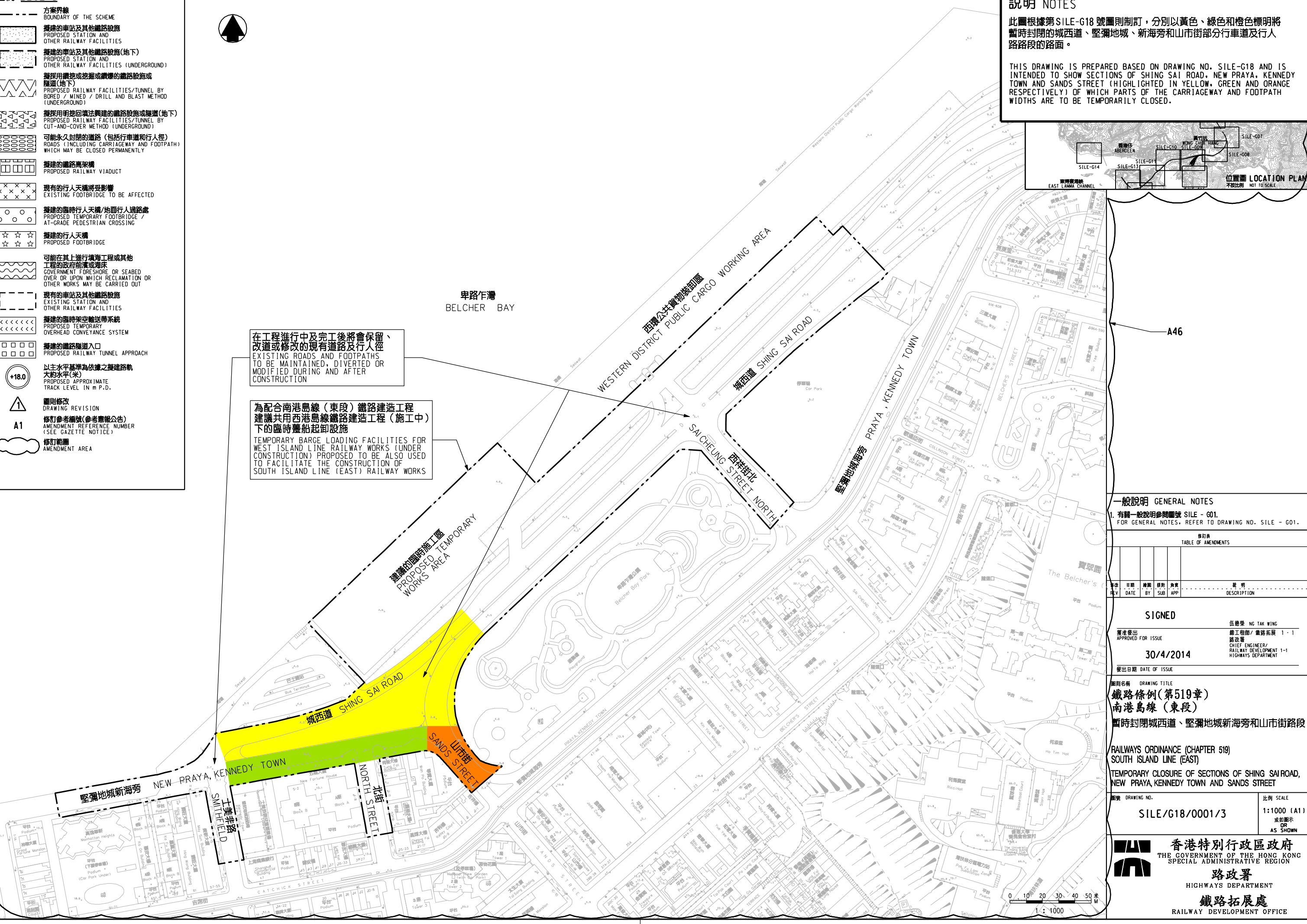

一般說明 GENERAL NOTES

1. 有關一般說明參閱圖號 SILE - G01.
FOR GENERAL NOTES, REFER TO DRAWING NO. SILE - G01.

修訂表
TABLE OF AMENDMENTS

修訂 REV	日期 DATE	繪製 BY	核對 SUB	負責 APP	說明 DESCRIPTION

SIGNED

簽署發出
APPROVED FOR ISSUE

30/4/2014

發出日期 DATE OF ISSUE

伍德榮 NG TAK WING
總工程師/鐵路拓展 1-1
CHIEF ENGINEER/
RAILWAY DEVELOPMENT 1-1
HIGHWAYS DEPARTMENT

圖則名稱 DRAWING TITLE
**鐵路條例(第519章)
南港島線(東段)
暫時封閉城西道、堅彌地城新海旁和山市街路段**

RAILWAYS ORDINANCE (CHAPTER 519)
SOUTH ISLAND LINE (EAST)
TEMPORARY CLOSURE OF SECTIONS OF SHING SAI ROAD,
NEW PRAYA, KENNEDY TOWN AND SANDS STREET

圖號 DRAWING NO.
SILE/G18/0001/3

比例 SCALE
1:1000 (A1)
或如顯示
OR AS SHOWN

香港特別行政區政府
THE GOVERNMENT OF THE HONG KONG
SPECIAL ADMINISTRATIVE REGION

路政署
HIGHWAYS DEPARTMENT

鐵路拓展處
RAILWAY DEVELOPMENT OFFICE

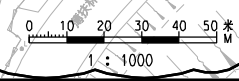

PLOT DRW: E:\lib\p101\181\181_v8.p101\p101.p101
 PRINTED BY: p101 07/05/2014 14:00:09
 FILENAME: x:\p101\181\181_v8.p101\p101.p101