

圖例 LEGEND

- 方案界線 BOUNDARY OF THE SCHEME
擬建的車站及其他鐵路設施 PROPOSED STATION AND OTHER RAILWAY FACILITIES
擬建的車站及其他鐵路設施(地下) PROPOSED STATION AND OTHER RAILWAY FACILITIES (UNDERGROUND)
擬採用鑽挖或挖掘或鑽爆的鐵路設施或隧道(地下) PROPOSED RAILWAY FACILITIES/TUNNEL BY BORED / MINED / DRILL AND BLAST METHOD (UNDERGROUND)
擬採用明挖回填法興建的鐵路設施或隧道(地下) PROPOSED RAILWAY FACILITIES/TUNNEL BY CUT-AND-COVER METHOD (UNDERGROUND)
可能永久封閉的道路(包括行車道和行人徑) WHICH MAY BE CLOSED PERMANENTLY
擬建的鐵路高架橋 PROPOSED RAILWAY VIADUCT
現有的行人天橋將受影響 EXISTING FOOTBRIDGE TO BE AFFECTED
擬建的臨時行人天橋/地面行人過路處 PROPOSED TEMPORARY FOOTBRIDGE / AT-GRADE PEDESTRIAN CROSSING
擬建的行人天橋 PROPOSED FOOTBRIDGE

說明 NOTES

此圖根據第 SILE-G02 號(修改)圖則制訂,以紫色標明將暫時封閉的香港公園部分休憩用地和行人徑,及分別以黃色、藍色、綠色、粉紅色和橙色標明將暫時封閉的樂禮街、德立街、金鐘道、法院道和正義道部分行車道及行人路路面的路面。

THIS DRAWING IS PREPARED BASED ON DRAWING NO. SILE-G02 (REVISION 1) AND IS INTENDED TO SHOW PARTS OF THE OPEN SPACE AND THE FOOTPATH IN HONG KONG PARK (HIGHLIGHTED IN PURPLE) TO BE TEMPORARILY CLOSED, AND SECTIONS OF RODNEY STREET, DRAKE STREET, QUEENSWAY, SUPREME COURT ROAD AND JUSTICE DRIVE (HIGHLIGHTED IN YELLOW, BLUE, GREEN, PINK AND ORANGE RESPECTIVELY) OF WHICH PARTS OF THE CARRIAGEWAY AND FOOTPATH WIDTHS ARE TO BE TEMPORARILY CLOSED.

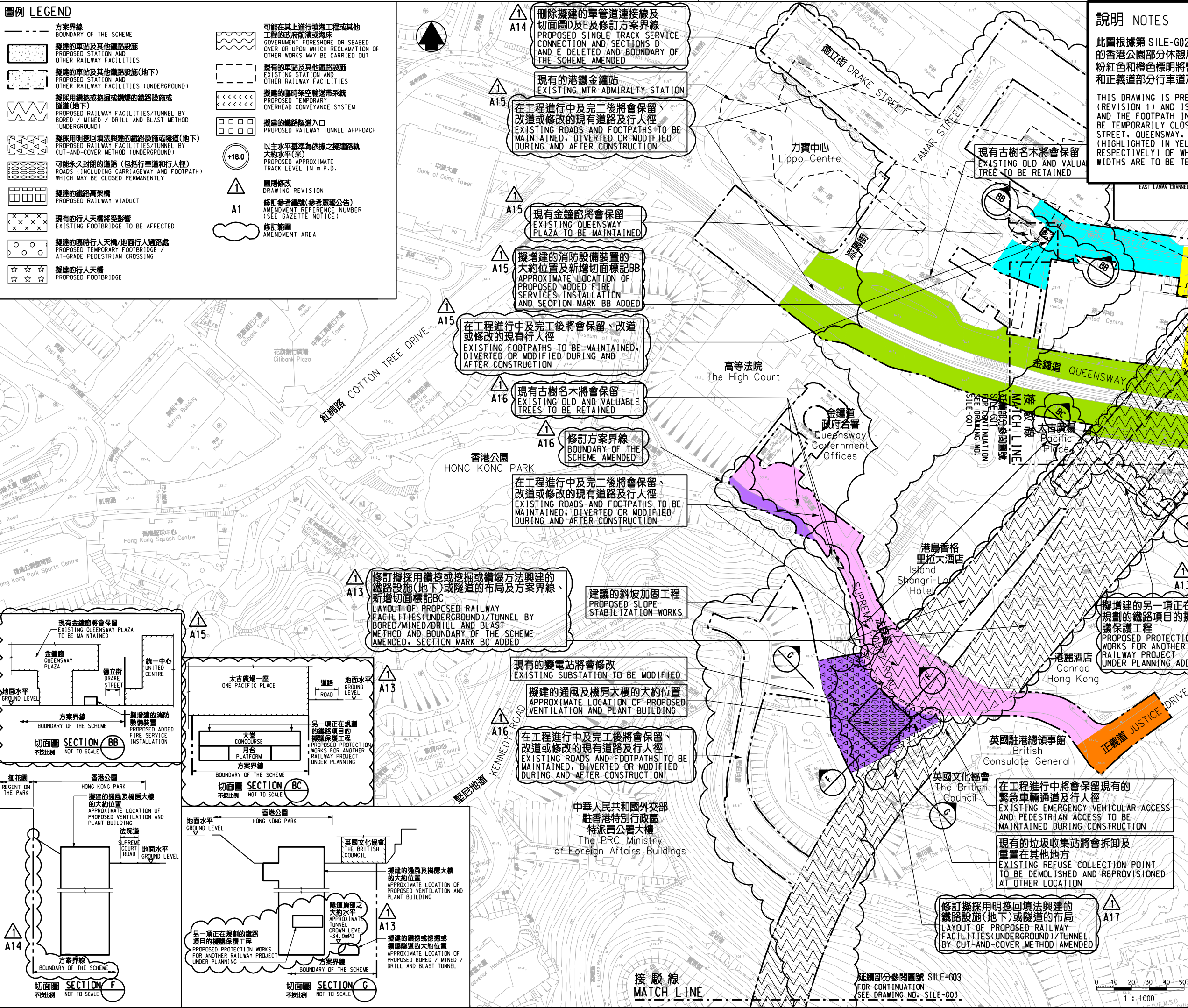

一般說明 GENERAL NOTES
1. 有關一般說明參閱圖號 SILE - G01. FOR GENERAL NOTES, REFER TO DRAWING NO. SILE - G01.

Table with 5 columns: 修改日期 REV, 日期 DATE, 繪圖人 BY, 校對人 SUB, 說明 DESCRIPTION. Includes a 'SIGNED' section with name and date.

SIGNED
30/4/2014
發日期 DATE OF ISSUE

鐵路條例(第519章)
南港島線(東段)
暫時封閉香港公園的部分休憩用地和行人徑,以及樂禮街、德立街、金鐘道、法院道和正義道路面

Header for the Railways Department, including the logo and text: 香港特別行政區政府 THE GOVERNMENT OF THE HONG KONG SPECIAL ADMINISTRATIVE REGION, 路政署 HIGHWAYS DEPARTMENT, 鐵路拓展處 RAILWAY DEVELOPMENT OFFICE.

Vertical text on the left edge: ENL: 01/05/2014, PRINTED BY: pking, FILENAME: x:\topo\shl\p000\pl\dy\road closure\rev\viewer\DESIGNED\MEB\SILE-G02-000-4.dgn