

圖例 LEGEND

Legend table with symbols for boundary of the scheme, proposed station, existing facilities, tunnel approach, track level, viaduct, affected footbridge, at-grade crossing, and proposed footbridge.

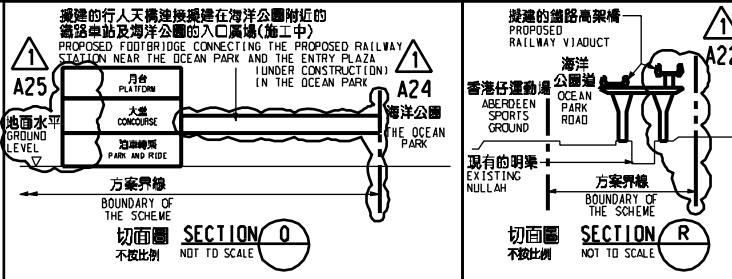

說明 NOTES: 此圖根據第 SILE-G08 號 (修改) 圖則制訂, 分別以紅色和淺藍色標明將暫時封閉的部分海洋公園道和香葉道路段。

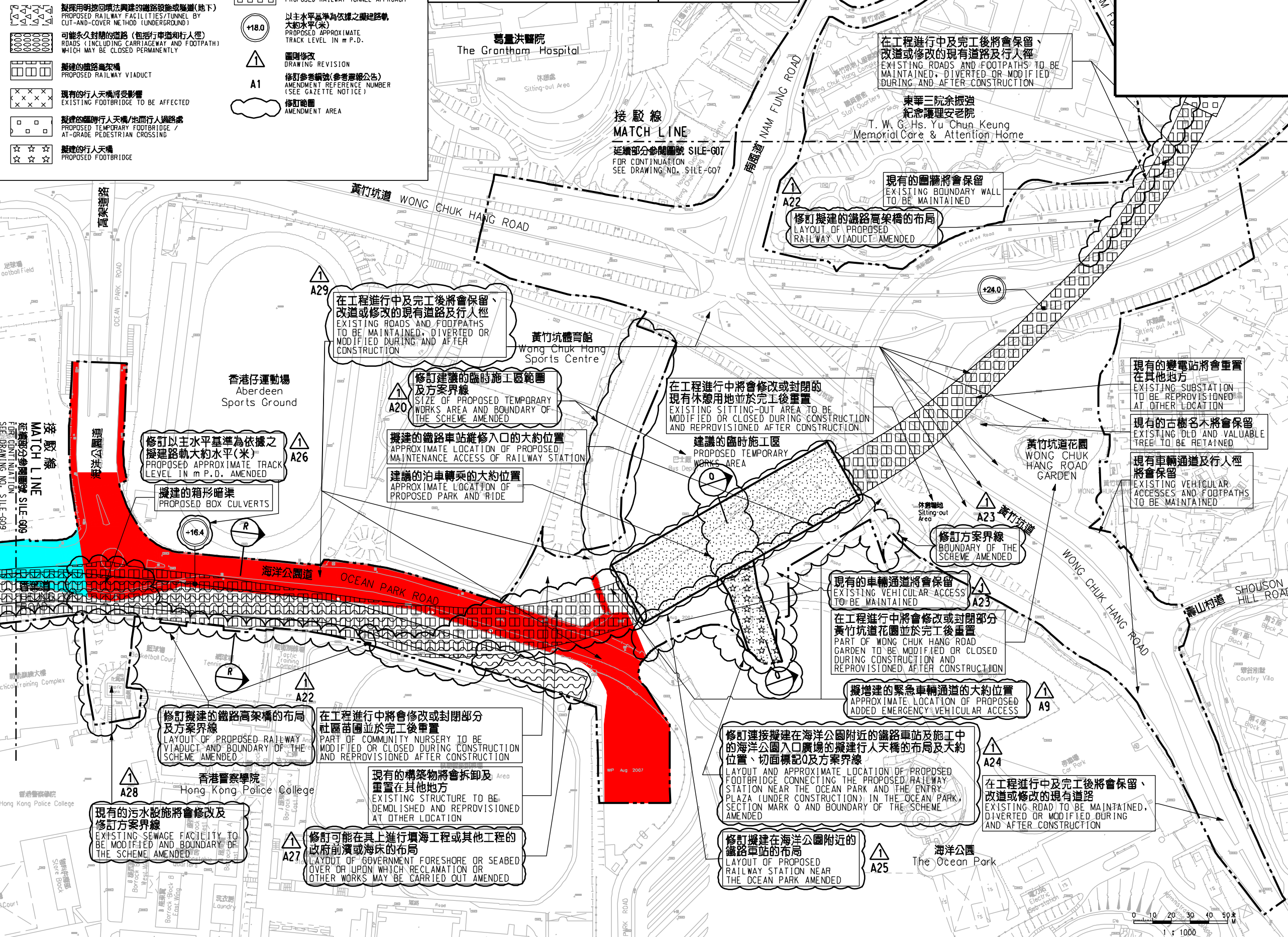

一般說明 GENERAL NOTES: 1. 有關一般說明參閱圖號 SILE - G01. FOR GENERAL NOTES, REFER TO DRAWING NO. SILE - G01.

Table of amendments with columns for revision number, date, by, and description.

SIGNED section with signature of Yuen Mo K, Anthony, Chief Engineer, Highways Department, dated 19/1/2018.

DRAWING TITLE: 鐵路條例 (第519章) 南港島綫 (東段) 暫時封閉海洋公園道和香葉道路段. RAILWAYS ORDINANCE (CHAPTER 519) SOUTH ISLAND LINE (EAST) TEMPORARY CLOSURE OF SECTIONS OF OCEAN PARK ROAD AND HEUNG YIP ROAD.

Footer containing drawing number SILE/G08/0003/8, scale 1:1000 (A1), and logos for the Government of the Hong Kong Special Administrative Region and the Railways Development Office.

Vertical text on the left margin: PLOT, PRINTED, FILENAME.