

收回地層表
UNDERGROUND STRATA RESUMPTION SCHEDULE

項目 ITEM NO.	地段編號 LOT NUMBER	全部/部分 WHOLE/ PORTION	物業名稱 NAME OF PROPERTY	地址 (紙供參考用途) ADDRESS (FOR REFERENCE PURPOSE ONLY)	參線標記 REFERENCE LINE MARK
1	九龍內地段第11095號 KOWLOON INLAND LOT NO. 11095	部分 PORTION	印度會 INDIA CLUB	九龍加士居道 24 號 NO.24 GASCOIGNE ROAD, KOWLOON	1 - 2
2	九龍內地段第11105號及其增批部分 KOWLOON INLAND LOT NO. 11105 AND THE EXTENSION THERETO	部分 PORTION	香港基督教青年會京士柏百年紀念中心 YMCA KING'S PARK CENTENARY CENTRE	九龍加士居道 22 號 NO.22 GASCOIGNE ROAD, KOWLOON	2 - 3
3	九龍內地段第11098號 KOWLOON INLAND LOT NO. 11098	部分 PORTION	西洋波會 CLUB DE RECREIO	九龍加士居道 20 號 NO.20 GASCOIGNE ROAD, KOWLOON	3 - 4
4	九龍內地段第11096號 KOWLOON INLAND LOT NO. 11096	部分 PORTION	菲律賓會 THE FILIPINO CLUB	九龍衛理道 10 號 NO.10 WYLIE ROAD, KOWLOON	5 - 6

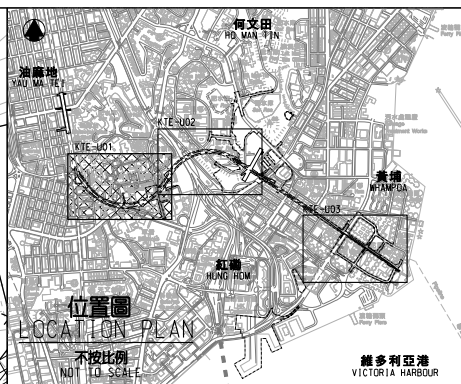
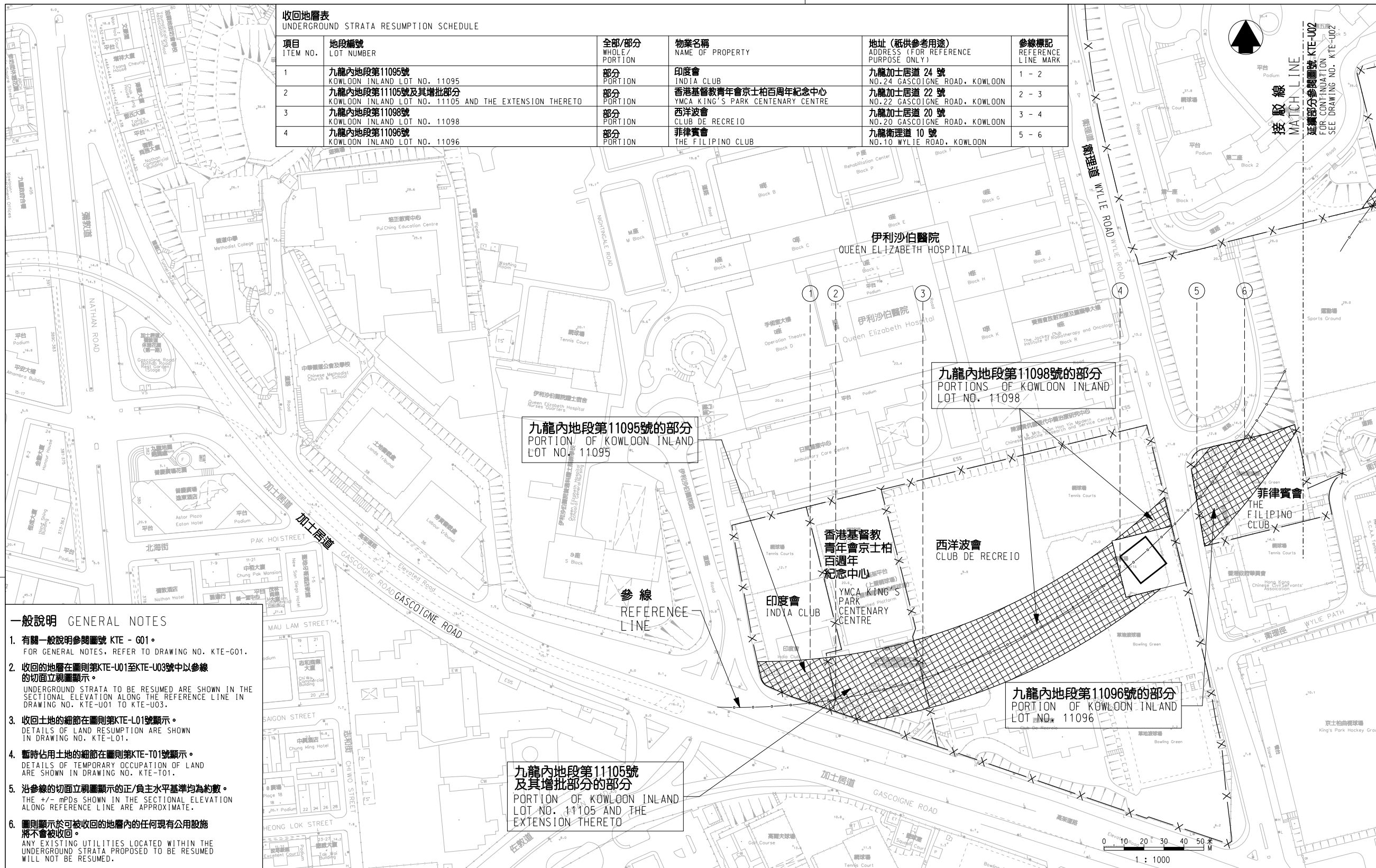

圖例 LEGEND

- 方案界線
BOUNDARY OF THE SCHEME
- 可被收回的地層
UNDERGROUND STRATA PROPOSED TO BE RESUMED
- 擬建的鐵路車站及其他鐵路設施
PROPOSED RAILWAY STATION AND OTHER RAILWAY FACILITIES
- 擬建的鐵路車站及其他鐵路設施(地下)
PROPOSED RAILWAY STATION AND OTHER RAILWAY FACILITIES (UNDERGROUND)
- 地段界線
LOT BOUNDARY
- 參線標記
REFERENCE LINE MARK
- 參線
REFERENCE LINE

一般說明 GENERAL NOTES

- 有關一般說明參閱圖號 KTE - G01。
FOR GENERAL NOTES, REFER TO DRAWING NO. KTE-G01.
- 收回的地層在圖則第KTE-U01至KTE-U03號中以參線的切面立視圖顯示。
UNDERGROUND STRATA TO BE RESUMED ARE SHOWN IN THE SECTIONAL ELEVATION ALONG THE REFERENCE LINE IN DRAWING NO. KTE-U01 TO KTE-U03.
- 收回土地的細節在圖則第KTE-L01號顯示。
DETAILS OF LAND RESUMPTION ARE SHOWN IN DRAWING NO. KTE-L01.
- 暫時佔用土地的細節在圖則第KTE-T01號顯示。
DETAILS OF TEMPORARY OCCUPATION OF LAND ARE SHOWN IN DRAWING NO. KTE-T01.
- 沿參線的切面立視圖顯示的正/負主水平基準均為約數。
THE +/- mPDs SHOWN IN THE SECTIONAL ELEVATION ALONG REFERENCE LINE ARE APPROXIMATE.
- 圖則顯示於可被收回的地層內的任何現有公用設施將不會被收回。
ANY EXISTING UTILITIES LOCATED WITHIN THE UNDERGROUND STRATA PROPOSED TO BE RESUMED WILL NOT BE RESUMED.

九龍內地段第11095號的部分
PORTION OF KOWLOON INLAND LOT NO. 11095

九龍內地段第11098號的部分
PORTIONS OF KOWLOON INLAND LOT NO. 11098

九龍內地段第11096號的部分
PORTION OF KOWLOON INLAND LOT NO. 11096

九龍內地段第11105號及其增批部分的部分
PORTION OF KOWLOON INLAND LOT NO. 11105 AND THE EXTENSION THERETO

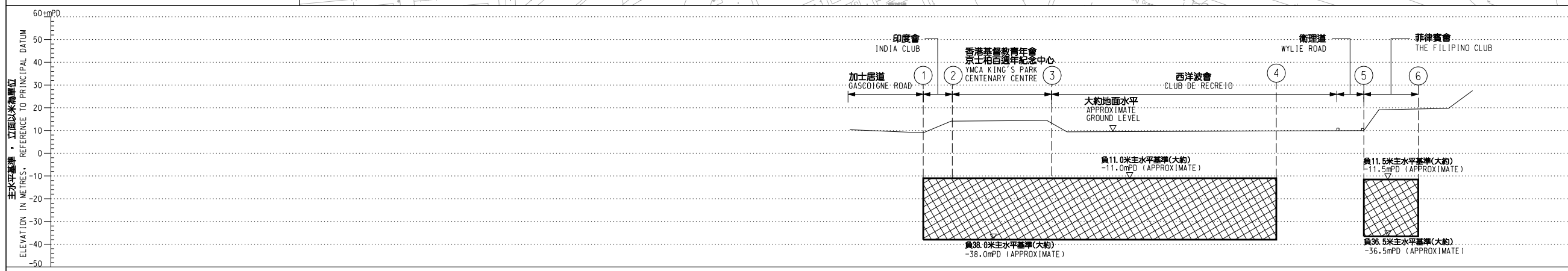

修訂表
TABLE OF AMENDMENTS

修訂 REV	日期 DATE	繪圖 BY	核對 SUB	負責 APP	說明 DESCRIPTION

SIGNED

林超雄 LAM CHIU HUNG
路政署
鐵路拓展處處長(1)
GOVERNMENT ENGINEER/
RAILWAY DEVELOPMENT (1)
HIGHWAYS DEPARTMENT

10 NOV 2009
發出日期 DATE OF ISSUE

圖則名稱 DRAWING TITLE
**鐵路條例(第519章)
- 觀塘線延線
收回地層圖則 3頁的第1頁**

RAILWAYS ORDINANCE (CHAPTER 519)
- KWUN TONG LINE EXTENSION

UNDERGROUND STRATA RESUMPTION PLAN
SHEET 1 OF 3

圖號 DRAWING NO. KTE-U01

比例 SCALE 1:1000 (A1)
或如圖示
AS SHOWN

香港特別行政區政府
THE GOVERNMENT OF THE HONG KONG
SPECIAL ADMINISTRATIVE REGION

路政署
HIGHWAYS DEPARTMENT

鐵路拓展處
RAILWAY DEVELOPMENT OFFICE

沿參線的切面立視圖 SECTIONAL ELEVATION ALONG REFERENCE LINE

