

WIL/G08/0005/4  
DRAWING NO.  
PLOT DRW: E:\B1\Plot1\B1\B1\Printer.plt  
PRINTED BY: ka/mw 06/12/2014 14:05:43  
FILENAME: F:\CIP\WIL\000\GP\road closure\rev1\DWB WIL-G08-0005-4.dgn

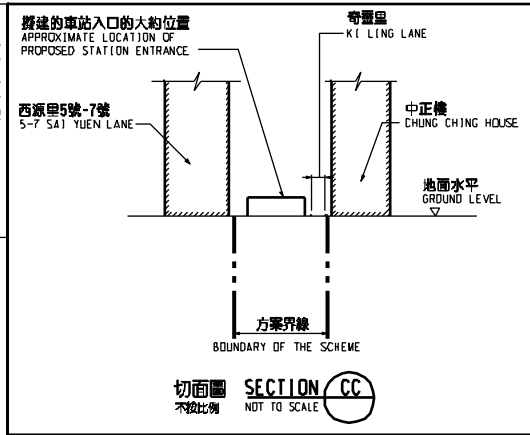

圖例 LEGEND

方案界線  
BOUNDARY OF THE SCHEME

擬建的車站入口 / 通風大樓 / 通風井 / 其他鐵路設施  
PROPOSED STATION ENTRANCES / VENTILATION BUILDINGS / VENTILATION SHAFTS / OTHER RAILWAY FACILITIES

擬建的鐵路設施(地下)  
PROPOSED RAILWAY FACILITIES (UNDERGROUND)

擬採用鑽挖或挖掘法興建的鐵路設施  
PROPOSED RAILWAY FACILITIES BY BORED / MINED METHOD

擬採用明挖回填法興建的鐵路設施  
PROPOSED RAILWAY FACILITIES BY CUT-AND-COVER METHOD

擬用作興建鐵路設施的臨時工地  
PROPOSED TEMPORARY WORKS SITES FOR CONSTRUCTION OF RAILWAY FACILITIES

可能永久封閉的道路 (包括行車道、行人徑及露天地方)  
ROADS (INCLUDING CARRIAGEWAYS, FOOTPATHS AND OPEN PLACE) WHICH MAY BE CLOSED PERMANENTLY

圖則修改  
DRAWING REVISION

修訂參考編號(參考憲報公告)  
AMENDMENT REFERENCE NUMBER (SEE GAZETTE NOTICE)

修訂範圍  
AMENDMENT AREA

說明 NOTES

此圖根據第WIL-G08號(修改 1)圖則制訂, 以黃色標明將暫時封閉的奇靈里遊樂場的休憩用地, 分別以紅色和藍色標明將暫時封閉的奇靈里和毗鄰奇靈里遊樂場的公路的部分行人路路段的路面, 分別以粉紅色和啡色標明將暫時封閉的德輔道西和皇后大道西的部分行車道及行人路路段的路面, 及分別以綠色和橙色標明將暫時改動的奇靈里及德輔道西的部分行人路路段的路面。

THIS DRAWING IS PREPARED BASED ON DRAWING NO. WIL-G08 (REVISION 1) AND IS INTENDED TO SHOW THE OPEN SPACE IN KI LING LANE PLAYGROUND (HIGHLIGHTED IN YELLOW) TO BE TEMPORARILY CLOSED, SECTIONS OF KI LING LANE AND THE ROAD ADJACENT TO KI LING LANE PLAYGROUND (HIGHLIGHTED IN RED AND BLUE RESPECTIVELY) OF WHICH PARTS OF THE FOOTPATH WIDTHS ARE TO BE TEMPORARILY CLOSED, SECTIONS OF DES VOEUX ROAD WEST AND QUEEN'S ROAD WEST (HIGHLIGHTED IN PINK AND BROWN RESPECTIVELY) OF WHICH PARTS OF THE CARRIAGEWAY AND FOOTPATH WIDTHS ARE TO BE TEMPORARILY CLOSED, AND SECTIONS OF KI LING LANE AND DES VOEUX ROAD WEST (HIGHLIGHTED IN GREEN AND ORANGE RESPECTIVELY) OF WHICH PARTS OF THE FOOTPATH WIDTHS ARE TO BE TEMPORARILY ALTERED.

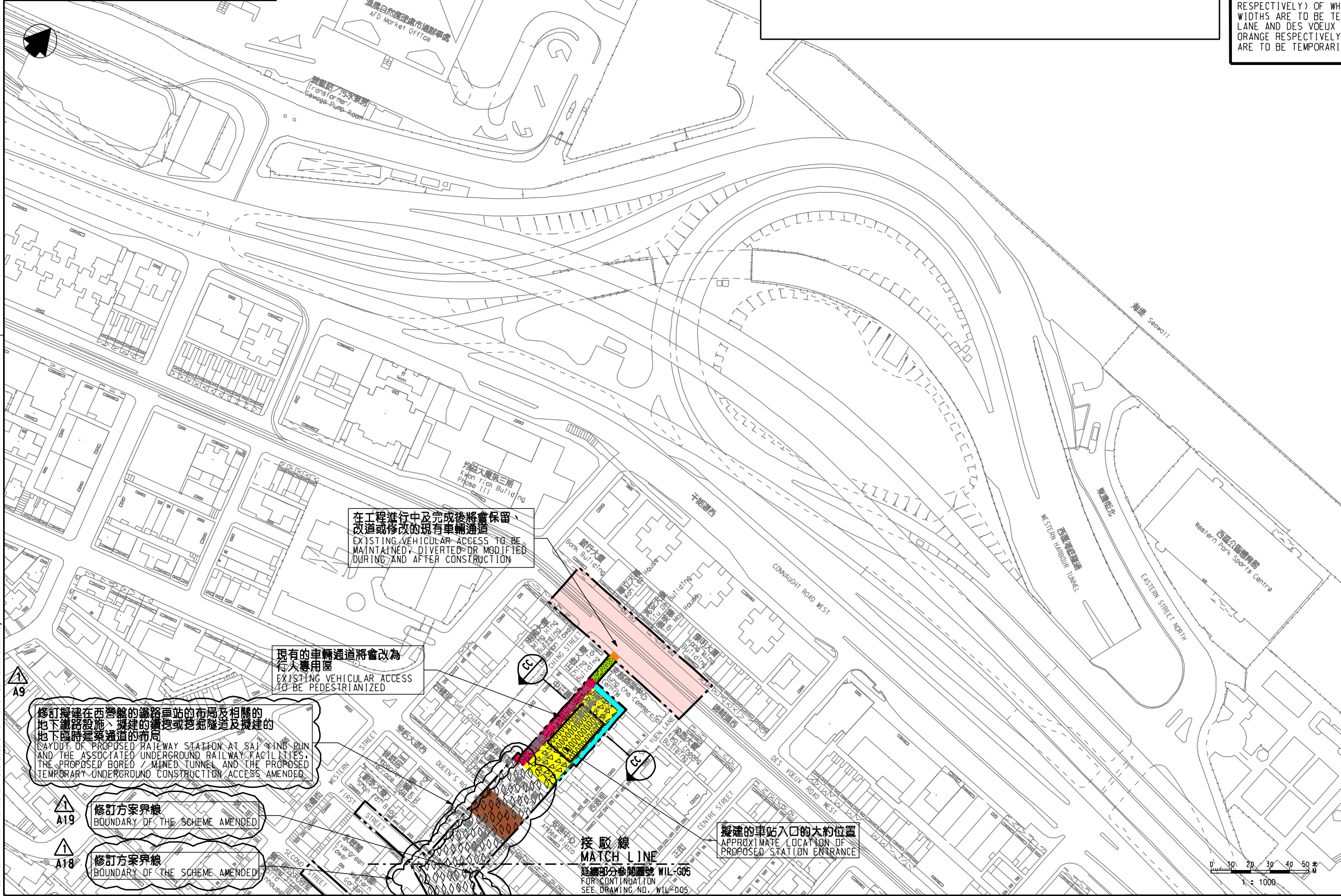

- 無論何者在圖則中顯示, 都有可能會永久或暫時封閉或大幅改動。  
ALL ROADS INCLUDING CARRIAGEWAYS, FOOTPATHS AND OPEN PLACE WITHIN THE BOUNDARY OF THE SCHEME, WHETHER OR NOT SHOWN ON THE DRAWINGS MAY BE CLOSED OR ALTERED SUBSTANTIALLY ON A PERMANENT OR TEMPORARY BASIS.
3. 除非圖則中特別註明, 否則在方案界線內, 或與方案界線毗鄰的所有建築物的汽車通道及行人通道, 包括逃生路徑, 將會保留。  
UNLESS NOTED OTHERWISE ON THE DRAWINGS, VEHICULAR AND PEDESTRIAN ACCESSES INCLUDING MEANS OF ESCAPE TO AND FROM ALL BUILDINGS WITHIN OR ADJACENT TO THE BOUNDARY OF THE SCHEME ARE TO BE MAINTAINED.
4. 所有水平均為約數, 以米為單位, 並高於香港的主水平基準。  
ALL LEVELS ARE APPROXIMATE AND IN METRES ABOVE HONG KONG PRINCIPAL DATUM (mPD).
5. 圖則顯示的建造方法分界線只是大抵位置, 有關界線可因應當時的地盤情況而作出改動。  
BOUNDARIES SHOWN ON DRAWINGS FOR THE CONSTRUCTION METHODS TO BE CARRIED OUT ARE APPROXIMATE ONLY. THESE BOUNDARIES MAY BE ALTERED ON SITE TO SUIT PREVAILING SITE CONDITIONS.

修訂表  
TABLE OF AMENDMENTS

修訂 REV	日期 DATE	修訂 BY	修訂 SUB	修訂 APP	說明 DESCRIPTION

SIGNED

批准發出  
APPROVED FOR ISSUE

5/12/2014

發出日期 DATE OF ISSUE

陸耀華 LUK YIU MAH  
陸政署  
鐵路發展處工程組(2-1)  
CHIEF ENGINEER/  
RAILWAY DEVELOPMENT (2-1)  
HIGHWAYS DEPARTMENT

圖則名稱 DRAWING TITLE

鐵路條例(第519章)  
地下鐵路(「地鐵」) - 西港島線  
RAILWAYS ORDINANCE (CHAPTER 519)  
MASS TRANSIT RAILWAY (MTR) - WEST ISLAND LINE

暫時封閉奇靈里遊樂場的休憩用地, 奇靈里、毗鄰奇靈里遊樂場的公路、德輔道西和皇后大道西路段, 及暫時改動奇靈里及德輔道西路段為車輛出入通道  
TEMPORARY CLOSURE OF THE OPEN SPACE IN KI LING LANE PLAYGROUND, SECTIONS OF KI LING LANE, THE ROAD ADJACENT TO KI LING LANE PLAYGROUND, DES VOEUX ROAD WEST AND QUEEN'S ROAD WEST, AND TEMPORARY ALTERATION OF SECTIONS OF KI LING LANE AND DES VOEUX ROAD WEST AS VEHICULAR ACCESS

圖號 DRAWING NO.

WIL/G08/0005/4

比例 SCALE  
1:1000 (A1)  
或如圖示  
OR AS SHOWN

香港特別行政區政府  
THE GOVERNMENT OF THE HONG KONG  
SPECIAL ADMINISTRATIVE REGION

路政署  
HIGHWAYS DEPARTMENT

鐵路拓展處  
RAILWAY DEVELOPMENT OFFICE