

**說明 NOTES**

此圖根據第 SCL-G37 號 (修改1) 圖則制訂, 以紫色標明將暫時封閉的部分香港公園, 及以粉紅色標明將暫時封閉的部分法院道路段。

THIS DRAWING IS PREPARED BASED ON DRAWING NO. SCL-G37 (REVISION 1) AND IS INTENDED TO SHOW THE TEMPORARY CLOSURE OF PART OF HONG KONG PARK (HIGHLIGHTED IN PURPLE), AND THE TEMPORARY PARTIAL CLOSURE OF THE SECTION OF SUPREME COURT ROAD (HIGHLIGHTED IN PINK).

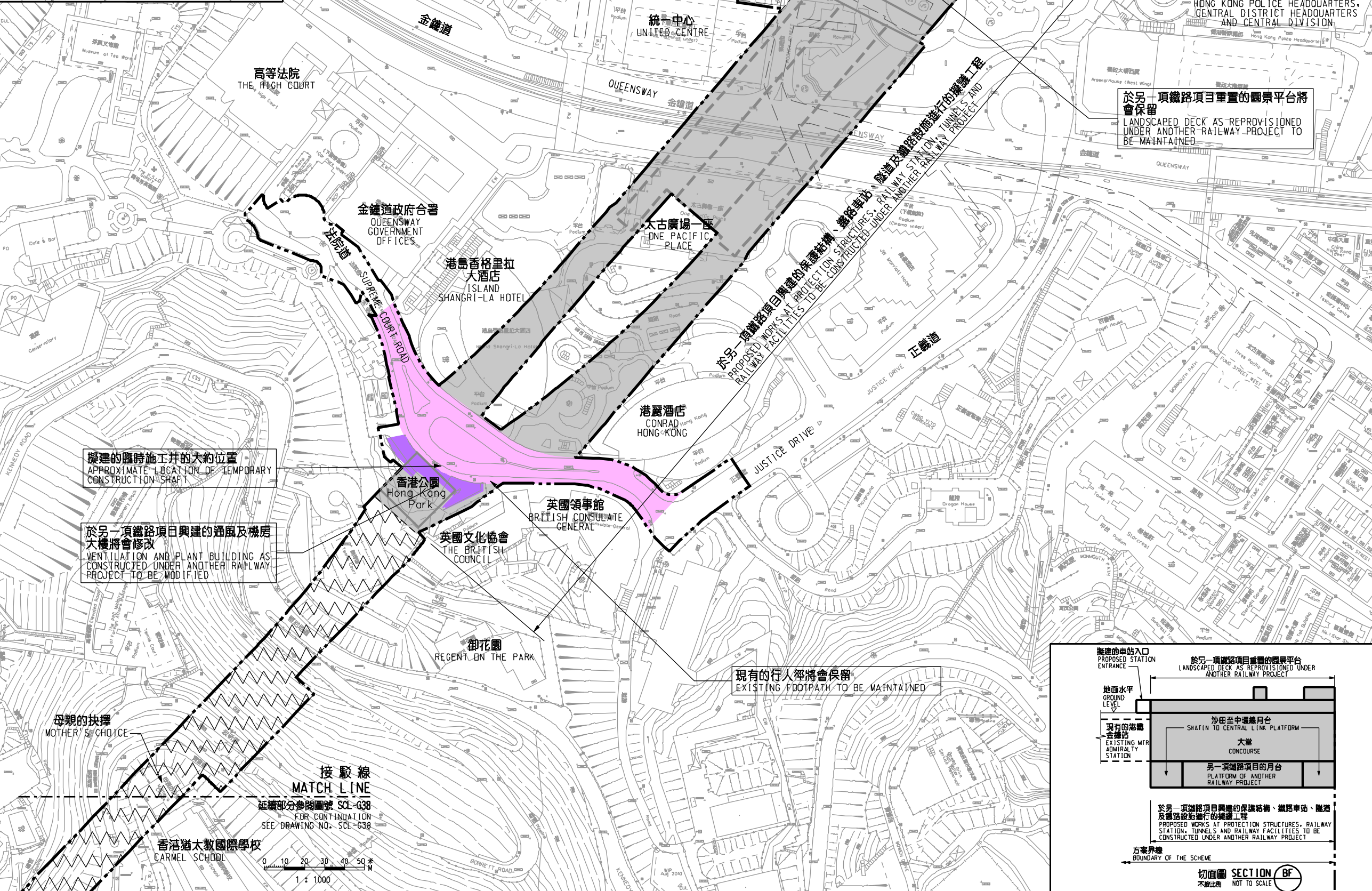
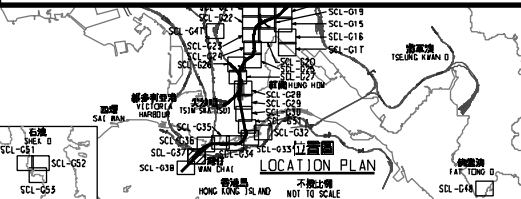

修訂擬建鐵路隧道的布局及方案界線  
LAYOUT OF PROPOSED RAILWAY TUNNEL AND BOUNDARY OF THE SCHEME AMENDED

現有的鐵路設施將會拆卸  
EXISTING RAILWAY FACILITIES TO BE DEMOLISHED

擬建車站入口的大約位置  
APPROXIMATE LOCATION OF PROPOSED STATION ENTRANCE

金鐘停車場(地下)  
ADMIRALTY CAR PARK (UNDERGROUND)

於另一項鐵路項目重置的園景平台將會保留  
LANDSCAPED DECK AS RE-PROVISIONED UNDER ANOTHER RAILWAY PROJECT TO BE MAINTAINED

擬建的臨時施工井的大約位置  
APPROXIMATE LOCATION OF TEMPORARY CONSTRUCTION SHAFT

於另一項鐵路項目興建的通風及機房大樓將會修改  
VENTILATION AND PLANT BUILDING AS CONSTRUCTED UNDER ANOTHER RAILWAY PROJECT TO BE MODIFIED

現有的行人徑將會保留  
EXISTING FOOTPATH TO BE MAINTAINED

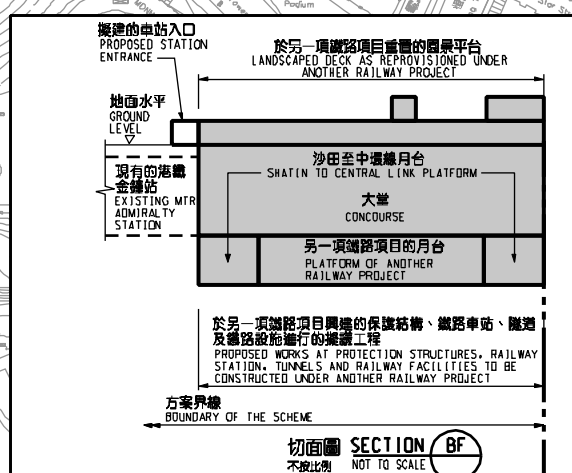

- 圖例 LEGEND**
- 方案界線 BOUNDARY OF THE SCHEME
  - 擬建的車站及其他鐵路設施(地下) PROPOSED RAILWAY STATION AND OTHER RAILWAY FACILITIES (UNDERGROUND)
  - 擬建的車站/車站入口/過風大樓/通風井/其他鐵路設施或永久建築物 PROPOSED RAILWAY STATION/STATION ENTRANCES/VENTILATION BUILDINGS/VENTILATION SHAFTS/OTHER RAILWAY FACILITIES OR PERMANENT STRUCTURES
  - 現有的車站及其他鐵路設施 EXISTING STATION AND OTHER RAILWAY FACILITIES
  - 擬採用鑽挖或掘削法興建的鐵路設施(地下) PROPOSED RAILWAY FACILITIES/TUNNEL BY BORED/WINED/DRILL AND BLAST METHOD (UNDERGROUND)
  - 擬採用明挖法興建的鐵路設施(地下) PROPOSED RAILWAY FACILITIES/TUNNEL BY CUT-AND-COVER METHOD (UNDERGROUND)
  - 可能永久封閉的道路(包括行車道、行人徑及露天地方) WHICH MAY BE CLOSED PERMANENTLY
  - 擬設置地盤的臨時施工井 PROPOSED TEMPORARY WORKS AREA FOR SITE FACILITIES
  - 擬於政府前濱或海床設置地盤的臨時施工井(可能在其上進行填海工程(非為形成土地)或其他工程) PROPOSED TEMPORARY WORKS AREA FOR SITE FACILITIES ON GOVERNMENT FORESHORE OR SEABED (OVER OR UPON WHICH RECLAMATION (NOT FOR THE PURPOSE OF FORMING LAND) OR OTHER WORKS MAY BE CARRIED OUT)
  - 擬建的行人天橋/扶手电梯/升降機/樓梯 PROPOSED FOOTBRIDGE/ESCALATOR/LIFT/STAIRCASE
  - 擬建的有蓋行人通道 PROPOSED COVERED WALKWAY
  - 擬於政府前濱或海床採用明挖法興建的鐵路設施(地下) (可能在其上進行填海工程(非為形成土地)或填海工程) PROPOSED RAILWAY FACILITIES/TUNNEL BY CUT-AND-COVER METHOD ON GOVERNMENT FORESHORE OR SEABED (OVER OR UPON WHICH RECLAMATION (NOT FOR THE PURPOSE OF FORMING LAND) OR OTHER WORKS MAY BE CARRIED OUT)
  - 擬於政府前濱或海床採用明挖法興建的鐵路設施(地下) (包括橋樑/護欄/圍欄) PROPOSED RAILWAY FACILITIES/TUNNEL BY CUT-AND-COVER METHOD ON GOVERNMENT FORESHORE OR SEABED (OVER OR UPON WHICH RECLAMATION (NOT FOR THE PURPOSE OF FORMING LAND) OR OTHER WORKS MAY BE CARRIED OUT) (INCLUDING PROTECTION LAYER/BRICK ARMOUR) BY (IMMERSED TUBE METHOD ON GOVERNMENT FORESHORE OR SEABED) OVER OR UPON WHICH RECLAMATION (NOT FOR THE PURPOSE OF FORMING LAND) OR OTHER WORKS MAY BE CARRIED OUT)
  - 擬建的保護結構的鐵路設施/隧道(地下) PROPOSED RAILWAY FACILITIES/TUNNELS (UNDERGROUND) AT PROTECTION STRUCTURES
  - 擬建於沙田中環線及另一項正在預備的鐵路項目(下稱「另一項鐵路項目」)的園景平台(包括車站/車站入口/過風大樓/通風井/其他鐵路設施或永久建築物(下稱「設施」))及園景平台(包括另一項鐵路項目) PROPOSED RAILWAY TUNNEL (UNDERGROUND)/RAILWAY STATION/STATION CONCOURSE/STATION ENTRANCES/VENTILATION BUILDINGS/VENTILATION SHAFTS/OTHER RAILWAY FACILITIES OR PERMANENT STRUCTURES (HEREAFTER REFERRED TO AS "THE FACILITIES") FOR SHATIN CENTRAL LINK AND ANOTHER RAILWAY PROJECT UNDER PLANNING (HEREAFTER REFERRED TO AS "ANOTHER RAILWAY PROJECT"). THE LAYOUT OF THE FACILITIES IS GAZETTED UNDER ANOTHER RAILWAY PROJECT.
  - 受影響的政府前濱或海床的大約範圍 APPROXIMATE EXTENT OF AFFECTED GOVERNMENT FORESHORE OR SEABED
  - 圖則修改 DRAWING REVISION
  - A1 修訂參考編號(參看憲報公告) AMENDMENT REFERENCE NUMBER (SEE GAZETTE NOTICE)
  - 修訂範圍 AMENDMENT AREA

**一般說明 GENERAL NOTES**  
1. 有關一般說明參閱圖號 SCL-G01. FOR GENERAL NOTES, REFER TO DRAWING NO. SCL-G01.

修訂表 TABLE OF AMENDMENTS

修訂號 REV	日期 DATE	修訂人 BY	修訂內容 SUB	用途 APP	說明 DESCRIPTION

**SIGNED**  
 香港發出 APPROVED FOR ISSUE  
 8/6/2016  
 發出日期 DATE OF ISSUE

圖則名稱 DRAWING TITLE  
**鐵路條例(第519章)**  
**沙田至中環線**  
 暫時封閉部分香港公園, 以及法院道路段  
 RAILWAYS ORDINANCE (CHAPTER 519)  
 SHATIN TO CENTRAL LINK  
 TEMPORARY CLOSURE OF PART OF HONG KONG PARK, AND A SECTION OF SUPREME COURT ROAD

圖號 DRAWING NO. SCL/G37/0056/1  
 比例 SCALE 1:1000 (A1)  
 或顯示 AS SHOWN

香港特別行政區政府  
 THE GOVERNMENT OF THE HONG KONG  
 SPECIAL ADMINISTRATIVE REGION  
**路政署**  
 HIGHWAYS DEPARTMENT  
**鐵路拓展處**  
 RAILWAY DEVELOPMENT OFFICE

PLOT DRW: E:\lib\Plot\1818\vb\p1818r.plt  
 PRINTED BY: ftkk 13/06/2016 11:25:06  
 FILENAME: X:\Local\SC\PA\Road\Docure\Ver\Web\SCL-G37-0056-1.dwg