

STAINLESS
STEEL HOUSING
REFER TO
HLSDML01
-CL1002

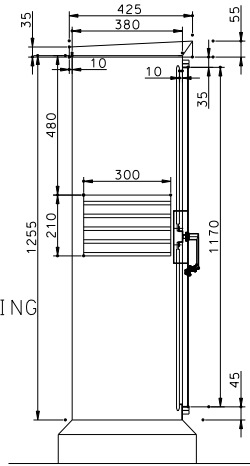

SIDE VIEW
ON ARROW A

STAINLESS
STEEL DOOR
REFER TO
HLSDML01
-CL1003

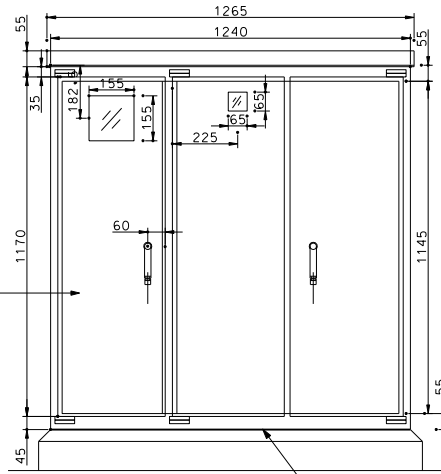

FRONT VIEW

5mm THICK 'WALKER'
CORK SHEET OR PRODUCT
WITH EQUIVALENT
FUNCTION OR PERFORMANCE

VENTILATION
LOUVRE REFER
TO HLSDML01
CL1006

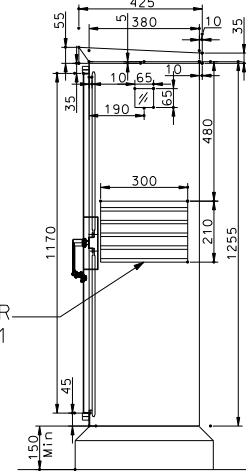

SIDE VIEW
ON ARROW B

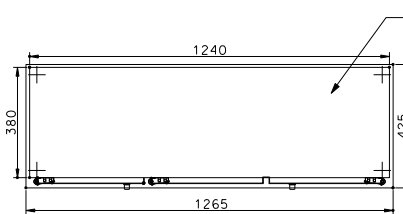

PLAN

STAINLESS STEEL COVER
REFER TO HLSDML01-CL1004

11. SEALANT SHALL BE PROPRIETARY
PRODUCTS APPROVED BY THE
ENGINEER.

FINAL ASSEMBLE

- GENERAL NOTES:
1. ALL DIMENSIONS ARE IN MILLIMETERS.
 2. THE FINISHING SHALL BE OF MATT SURFACE FINISH. FINISH NO.2B TO BS1449 PART2.
 3. A LABEL SHOWING THE EMERGENCY SERVICE TELEPHONE NUMBER SHALL BE STUCK ON THE PUBLIC LIGHTING CONTROL CUBICLE.
 4. ALL STAINLESS STEEL PLATE SHALL BE 2mm THICK GRADE 316 S16 TO BS1449:PART 2. WROUGHT STAINLESS STEEL SHALL COMPLY WITH BS970: PART 1. GRADE 316 S16.
 5. STAINLESS STEEL BOLTS AND NUTS SHALL COMPLY WITH BS6105. GRADE A4-80. STAINLESS STEEL WASHERS SHALL COMPLY WITH BS1449: PART 2 GRADE 316 S11.
 6. ALL CONJUNCTION CORNERS MUST BE WELDED.
 7. THE DOOR AND WINDOW COVER SHALL BE MADE FROM 2mm THICK STAINLESS STEEL PLATE.
 8. SERIAL NUMBER OF CUBICLE SHALL BE PRINTED ON A STAINLESS STEEL PLATE FIXED ON THE FRONT DOOR TO THE SATISFACTION OF THE ENGINEER.
 9. SCHEMATIC WIRING DIAGRAM SHOWING THE ROAD LIGHTS SUPPLIED BY THE CIRCUITS SHALL BE FIXED ON THE BACK OF THE FRONT DOOR.
 10. WORKSHOP DRAWINGS AND INSTALLATION DETAILS OF PUBLIC LIGHTING CUBICLE SHALL BE SUBMITTED FOR THE ENGINEER'S APPROVAL PRIOR TO CONSTRUCTION.

F	General revision		Aug 14
E	General revision		Feb 06
D	Details revised		Jul 04
C	General revision of notes. Former Drawing No. revised.		May 04
B	General revision of notes.		Jul 02
A	General revision of notes.		Jun 02
	Former Drg. No. LSD2000-CL0021 with general revision		Dec 01
REF.	REVISION	SIGNATURE	DATE

STANDARD GROUND MOUNTED
PUBLIC LIGHTING CONTROL CUBICLE
(SHEET 1 OF 7)

HIGHWAYS DEPARTMENT
LIGHTING DIVISION

REFERENCE	DRAWING No.	CAD
SCALE	HLSDML01-CL1001F	
N.T.S.		