

ELEVATION
(Showing plinth section)

SIDE ELEVATION

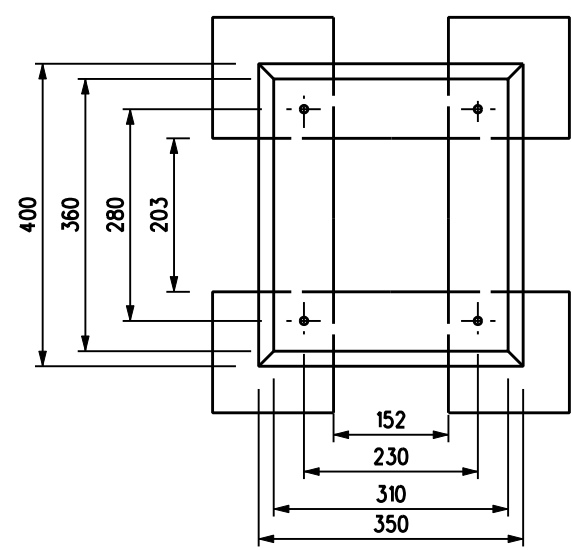

SECTION A - A

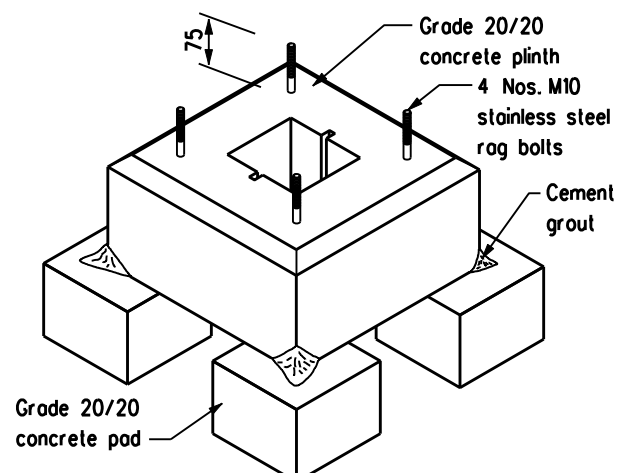

COMPLETE ASSEMBLY OF THE PLINTH

NOTES:

1. ALL DIMENSIONS ARE IN MILLIMETRES.
2. NRTB SHALL BE MANUFACTURED AND TESTED IN COMPLIANCE WITH SECTION 14 OF BS 8442 : 2006 AND BS EN 12767 : 2007 PERFORMANCE TYPE (100, NE, 4).
3. RETRO-REFLECTIVE MATERIAL SHALL BE TESTED TO COMPLY WITH RELEVANT EUROPEAN TECHNICAL APPROVAL, BS EN 12899-1 CLASS R3B-UK OR ABOVE.
4. MINIMUM PROJECTED AREA OF FLUORESCENT YELLOW CONSPICUITY PANEL:
(A) FRONT PANEL: 150,000mm²
(B) SIDE PANEL: 20,000mm²
5. COLOUR AND DETAILS OF TRAFFIC SIGN SHALL COMPLY WITH RELEVANT REQUIREMENTS OF TRANSPORT DEPARTMENT.
6. THE CONTRACTOR SHALL REFER TO THE RECOMMENDED MOUNTING METHOD OF NRTB MANUFACTURER AND SUBMIT FOR THE APPROVAL OF THE ENGINEER.
7. PLEASE REFER TO HIGHWAYS DEPARTMENT STANDARD DRAWING Nos. H2140A AND H2141A FOR THE REQUIREMENTS OF EXISTING CONCRETE PLINTH, BOLT, TEMPORARY CONCRETE COVER AND OTHER RELEVANT DETAILS.
8. FOR INSTALLATION OF NRTB, THE ABANDONED UNDERGROUND CABLES FOR ORIGINAL ILLUMINATED TRAFFIC BOLLARD SHALL BE REMOVED AS DIRECTED BY THE ENGINEER'S REPRESENTATIVE.

A	Notes revised		Mar 17
	New Issue		Jul 15
REF.	REVISION	SIGNATURE	DATE

**HIGHWAYS DEPARTMENT
LIGHTING DIVISION**

REFERENCE	DRAWING No.	CAD
SCALE N.T.S.	HLSDGE06-CL0047A	

**TYPICAL DETAILS OF
NON-ILLUMINATED RETRO-REFLECTIVE
TRAFFIC BOLLARD (NRTB)
AT EXISTING CONCRETE PLINTH**