

ELEVATION

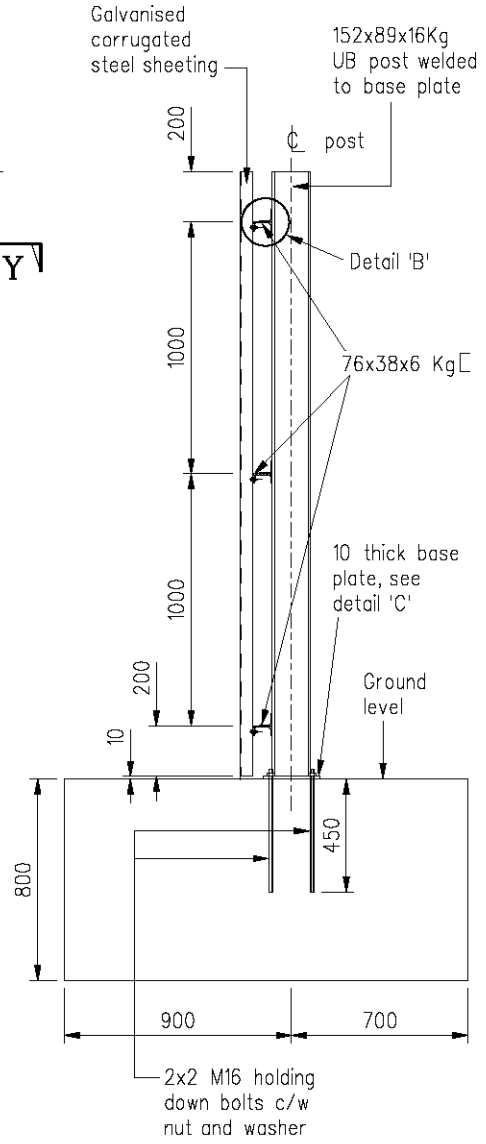

SECTION X - X

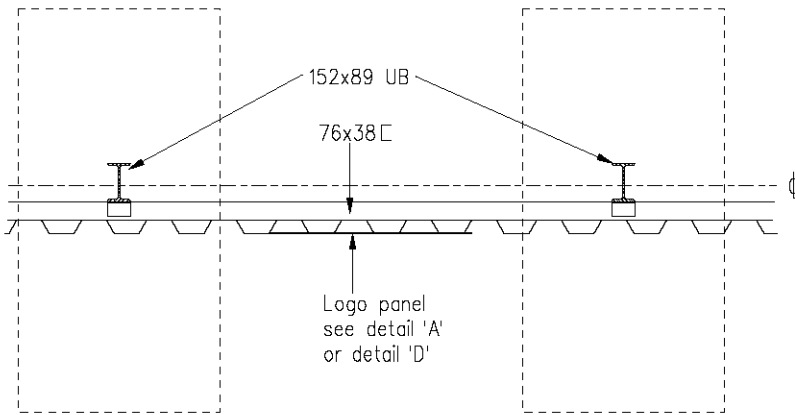

SECTION Y - Y

Notes :

1. For notes, see Drg. H6111.
2. Where the concrete footing is located in black paved footpath, the footing should be lowered to allow for the paving blocks and the sand course.
3. Logo to details 'A' and 'D' shall be displayed alternately.

C	Note 3 added, notes in section Y-Y revised and dimensions in Elevation revised for clarity		Jul 11
B	Note 2 added		Nov 99
A	Height of steel sheeting and sizes of post & footing revised		June 97
	Former Drg. No. H6007/1A		June 94
REF.	REVISION	SIGNATURE	DATE

**SITE HOARDINGS
(SHEET 1 OF 2)**

HIGHWAYS DEPARTMENT

REFERENCE

DRAWING No.

CAD

SCALE

1 : 30

H 6110C