

ELEVATIONS

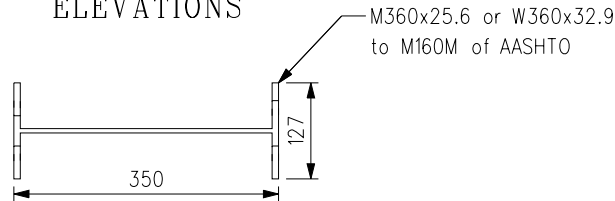

SECTION B - B

MODIFIED BLOCKOUT FOR I-POST

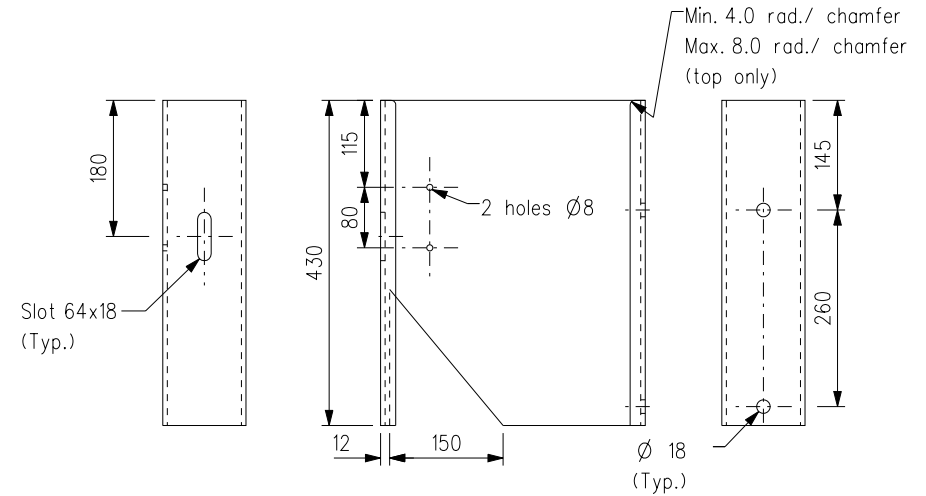

ELEVATIONS

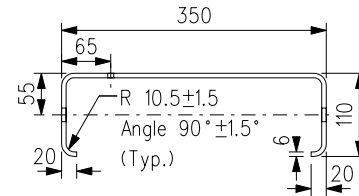

PLAN

MODIFIED BLOCKOUT FOR C-POST

Notes:

1. See drawing H2190 for notes.
2. The base metal for C-blockout shall be HU300 in accordance with AS/NZS 1594 or the equivalent approved by the Engineer.
3. The base metal for I-blockout shall be Grade 250 in accordance with AASHTO M 270M/M 270-07 or ASTM A 709/A 709M-06a or the equivalent approved by the Engineer.
4. See drawing H 2195 for capping requirements.

B	Notes 4 added		Mar 11
A	Notes 2 & 3 updated.		Nov 07
	New issue		Nov 02
REF.	REVISION	SIGNATURE	DATE

THREE-BEAM -
TYPICAL DETAILS FOR
MODIFIED BLOCKOUT

HIGHWAYS DEPARTMENT

REFERENCE	DRAWING No.	CAD
SCALE	H 2193B	
1 : 10		