

Spacing to be as instructed by the Engineer pursuant to advice from transport authority

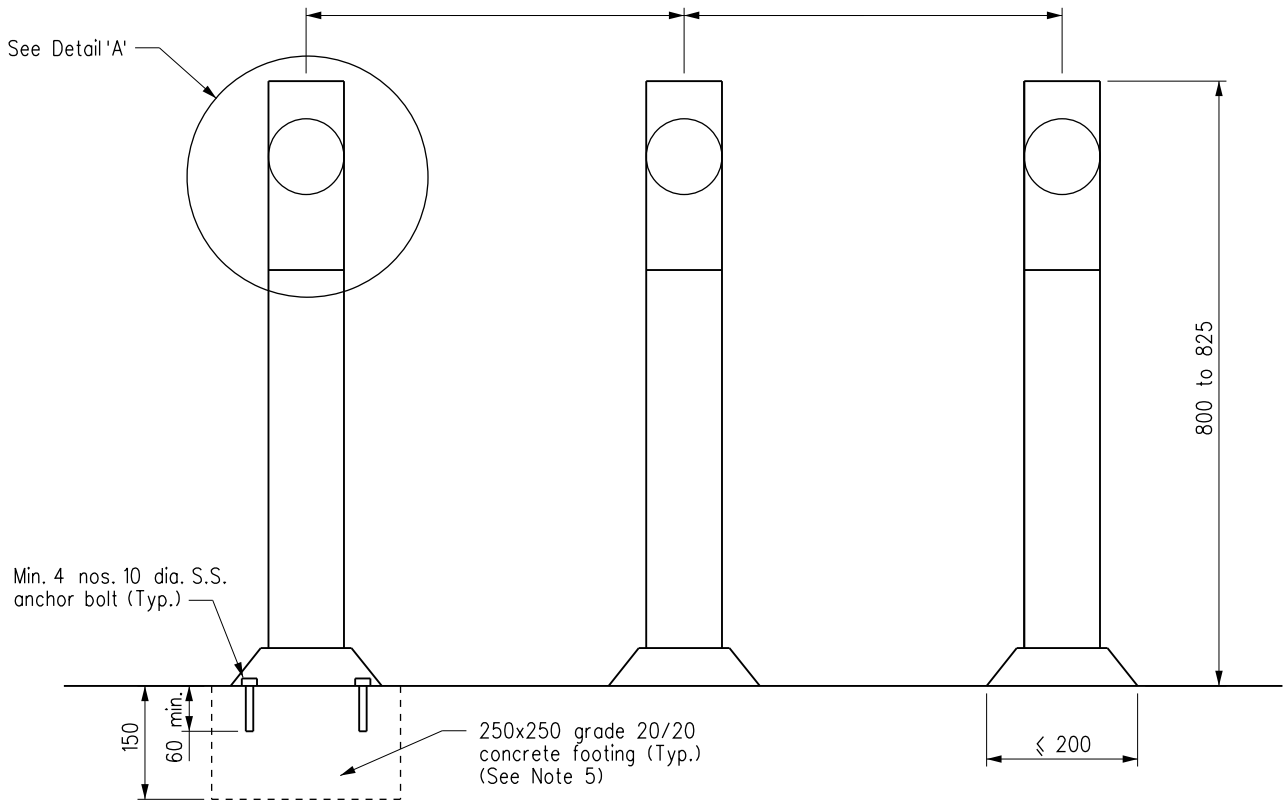

FRONT ELEVATION

Notes:

1. All dimensions are in millimeters.
2. Exact no. of marker to be erected shall be instructed by the Engineer pursuant to advice from transport authority.
3. Colour of tubular marker, including the base, shall be yellow unless otherwise instructed by the Engineer.
4. Colour, size and position of the retroreflective band may be changed subject to instruction of the Engineer.
5. The footing is not required for installation on concrete surface of min 150 thick.
6. The contractor can propose alternative bottom fixing details in accordance with manufacturer's recommendation subject to approval by the Engineer.
7. The tubular markers shall be made with ultraviolet light stabilised materials, and is durable enough to withstand the impacts of bicycles without causing significant damage to the marker itself and be flexible enough not to cause injury to the cyclists upon impacts.
8. The tubular marker can recover from direct impacts of a 2-tonne or heavier vehicle for a minimum of 200 passes without detachment of any structural components and damages impairing the integrity. Each pass shall consist of an impact of the tubular marker by the bumper, rolling over the entire base of the marker by a front wheel and then a rear wheel of the testing vehicle. The tubular marker shall be able to self-restore to an up-right position not deviating from the vertical for more than 5 degrees after each pass.
9. The Contractor shall present evidence to the satisfaction of the Engineer, or demonstrate at own expense to the Engineer by full-scale test, that the tubular marker can meet the requirements in Note 8.

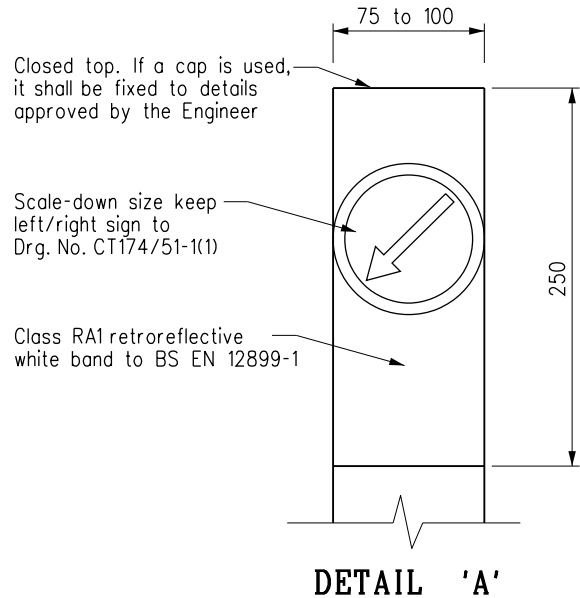

DETAIL 'A'

A	DETAIL 'A' updated	Original signed	Mar 18
	New issue	-	Aug 14
REF.	REVISION	SIGNATURE	DATE

SELF-ERECTIVE TUBULAR MARKER ON CYCLE TRACK

HIGHWAYS DEPARTMENT

REFERENCE

DRAWING No.

CAD

SCALE

Diagrammatic

H 2189/2A