

Existing construction

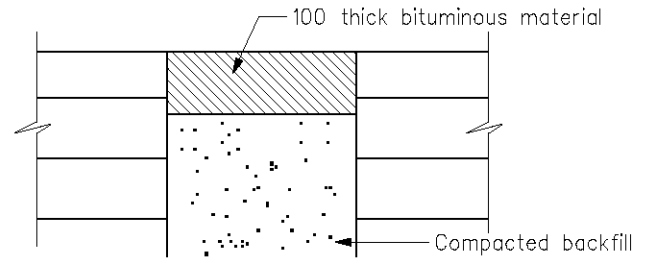

Temporary reinstatement

**BITUMINOUS CARRIAGEWAY**

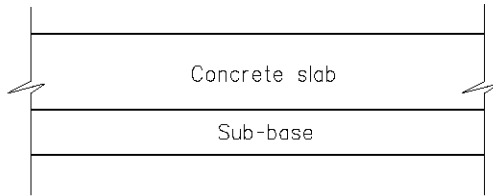

Existing construction

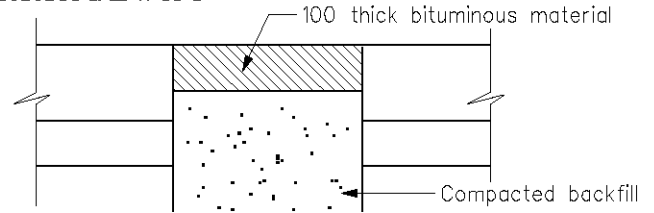

Temporary reinstatement

**CONCRETE CARRIAGEWAY**

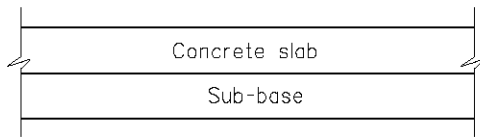

Existing construction

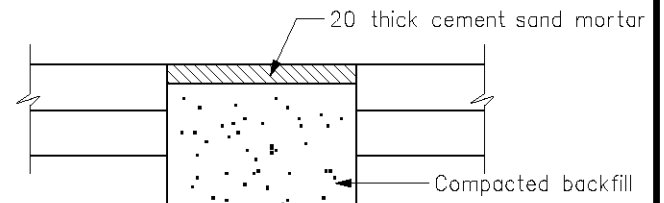

Temporary reinstatement

**CONCRETE FOOTWAY & CYCLE WAY**

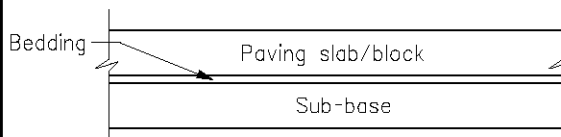

Existing construction

Paving slab/block shall be relaid in accordance with latest version of HyD Standard drawing No. H1131. Paving block shall be in same colour code as adjoining blocks, unless otherwise agreed by HyD

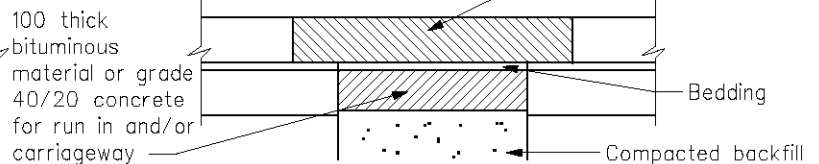

Temporary reinstatement

**PAVING SLAB/BLOCK PAVEMENT**

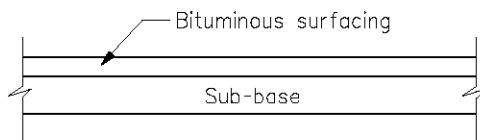

Existing construction

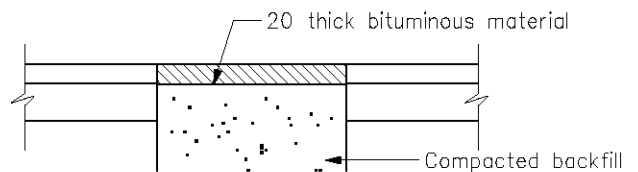

Temporary reinstatement

**BITUMINOUS FOOTWAY & CYCLE WAY**

Notes:

1. All dimensions are in millimetres.
2. No cracking, subsidence, loose debris on surface, pothole or bumpy surface should be identified on temporary reinstatement of all pavements including concrete, bituminous and paving slab/block pavements.
3. The temporary reinstatement of footway shall have same surface finishing as permanent reinstatement, unless otherwise agreed by HyD.
4. For block-paved pavement with colour patterns, the pattern of temporary reinstatement shall be agreed by HyD.
5. For carriageway with anti-skid dressing, anti-skid dressing shall be provided when the carriageway is temporarily reinstated.

D	Note 5 added		Feb 11
C	Notes 3 & 4 added and details revised		Dec 10
B	Note 2 and details revised		Apr 07
A	Note 2 revised		Oct 06
	Former Drg. No. H1018/1 with general revision		Jun 94
REF.	REVISION	SIGNATURE	DATE

**TEMPORARY REINSTATEMENT OF PAVEMENTS**

**HIGHWAYS DEPARTMENT**

REFERENCE

DRAWING No.

CAD

SCALE

Diagrammatic

**H 1123D**