

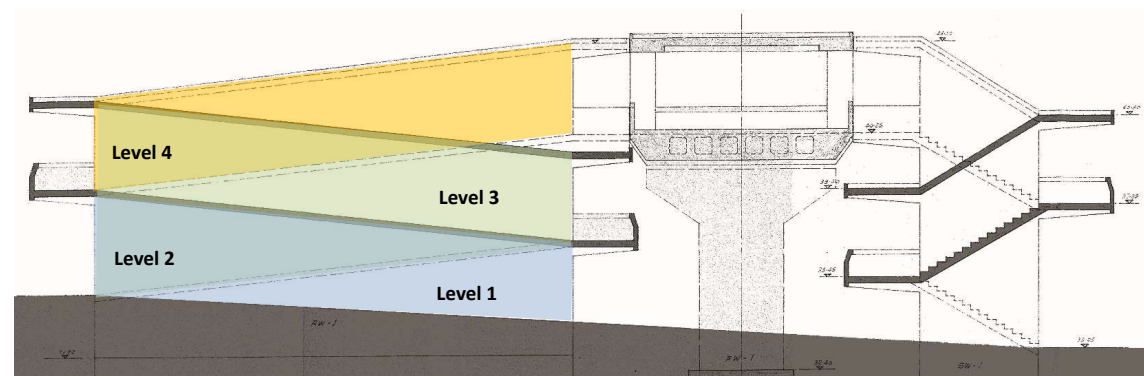

## Boundless Vistas Sau Mau Ping



Section

- The Chinese name of Sau Mau Ping was formerly called So Mau Ping, meaning a plateau full of long grasses.
- The design depicts the subtle change of the natural vistas from the woodland with dense tree canopies to an open view of grassland when walking up from the ground level to the top.



Chinese Banyan  
(*Ficus microcarpa*)

Common large evergreen tree, native to Hong Kong. Its aerial roots will become a stem when reaching soil. The tree can grow in harsh environments, and even on stone walls which become an unique landscape in urban Hong Kong.



Lance-leaved Sterculia  
(*Sterculia lanceolata*)

Common native tree species. Fruits red in colour with black seeds.

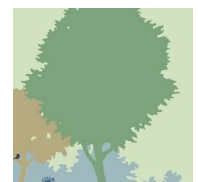

Hong Kong Gordonia  
(*Polyspora axillaris*)

Native shrub or small tree species. It is drought tolerant and wind resistant. It is suitable for woodland formation.