

索引圖 KEY PLAN 比例 - 1:40000 SCALE - 1:40000

- 註釋 NOTES :
- 除在其他方面指定外，所有量度以米為單位。
ALL DIMENSIONS ARE IN METRES UNLESS OTHERWISE STATED.
 - 所有水平均為約數，以米為單位，並在香港主水平基準上。
ALL LEVELS ARE APPROXIMATE VALUES AND IN METRES ABOVE HONG KONG PRINCIPAL DATUM.
 - 如有需要，施工區界限內部分現有行人道、行人路、中央分隔帶、安全島及美化市容地帶或將分階段暫時封閉。
SECTIONS OF THE EXISTING CARRIAGEWAYS, FOOTPATHS, CENTRAL MEDIANS/REFUGE ISLANDS AND AMENITY AREAS WITHIN THE LIMIT OF WORKS AREA MAY BE TEMPORARILY CLOSED IN PHASES AS AND WHEN REQUIRED.
 - 原有部份的道路工程載於圖則第91272/GAZ/1001至91272/GAZ/1007號。圖則第91272/GAZ/1001至91272/GAZ/1007號已按《道路(工程、使用及補償)條例》(第370章)第8(2)條的規定，分別在2020年1月3日及1月10日刊登的第43號政府公報提及。THE ROADWORKS IN ORIGINAL SCHEME IS SHOWN ON PLANS NOS. 91272/GAZ/1001 TO 91272/GAZ/1007. THE PLANS NOS. 91272/GAZ/1001 TO 91272/GAZ/1007 REFERRED TO IN G.N.43 WERE PUBLISHED UNDER SECTION 8(2) OF THE ROADS (WORKS, USE AND COMPENSATION) ORDINANCE (CHAPTER 370) RESPECTIVELY ON 3 JANUARY 2020 AND 10 JANUARY 2020.

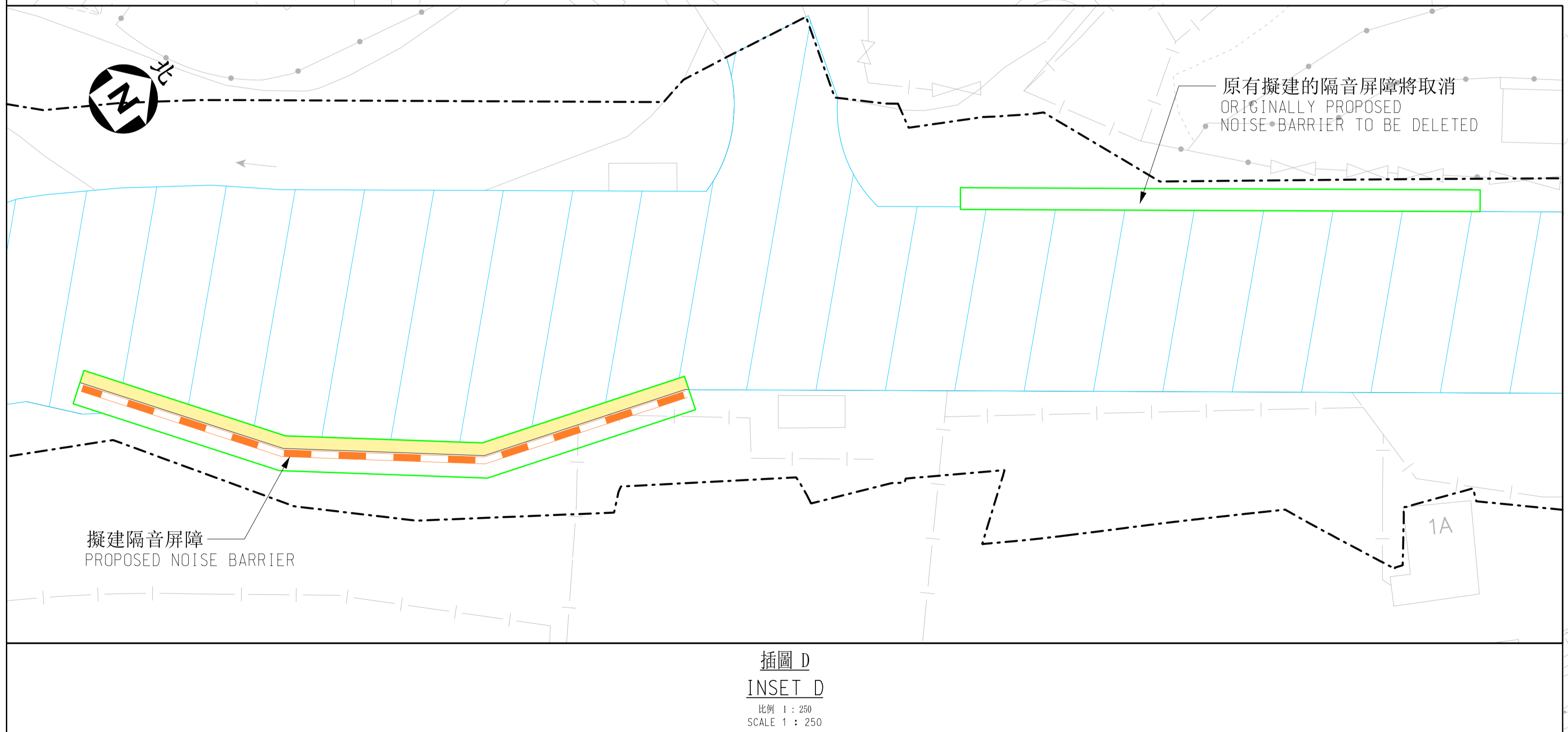
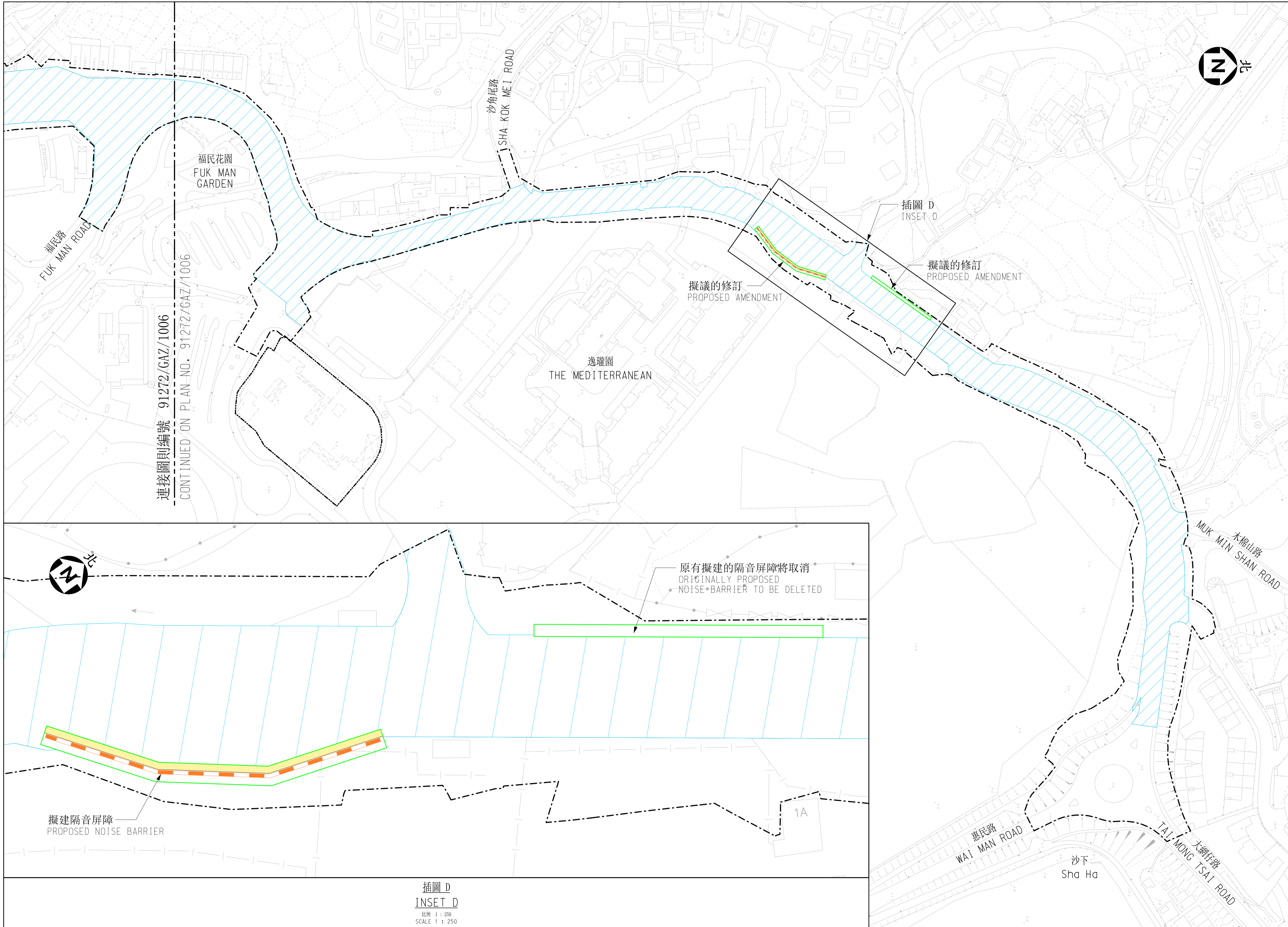

LEGEND 圖例 :

<p>--- 原有施工區界限 ORIGINAL LIMIT OF WORKS AREA</p> <p>- - - 擬議修訂的施工區界限 LIMIT OF WORKS AREA OF THE PROPOSED AMENDMENT</p> <p>--- 擬議修訂的界線 BOUNDARY OF THE PROPOSED AMENDMENT</p>	<p>■ 擬建行車道 PROPOSED CARRIAGEWAY</p> <p>■ 擬建行人路 PROPOSED FOOTPATH</p> <p>■ 擬建中央分隔帶/安全島 PROPOSED CENTRAL MEDIAN/REFUGE ISLAND</p> <p>■ 擬建美化市容地帶 PROPOSED AMENITY AREA</p>	<p>■ 擬建行人隧道 PROPOSED SUBWAY</p> <p>■ 擬建升降機 PROPOSED LIFT</p> <p>■ 現有行車道將永久封閉及拆卸 EXISTING CARRIAGEWAY TO BE PERMANENTLY CLOSED AND DEMOLISHED</p> <p>■ 現有行人路將永久封閉及拆卸 EXISTING FOOTPATH TO BE PERMANENTLY CLOSED AND DEMOLISHED</p>	<p>■ 現有中央分隔帶/安全島將永久封閉及拆卸 EXISTING CENTRAL MEDIAN/REFUGE ISLAND TO BE PERMANENTLY CLOSED AND DEMOLISHED</p> <p>■ 現有美化市容地帶將永久封閉及拆卸 EXISTING AMENITY AREA TO BE PERMANENTLY CLOSED AND DEMOLISHED</p> <p>■ 現有行車道將暫時封閉及重建 EXISTING CARRIAGEWAY TO BE TEMPORARILY CLOSED AND RECONSTRUCTED</p> <p>■ 現有行人路將暫時封閉及重建 EXISTING FOOTPATH TO BE TEMPORARILY CLOSED AND RECONSTRUCTED</p>	<p>■ 現有美化市容地帶將暫時封閉及重建 EXISTING AMENITY AREA TO BE TEMPORARILY CLOSED AND RECONSTRUCTED</p> <p>■ 擬建的斜坡改善工程 PROPOSED SLOPE IMPROVEMENT WORKS</p> <p>■ 擬建隔音屏障 PROPOSED NOISE BARRIER</p> <p>■ 擬建護土牆 PROPOSED RETAINING WALL</p>	<p>8.0 擬建水平 (約數) PROPOSED LEVEL (APPROXIMATE)</p> <p>→ 行車方向 (每一個箭頭表示一條行車線) TRAFFIC DIRECTION (ONE ARROW REPRESENTS ONE LANE)</p>
---	---	---	---	--	--

工程名稱 PROJECT TITLE
工務計劃項目第6806TH號
匡湖居至西貢市之間的西貢公路分隔車道工程
PWP ITEM NO. 6806TH
DUALLING OF HIRAM'S HIGHWAY
FROM MARINA COVE TO SAI KUNG TOWN

圖則名稱 PLAN TITLE
根據《道路(工程、使用及補償)條例》
(第370章)而在憲報公布之修訂圖則
AMENDMENT PLAN FOR
GAZETTING UNDER ROADS
(WORKS, USE AND COMPENSATION)
ORDINANCE (CHAPTER 370)

圖則編號 PLAN NO.
91272/GAZ/2106
(十二張中的第十二張)
(SHEET 12 OF 12)

版權所有 不得翻印
© Copyright Reserved
或如顯示 OR AS SHOWN

主要工程管理處
Major Works
Project Management Office

路政署
HIGHWAYS
DEPARTMENT

CAD File: \$FILES