

DRAWING NO. XRL-U11

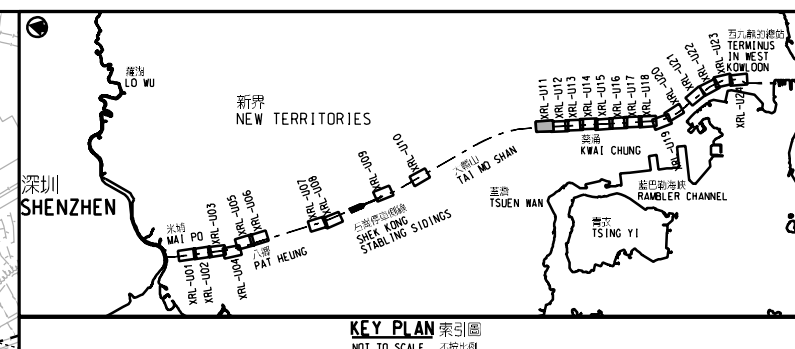
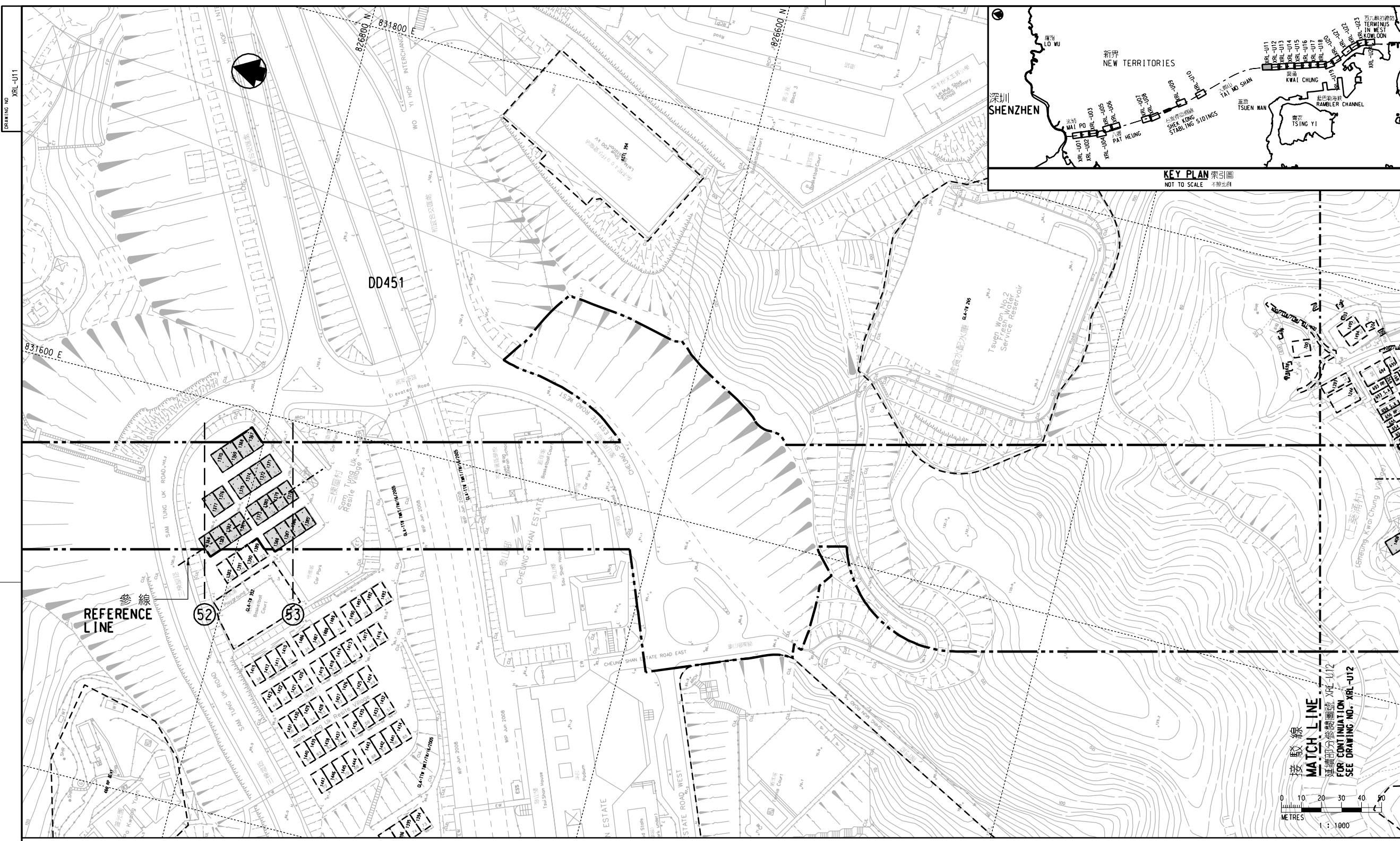

圖例 LEGEND

	建議收回的地層 UNDERGROUND STRATA PROPOSED TO BE RESUMED
	方案界線 BOUNDARY OF THE SCHEME
	參線 REFERENCE LINE
	參線標記 REFERENCE LINE MARK
	地段界線 LOT BOUNDARY
	丈量約份界線 DEMARICATION DISTRICT BOUNDARY
DD	丈量約份 DEMARICATION DISTRICT
GL	政府土地 GOVERNMENT LAND
RP	餘段 REMAINING PORTION
S.	分段 SECTION
SS.	小分段 SUB-SECTION
NKIL	新九龍內地段 NEW KOWLOON INLAND LOT
KIL	九龍內地段 KOWLOON INLAND LOT
CUL	竹園地段 CHUK UN LOT
STL	上村地段 SHEUNG TSUN LOT
TWTL	荃灣市地段 TSUEN WAN TOWN LOT
KCTL	葵涌市地段 KWAI CHUNG TOWN LOT
SD	測量約份地段 SURVEY DISTRICT
MTRL	地下鐵路地段 MASS TRANSIT RAILWAY LOT
KML	九龍海旁地段 KOWLOON MARINE LOT
(P)	部分 PORTION
*	混合用地 (農地及屋地) MIXED LAND (AGRICULTURAL LAND AND BUILDING LAND)

- 一般說明 GENERAL NOTES**
- 有關一般說明參閱圖號 XRL - G01.
FOR GENERAL NOTES, REFER TO DRAWING NO. XRL - G01.
 - 有關收回地層參閱圖號 XRL - U25 及圖號 XRL - U26.
FOR UNDERGROUND STRATA RESUMPTION SCHEDULE, REFER TO DRAWING NOS. XRL - U25 AND XRL - U26.
 - 沿參線的切面立視圖顯示的正/負土水平基準均為約數。
THE +/- MPDS SHOWN IN THE SECTIONAL ELEVATION ALONG REFERENCE LINE ARE APPROXIMATE.

修改表
TABLE OF AMENDMENTS

修改日期	日期	繪圖	核對	負責	說明
REV	DATE	BY	SUB	APP	DESCRIPTION

獲准發出
APPROVED FOR ISSUE

路政署
鐵路發展處處長(2)
GOVERNMENT ENGINEER/
RAILWAY DEVELOPMENT (2)
HIGHWAYS DEPARTMENT

發出日期 DATE OF ISSUE

圖則名稱 DRAWING TITLE
廣深港高速鐵路香港段
鐵路條例(第519章)
收回地層圖則 26頁的第11頁
HONG KONG SECTION OF
GUANGZHOU - SHENZHEN - HONG KONG
EXPRESS RAIL LINK
RAILWAYS ORDINANCE (CHAPTER 519)
UNDERGROUND STRATA RESUMPTION PLAN
SHEET 11 OF 26

圖號 DRAWING NO.
XRL - U11

比例 SCALE
1:1000 (A1)
或如顯示
AS SHOWN

香港特別行政區政府
THE GOVERNMENT OF THE HONG KONG
SPECIAL ADMINISTRATIVE REGION

路政署
HIGHWAYS DEPARTMENT

鐵路拓展處
RAILWAY DEVELOPMENT OFFICE

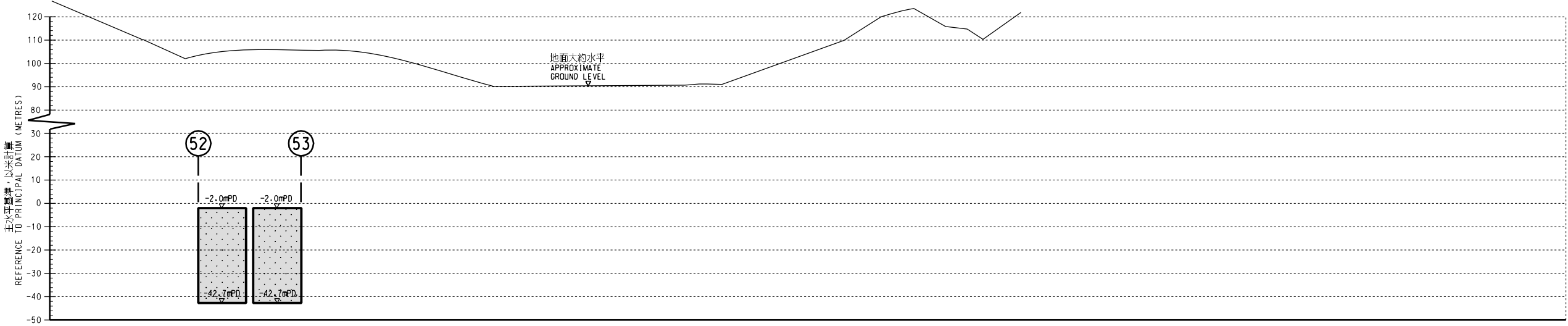

沿參線的切面立視圖 SECTIONAL ELEVATION ALONG REFERENCE LINE