

- 圖例 LEGEND
- 方案界線 BOUNDARY OF THE SCHEME
 - ▨ 擬建的車站及其他鐵路設施 PROPOSED STATION AND OTHER RAILWAY FACILITIES
 - ▨ 擬建的車站及其他鐵路設施(地下) PROPOSED STATION AND OTHER RAILWAY FACILITIES (UNDERGROUND)
 - 〰 擬建的鑽挖或掘進或鑽爆隧道 PROPOSED BORED / MINED / DRILL AND BLAST TUNNEL
 - ▨ 擬採用明挖回填法興建的鐵路設施或隧道 PROPOSED RAILWAY FACILITIES/TUNNEL BY CUT-AND-COVER METHOD
 - ▨ 擬建的地下臨時建築通道 PROPOSED TEMPORARY UNDERGROUND CONSTRUCTION ACCESS
 - 〰 可能永久封閉的道路 (包括行車道和行人徑) ROADS (INCLUDING CARRIAGEWAY AND FOOTPATH) WHICH MAY BE CLOSED PERMANENTLY
 - ▨ 擬建的緊急車輛通道及行車道 PROPOSED EMERGENCY VEHICULAR ACCESS AND CARRIAGEWAY
 - ▨ 擬建的行人徑 PROPOSED FOOTPATH
 - ⊗ 現有的行人天橋將受影響 EXISTING FOOTBRIDGE TO BE AFFECTED
 - 擬建的臨時行人天橋/地面行人過路處 PROPOSED TEMPORARY FOOTBRIDGE / AT-GRADE PEDESTRIAN CROSSING
 - ☆☆☆ 擬建的行人天橋 PROPOSED FOOTBRIDGE
 - 〰 可能在其上進行填海工程或其他工程的政府前濱或海岸 GOVERNMENT FORESHORE OR SEABED OVER OR UPON WHICH RECLAMATION OR OTHER WORKS MAY BE CARRIED OUT

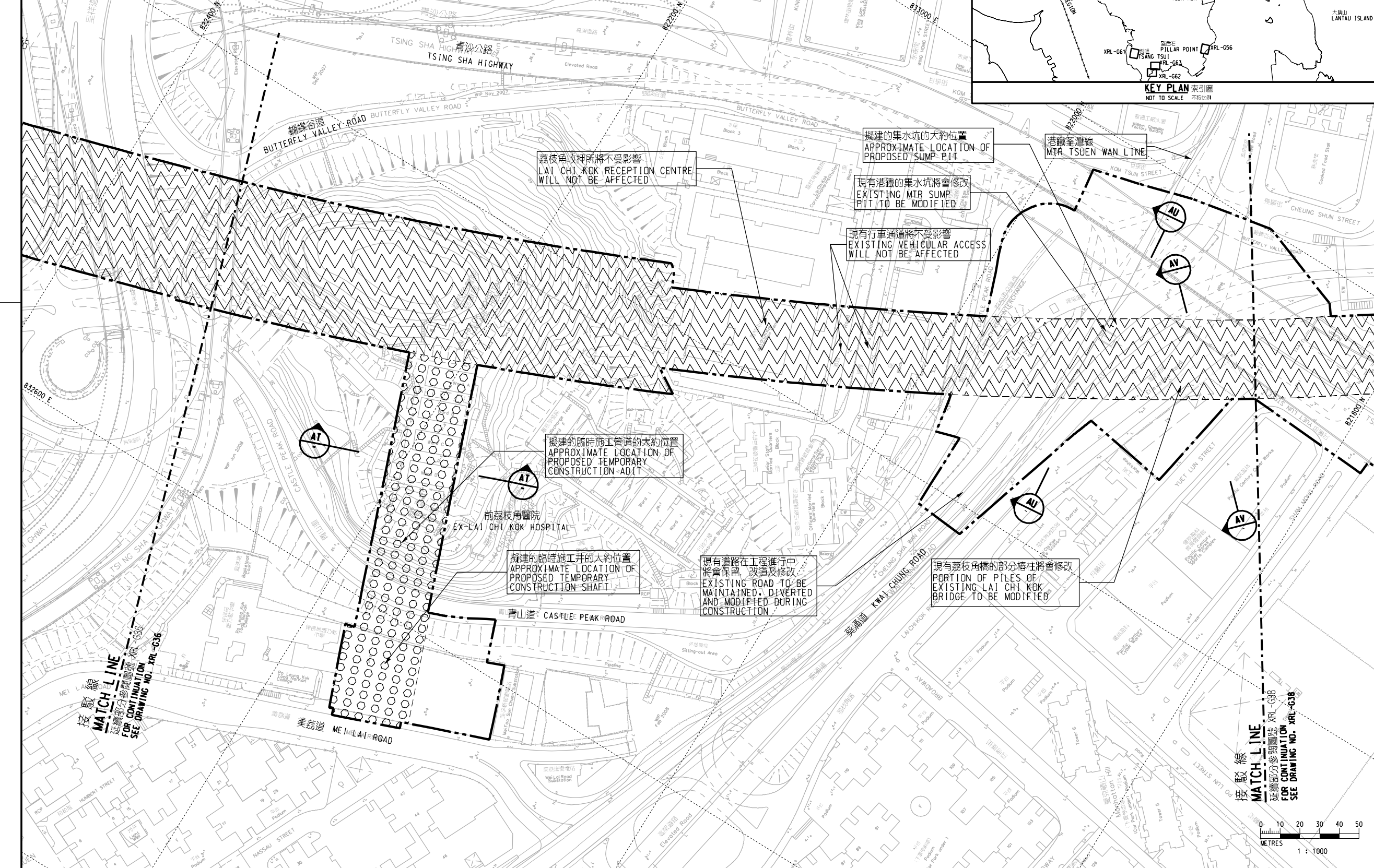

一般說明 GENERAL NOTES

1. 有關一般說明參閱圖號 XRL - G01.
FOR GENERAL NOTES, REFER TO DRAWING NO. XRL - G01.

修改表					
TABLE OF AMENDMENTS					
修訂	日期	繪圖	核對	負責	說明
REV	DATE	BY	SUB	APP	DESCRIPTION

獲准發出 APPROVED FOR ISSUE

路政署
鐵路發展處處長(2)
GOVERNMENT ENGINEER/
RAILWAY DEVELOPMENT (2)
HIGHWAYS DEPARTMENT

發出日期 DATE OF ISSUE

圖則名稱 DRAWING TITLE
廣深港高速鐵路香港段
鐵路條例(第519章)
總體規劃圖則 63頁的第37頁
HONG KONG SECTION OF
GUANGZHOU - SHENZHEN - HONG KONG
EXPRESS RAIL LINK
RAILWAYS ORDINANCE (CHAPTER 519)
GENERAL LAYOUT PLAN SHEET 37 OF 63

圖號 DRAWING NO.	比例 SCALE
XRL - G37	1:1000 (A1)

或如顯示
AS SHOWN

香港特別行政區政府
THE GOVERNMENT OF THE HONG KONG
SPECIAL ADMINISTRATIVE REGION

路政署
HIGHWAYS DEPARTMENT

鐵路拓展處
RAILWAY DEVELOPMENT OFFICE

