

一般說明 GENERAL NOTES

1. 切面圖所示鐵路設施的形狀和輪廓均屬示意性質。GEOMETRY AND CONFIGURATION OF RAILWAY FACILITIES SHOWN IN SECTIONS ARE SCHEMATIC.
2. 所有在方案界線內的道路（包括行車道、行人徑及露天地方），無論有否在圖則中顯示，都可能會永久或暫時封閉或大幅改動。ALL ROADS INCLUDING CARRIAGEWAYS, FOOTPATHS AND OPEN PLACES WITHIN THE BOUNDARY OF THE SCHEME, WHETHER OR NOT SHOWN ON THE DRAWINGS MAY BE CLOSED OR ALTERED SUBSTANTIALLY ON A PERMANENT OR TEMPORARY BASIS.
3. 除非圖則中特別註明，否則在方案界線內，或與方案界線毗鄰的所有建築物、汽車通道及行人通道，包括逃生路徑，將會保留。UNLESS NOTED OTHERWISE ON THE DRAWINGS, VEHICULAR AND PEDESTRIAN ACCESSES INCLUDING MEANS OF ESCAPE TO AND FROM ALL BUILDINGS WITHIN OR ADJACENT TO THE BOUNDARY OF THE SCHEME ARE TO BE MAINTAINED.
4. 所有水平均為約數，以米為單位，並高於香港的主水平基準。ALL LEVELS ARE APPROXIMATE AND IN METRES ABOVE HONG KONG PRINCIPAL DATUM (MPD).
5. 圖則顯示的建造方法分界線只是大概位置，有關界線可因應當時的地盤情況而作出改動。BOUNDARIES SHOWN ON DRAWINGS FOR THE CONSTRUCTION METHODS TO BE CARRIED OUT ARE APPROXIMATE ONLY. THESE BOUNDARIES MAY BE ALTERED ON SITE TO SUIT PREVAILING SITE CONDITIONS.

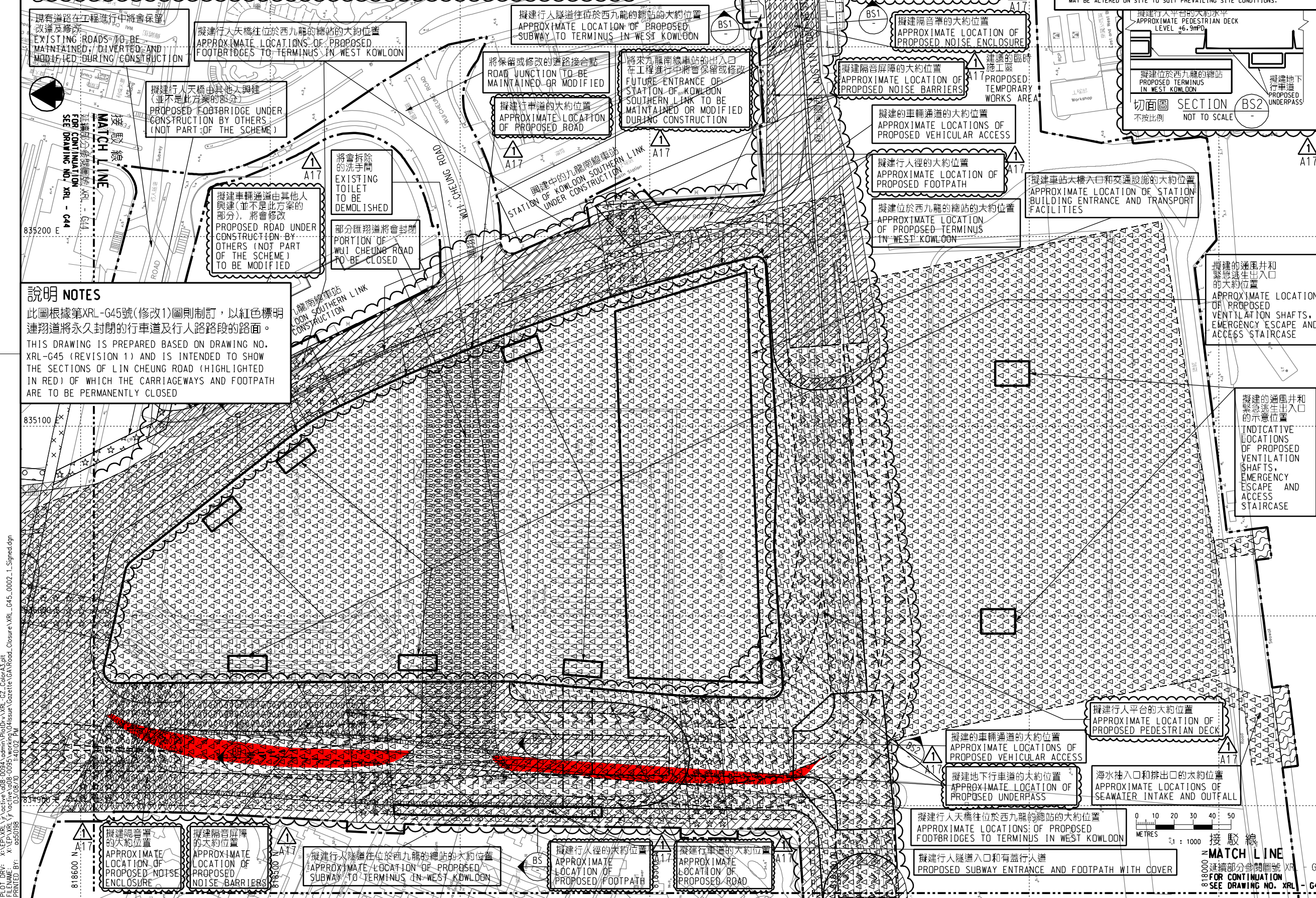
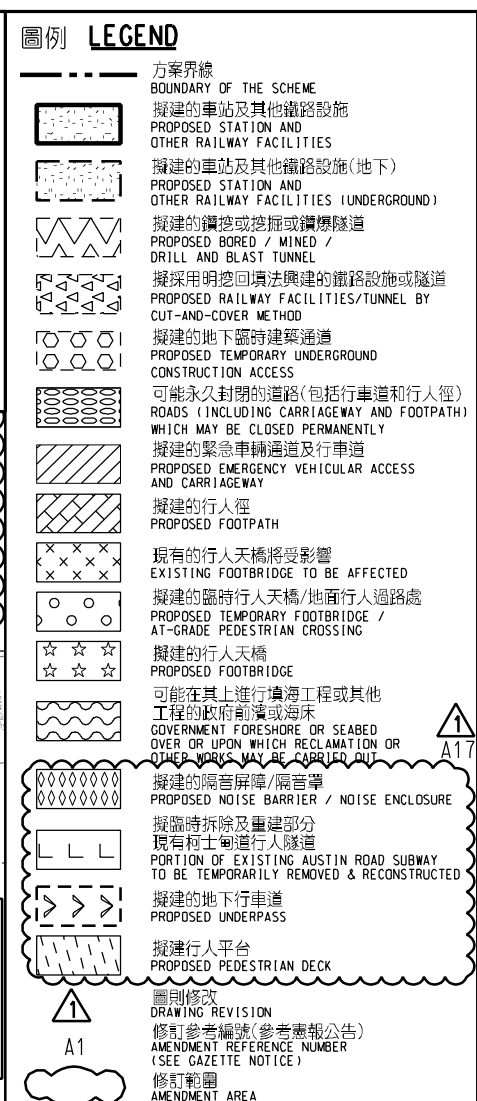

說明 NOTES

此圖根據第XRL-G45號(修改1)圖則制訂，以紅色標明連翔道將永久封閉的行車道及行人路路段的路面。
THIS DRAWING IS PREPARED BASED ON DRAWING NO. XRL-G45 (REVISION 1) AND IS INTENDED TO SHOW THE SECTIONS OF LIN CHEUNG ROAD (HIGHLIGHTED IN RED) OF WHICH THE CARRIAGEWAYS AND FOOTPATH ARE TO BE PERMANENTLY CLOSED

修訂表
TABLE OF AMENDMENTS

修訂	日期	繪圖	核對	繪圖	說明
REV	DATE	BY	SUB	APP	DESCRIPTION

SIGNED

獲准發出
APPROVED FOR ISSUE

2/8/2010

發出日期 DATE OF ISSUE

林世雄 LAM SAU HUNG
路政署
鐵路拓展處處工程師(2-3)
CHIEF ENGINEER/
RAILWAY DEVELOPMENT (2-3)
HIGHWAYS DEPARTMENT

圖則名稱 DRAWING TITLE

鐵路條例(第519章)
廣深港高速鐵路香港段
永久封閉部分連翔道

RAILWAYS ORDINANCE (CHAPTER 519)
HONG KONG SECTION OF
GUANGZHOU - SHENZHEN - HONG KONG
EXPRESS RAIL LINK
PERMANENT CLOSURE OF SECTIONS
OF LIN CHEUNG ROAD

圖號 DRAWING NO. XRL/G45/0002/1

比例 SCALE 1:1000 (A1)
或如顯示
AS SHOWN

香港特別行政區政府
THE GOVERNMENT OF THE HONG KONG
SPECIAL ADMINISTRATIVE REGION

路政署
HIGHWAYS DEPARTMENT

鐵路拓展處
RAILWAY DEVELOPMENT OFFICE

User: Workspace C:\Program Files\Bentley\B55\Workspace\Users\XRL_G45\0002_1_Signed.dgn
Date: 03/08/10 14:02:02
Printed By: 050198