

PLT: PLOT.DWG  
PRINTED BY: frko  
DATE: 10/11/2015  
FILENAME: X:\Land\SCL\PI\Road\_Closure\Map\SCL-G11-0034-2.dgn

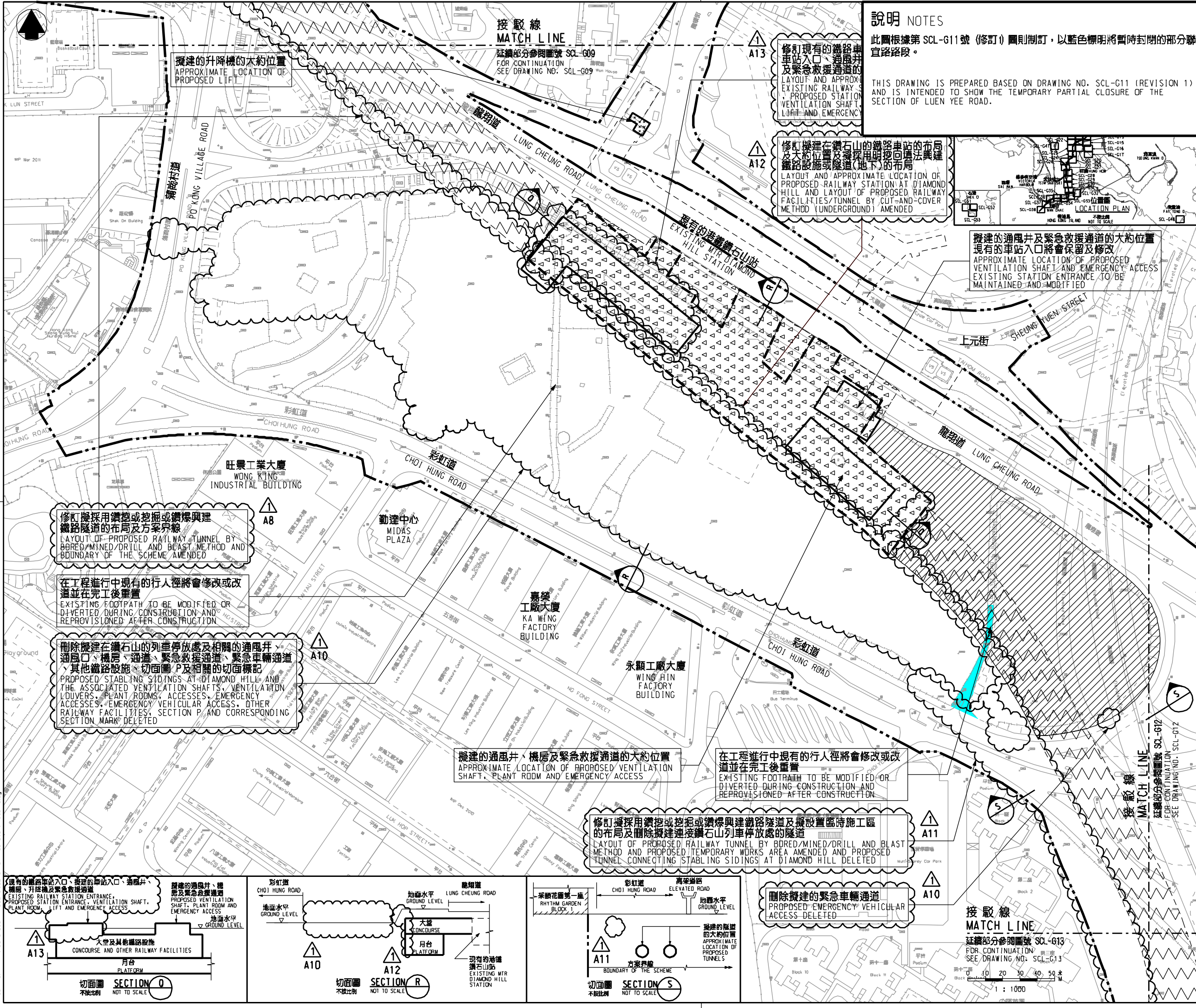

### 說明 NOTES

此圖根據第 SCL-G11 號 (修訂) 圖則制訂, 以藍色標明將暫時封閉的部分聯宜路路段。  
THIS DRAWING IS PREPARED BASED ON DRAWING NO. SCL-G11 (REVISION 1) AND IS INTENDED TO SHOW THE TEMPORARY PARTIAL CLOSURE OF THE SECTION OF LUEN YEE ROAD.

修訂現有的鐵路車站入口、通風井及緊急救援通道的佈局及方案界線  
LAYOUT AND APPROXIMATE LOCATION OF EXISTING RAILWAY STATION ENTRANCE, PROPOSED STATION ENTRANCE, VENTILATION SHAFT, LIFT AND EMERGENCY ACCESS

修訂擬採用的鑽挖或掘或鑽爆興建鐵路隧道的佈局及方案界線  
LAYOUT AND APPROXIMATE LOCATION OF PROPOSED RAILWAY TUNNEL BY BORED/MINED/DRILL AND BLAST METHOD (UNDERGROUND) AMENDED



擬建的通風井及緊急救援通道的大約位置  
現有的車站入口將會保留及修改  
APPROXIMATE LOCATION OF PROPOSED VENTILATION SHAFT AND EMERGENCY ACCESS  
EXISTING STATION ENTRANCE TO BE MAINTAINED AND MODIFIED

修訂擬採用的鑽挖或掘或鑽爆興建鐵路隧道的佈局及方案界線  
LAYOUT OF PROPOSED RAILWAY TUNNEL BY BORED/MINED/DRILL AND BLAST METHOD AND BOUNDARY OF THE SCHEME AMENDED

在工程進行中現有的行人徑將會修改或改道並在完工後重置  
EXISTING FOOTPATH TO BE MODIFIED OR DIVERTED DURING CONSTRUCTION AND REPROVISIONED AFTER CONSTRUCTION

刪除擬採用的鑽挖或掘或鑽爆興建鐵路隧道的佈局及方案界線  
PROPOSED STABLING SIDINGS AT DIAMOND HILL AND THE ASSOCIATED VENTILATION SHAFTS, VENTILATION LOUVERS, PLANT ROOMS, ACCESSES, EMERGENCY ACCESSES, EMERGENCY VEHICULAR ACCESS, OTHER RAILWAY FACILITIES, SECTION P AND CORRESPONDING SECTION MARK DELETED

擬建的通風井、機房及緊急救援通道的大約位置  
APPROXIMATE LOCATION OF PROPOSED VENTILATION SHAFT, PLANT ROOM AND EMERGENCY ACCESS

在工程進行中現有的行人徑將會修改或改道並在完工後重置  
EXISTING FOOTPATH TO BE MODIFIED OR DIVERTED DURING CONSTRUCTION AND REPROVISIONED AFTER CONSTRUCTION

修訂擬採用的鑽挖或掘或鑽爆興建鐵路隧道的佈局及方案界線及刪除擬採用的鑽挖或掘或鑽爆興建鐵路隧道的佈局及方案界線  
LAYOUT OF PROPOSED RAILWAY TUNNEL BY BORED/MINED/DRILL AND BLAST METHOD AND PROPOSED TEMPORARY WORKS AREA AMENDED AND PROPOSED TUNNEL CONNECTING STABLING SIDINGS AT DIAMOND HILL DELETED

刪除擬建的緊急車輛通道  
PROPOSED EMERGENCY VEHICULAR ACCESS DELETED

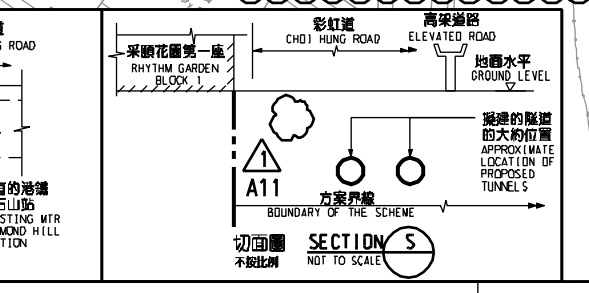
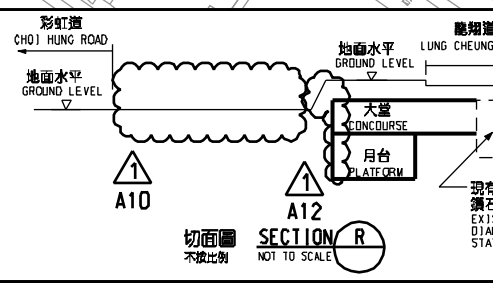
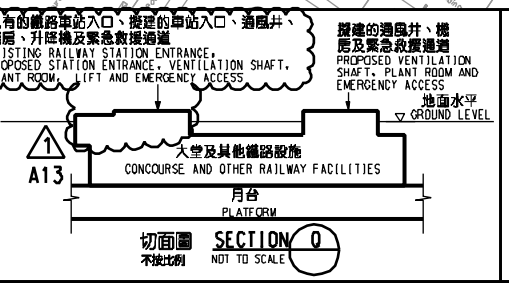

### 圖例 LEGEND

- 方案界線 (BOUNDARY OF THE SCHEME)
- 擬建的鐵路車站及其他鐵路設施(地下) (PROPOSED RAILWAY STATION AND OTHER RAILWAY FACILITIES (UNDERGROUND))
- 擬建的車站 / 車站入口 / 通風井 / 通風井 / 其他鐵路設施或永久建築物 (PROPOSED RAILWAY STATION/STATION ENTRANCES/VENTILATION BUILDINGS/VENTILATION SHAFTS/OTHER RAILWAY FACILITIES OR PERMANENT STRUCTURES)
- 現有的車站及其他鐵路設施 (EXISTING STATION AND OTHER RAILWAY FACILITIES)
- 擬採用的鑽挖或掘或鑽爆興建鐵路隧道的佈局 (地下) (PROPOSED RAILWAY TUNNEL BY BORED/MINED/DRILL AND BLAST METHOD (UNDERGROUND))
- 擬採用的鑽挖或掘或鑽爆興建鐵路隧道的佈局 (地下) (地下) (PROPOSED RAILWAY TUNNEL BY CUT-AND-COVER METHOD (UNDERGROUND))
- 可永久封閉的鐵路 (包括行車徑、行人徑及露天地方) 其後可能會永久封閉 (CLOSED PERMANENTLY WHICH MAY BE CLOSED PERMANENTLY)
- 擬設置的臨時工程區 (PROPOSED TEMPORARY WORKS AREA FOR SITE FACILITIES)
- 擬設置的臨時工程區 (包括政府地段的臨時工程) (可能在上列工程(非永久工程)或其他工程) (PROPOSED TEMPORARY WORKS AREA FOR SITE FACILITIES ON GOVERNMENT FORESHORE OR SEABED (OVER OR UPON WHICH RECLAMATION (NOT FOR THE PURPOSE OF FORMING LAND) OR OTHER WORKS MAY BE CARRIED OUT))
- 擬設置的人行道 / 扶手电梯 / 升降機 / 樓梯 (PROPOSED FOOTBRIDGE/ESCALATOR/LIFT/STAIRCASE)
- 擬建的有蓋行人道 (PROPOSED COVERED WALKWAY)
- 擬採用的鑽挖或掘或鑽爆興建鐵路隧道的佈局 (地下) (可能在上列工程(非永久工程)或其他工程) (PROPOSED RAILWAY TUNNEL BY CUT-AND-COVER METHOD ON GOVERNMENT FORESHORE OR SEABED (OVER OR UPON WHICH RECLAMATION (FOR THE PURPOSE OF FORMING LAND) OR OTHER WORKS MAY BE CARRIED OUT))
- 擬採用的鑽挖或掘或鑽爆興建鐵路隧道的佈局 (地下) (可能在上列工程(非永久工程)或其他工程) (PROPOSED RAILWAY TUNNEL BY CUT-AND-COVER METHOD (UNDERGROUND) (INCLUDING PROTECTION LAYER/PROCK ARMOUR) BY IMMERSIBLE TUBE METHOD ON GOVERNMENT FORESHORE OR SEABED (OVER OR UPON WHICH RECLAMATION (NOT FOR THE PURPOSE OF FORMING LAND) OR OTHER WORKS MAY BE CARRIED OUT))
- 擬採用的鑽挖或掘或鑽爆興建鐵路隧道的佈局 (地下) (PROPOSED RAILWAY FACILITIES/TUNNELS (UNDERGROUND) AT PROTECTION STRUCTURES)
- 擬採用的鑽挖或掘或鑽爆興建鐵路隧道的佈局 (地下) (PROPOSED RAILWAY FACILITIES/TUNNELS (UNDERGROUND) (INCLUDING PROTECTION LAYER/PROCK ARMOUR) BY IMMERSIBLE TUBE METHOD ON GOVERNMENT FORESHORE OR SEABED (OVER OR UPON WHICH RECLAMATION (NOT FOR THE PURPOSE OF FORMING LAND) OR OTHER WORKS MAY BE CARRIED OUT))
- 擬採用的鑽挖或掘或鑽爆興建鐵路隧道的佈局 (地下) (PROPOSED RAILWAY FACILITIES/TUNNELS (UNDERGROUND) AT PROTECTION STRUCTURES)
- 擬採用的鑽挖或掘或鑽爆興建鐵路隧道的佈局 (地下) (PROPOSED RAILWAY FACILITIES/TUNNELS (UNDERGROUND) (INCLUDING PROTECTION LAYER/PROCK ARMOUR) BY IMMERSIBLE TUBE METHOD ON GOVERNMENT FORESHORE OR SEABED (OVER OR UPON WHICH RECLAMATION (NOT FOR THE PURPOSE OF FORMING LAND) OR OTHER WORKS MAY BE CARRIED OUT))

一般說明 GENERAL NOTES  
1. 有關一般說明參閱圖號 SCL-G01 FOR GENERAL NOTES, REFER TO DRAWING NO. SCL-G01.

修訂號 REV.	日期 DATE	修訂人 BY	核對人 SUB	用途 APP	說明 DESCRIPTION

簽名	簽名
FRANKIE W P CHIU	FRANKIE W P CHIU

10/11/2015

鐵路條例 (第519章) 沙田至中環線 暫時封閉聯宜路路段  
RAILWAYS ORDINANCE (CHAPTER 519) SHATIN TO CENTRAL LINK TEMPORARY CLOSURE OF A SECTION OF LUEN YEE ROAD

圖號 DRAWING NO. SCL/G11/0034/2 比例 SCALE 1:1000 (A1) 或前顯示 OR AS SHOWN

香港特別行政區政府 THE GOVERNMENT OF THE HONG KONG SPECIAL ADMINISTRATIVE REGION  
路政署 HIGHWAYS DEPARTMENT  
鐵路拓展處 RAILWAY DEVELOPMENT OFFICE