

說明 NOTES

此圖根據第 SCL-G04 號圖則制訂，以黃色標明將暫時封閉介乎沙田顯徑邨顯祐樓與顯富樓之間的部分未命名道路路段。

THIS DRAWING IS PREPARED BASED ON DRAWING NO. SCL-G04 AND IS INTENDED TO SHOW THE TEMPORARY PARTIAL CLOSURE OF THE SECTION OF THE UNNAMED ROAD BETWEEN HIN YAU HOUSE AND HIN FU HOUSE OF HIN KENG ESTATE, SHATIN (HIGHLIGHTED IN YELLOW).

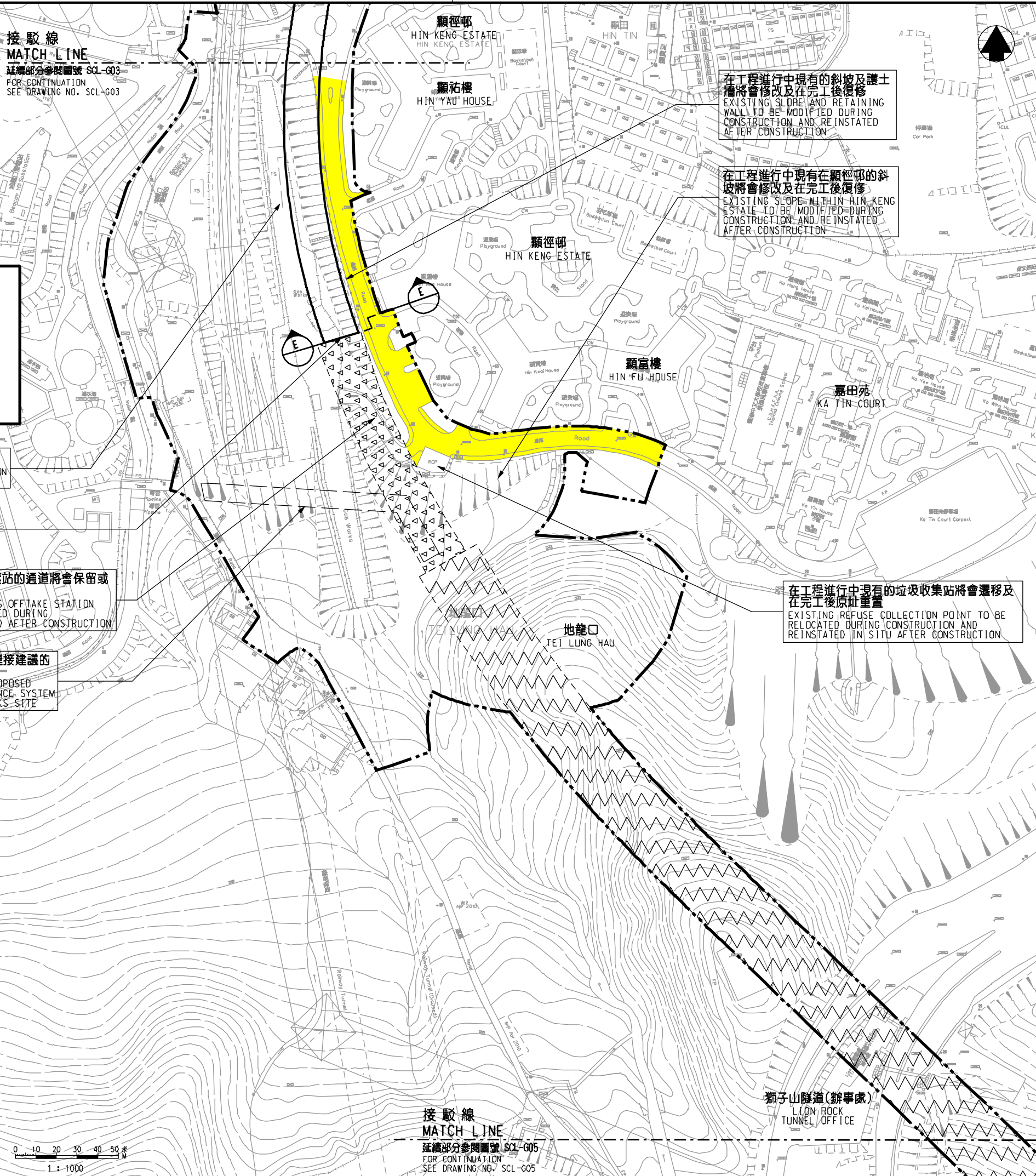
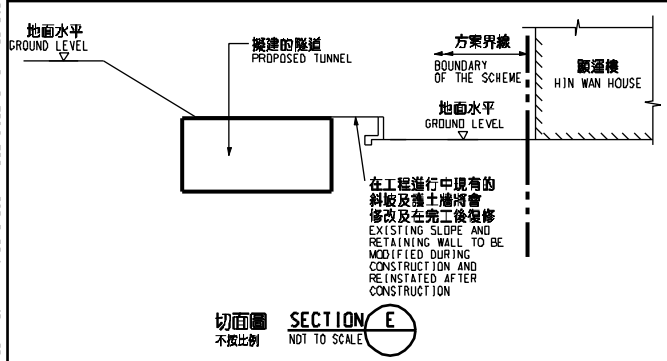

現有的煤氣調壓站將會修改
EXISTING GAS OFF-TAKE STATION TO BE MODIFIED

擬建的隧道入口的大約位置
APPROXIMATE LOCATION OF PROPOSED TUNNEL PORTAL

在工程進行中現有往煤氣調壓站的通道將會保留或修改及在完工後復修
EXISTING ACCESS ROAD TO GAS OFF-TAKE STATION TO BE MAINTAINED OR MODIFIED DURING CONSTRUCTION AND REINSTATED AFTER CONSTRUCTION

擬建的臨時架空輸送帶系統連接建議的工地的大約位置
APPROXIMATE LOCATION OF PROPOSED TEMPORARY OVERHEAD CONVEYANCE SYSTEM CONNECTING TO PROPOSED WORKS SITE

在工程進行中現有的斜坡及護土牆將會修改及在完工後復修
EXISTING SLOPE AND RETAINING WALL TO BE MODIFIED DURING CONSTRUCTION AND REINSTATED AFTER CONSTRUCTION

在工程進行中現有在顯徑邨的斜坡將會修改及在完工後復修
EXISTING SLOPE WITHIN HIN KENG ESTATE TO BE MODIFIED DURING CONSTRUCTION AND REINSTATED AFTER CONSTRUCTION

在工程進行中現有的垃圾收集站將會遷移及在完工後原址復舊
EXISTING REFUSE COLLECTION POINT TO BE RELOCATED DURING CONSTRUCTION AND REINSTATED IN SITU AFTER CONSTRUCTION

圖例 LEGEND

- 方案界線
BOUNDARY OF THE SCHEME
- 擬建的車站及其他鐵路設施(地下)
PROPOSED RAILWAY STATION AND OTHER RAILWAY FACILITIES (UNDERGROUND)
- 擬建的車站 / 車站入口 / 通道大樓 / 通風井 / 其他鐵路設施或永久建築
PROPOSED RAILWAY STATION/STATION ENTRANCES/VENTILATION BUILDINGS/VENTILATION SHAFTS/OTHER RAILWAY FACILITIES OR PERMANENT STRUCTURES
- 現有的車站及其他鐵路設施
EXISTING STATION AND OTHER RAILWAY FACILITIES
- 鑽探或鑽孔或岩層或礦井(地下)
PROPOSED RAILWAY FACILITIES/TUNNEL BY BORE/DRIED/DRILL AND BLAST METHOD (UNDERGROUND)
- 擬建採用明挖法或明挖法建造的鐵路設施或隧道(地下)
PROPOSED RAILWAY FACILITIES/TUNNEL BY CUT-AND-COVER METHOD (UNDERGROUND)
- 可能永久封閉的範圍(包括行人通道、行人徑及露天地方) 可能永久封閉的範圍(包括行人通道、行人徑及露天地方) 可能永久封閉的範圍(包括行人通道、行人徑及露天地方)
ROADS (INCLUDING CARRIAGEWAYS, FOOTPATHS AND OPEN PLACE) WHICH MAY BE CLOSED PERMANENTLY
- 擬建臨時工地的範圍
PROPOSED TEMPORARY WORKS AREA FOR SITE FACILITIES
- 擬建於政府或私人土地上的臨時工程(可能在其上進行填海工程(非為形成土地)或其他工程)
PROPOSED TEMPORARY WORKS AREA FOR SITE FACILITIES ON GOVERNMENT FORESHORE OR SEABED COVER OR UPON WHICH RECLAMATION (NOT FOR THE PURPOSE OF FORMING LAND) OR OTHER WORKS MAY BE CARRIED OUT
- 擬建的人行天橋 / 扶手電梯 / 升降機 / 樓梯
PROPOSED FOOTBRIDGE/ESCALATOR/LIFT/STAIRCASE
- 擬建的有蓋行人通道
PROPOSED COVERED WALKWAY
- 擬建於政府或私人土地上的臨時工程(可能在其上進行填海工程(非為形成土地)或其他工程)
PROPOSED RAILWAY FACILITIES/TUNNEL BY CUT-AND-COVER METHOD ON GOVERNMENT FORESHORE OR SEABED COVER OR UPON WHICH RECLAMATION (NOT FOR THE PURPOSE OF FORMING LAND) OR OTHER WORKS MAY BE CARRIED OUT
- 擬建於政府或私人土地上的臨時工程(可能在其上進行填海工程(非為形成土地)或其他工程)
PROPOSED RAILWAY FACILITIES/TUNNEL BY CUT-AND-COVER METHOD ON GOVERNMENT FORESHORE OR SEABED COVER OR UPON WHICH RECLAMATION (NOT FOR THE PURPOSE OF FORMING LAND) OR OTHER WORKS MAY BE CARRIED OUT
- 擬建於政府或私人土地上的臨時工程(可能在其上進行填海工程(非為形成土地)或其他工程)
PROPOSED RAILWAY FACILITIES/TUNNELS (UNDERGROUND) AT PROTECTION STRUCTURES
- 擬建於沙田至中環線及另一項正在規劃的鐵路項目(地下) 另一項鐵路項目(地下) 擬建的車站 / 車站入口 / 通道大樓 / 通風井 / 其他鐵路設施或永久建築(地下) 設施)
PROPOSED RAILWAY TUNNEL (UNDERGROUND)/RAILWAY STATION/STATION CONCOURSE/STATION ENTRANCES/VENTILATION BUILDINGS/VENTILATION SHAFTS/OTHER RAILWAY FACILITIES OR PERMANENT STRUCTURES (HEREINAFTER REFERRED TO AS THE FACILITIES) FOR SHATIN TO CENTRAL LINK AND ANOTHER RAILWAY PROJECT UNDER PLANNING HEREAFTER REFERRED TO AS ANOTHER RAILWAY PROJECT. THE LAYOUT OF THE FACILITIES IS GAZETTED UNDER ANOTHER RAILWAY PROJECT
- 受影響的政府或私人土地的大約範圍
APPROXIMATE EXTENT OF AFFECTED GOVERNMENT FORESHORE OR SEABED

一般說明 GENERAL NOTES

1. 有關一般說明參閱圖號 SCL-G01.
FOR GENERAL NOTES, REFER TO DRAWING NO. SCL-G01.

修改表
TABLE OF AMENDMENTS

修訂號	日期	修訂人	修訂原因	說明	
REV	DATE	BY	SUB	APP	DESCRIPTION

SIGNED

香港發出
APPROVED FOR ISSUE

4/11/2015

發出日期 DATE OF ISSUE

曹榮平 FRANKIE W P CHIU
總工程師 / 鐵路發展(1-3)
CHIEF ENGINEER/
RAILWAY DEVELOPMENT (1-3)
HIGHWAYS DEPARTMENT

圖則名稱 DRAWING TITLE
鐵路條例(第519章)
沙田至中環線
暫時封閉介乎沙田顯徑邨顯祐樓與顯富樓之間的未命名道路路段

RAILWAYS ORDINANCE (CHAPTER 519)
SHATIN TO CENTRAL LINK
TEMPORARY CLOSURE OF A SECTION OF AN UNNAMED ROAD BETWEEN HIN YAU HOUSE AND HIN FU HOUSE OF HIN KENG ESTATE, SHATIN

圖號 DRAWING NO.
SCL/G04/0029/3

比例 SCALE
1:1000 (A1)
或如顯示
AS SHOWN

香港特別行政區政府
THE GOVERNMENT OF THE HONG KONG
SPECIAL ADMINISTRATIVE REGION

路政署
HIGHWAYS DEPARTMENT

鐵路拓展處
RAILWAY DEVELOPMENT OFFICE

Plot: 112242
Printed: 04/11/2015
Filename: X:\Lands\SC\PA\Road\Doc\scure\W\Wb\SCL-G04-0029-3.dgn