

說明 NOTES

此圖根據第 SCL-G12 號圖則訂制，以綠色標明將暫時封閉的部分龍翔道路段。

THIS DRAWING IS PREPARED BASED ON DRAWING NO. SCL-G12 AND IS INTENDED TO SHOW THE TEMPORARY PARTIAL CLOSURE OF THE SECTION OF LUNG CHEUNG ROAD (HIGHLIGHTED IN GREEN).

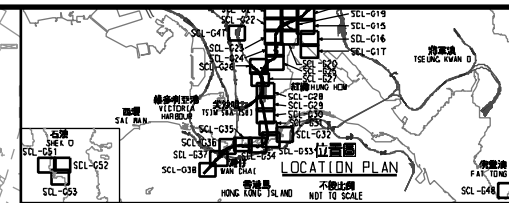

圖例 LEGEND

- 方案界線
BOUNDARY OF THE SCHEME
- 擬建的鐵路車站及其他鐵路設施(地下)
PROPOSED RAILWAY STATION/STATION ENTRANCES/VENTILATION BUILDINGS/VENTILATION SHAFTS/OTHER RAILWAY FACILITIES OR PERMANENT STRUCTURES (UNDERGROUND)
- 擬建的車站 / 車站入口 / 通風大樓 / 通風井 / 其他鐵路設施或永久建築物
PROPOSED RAILWAY STATION/STATION ENTRANCES/VENTILATION BUILDINGS/VENTILATION SHAFTS/OTHER RAILWAY FACILITIES OR PERMANENT STRUCTURES
- 現有的車站及其他鐵路設施
EXISTING STATION AND OTHER RAILWAY FACILITIES
- 擬採用鑽挖或掘削的鐵路設施(地下)
PROPOSED RAILWAY FACILITIES/TUNNEL BY BORED/WINED/DRILL AND BLAST METHOD (UNDERGROUND)
- 擬採用明挖或蓋挖的鐵路設施(地下)
PROPOSED RAILWAY FACILITIES/TUNNEL BY CUT-AND-COVER METHOD (UNDERGROUND)
- 可能永久封閉的道路(包括行車道、行人徑及露天地方) WHICH MAY BE CLOSED PERMANENTLY
- 擬設置地盤的臨時工程區
PROPOSED TEMPORARY WORKS AREA FOR SITE FACILITIES
- 擬於政府前濱或海床設置地盤的臨時工程區(可能在其上進行填海工程(非為形成土地)或其他工程)
PROPOSED TEMPORARY WORKS AREA FOR SITE FACILITIES ON GOVERNMENT FORESHORE OR SEA BED (OTHER THAN RECLAMATION (NOT FOR THE PURPOSE OF FORMING LAND) OR OTHER WORKS MAY BE CARRIED OUT)
- 擬建的行人天橋 / 扶手电梯 / 升降機 / 樓梯
PROPOSED FOOTBRIDGE/ESCALATOR/LIFT/STAIRCASE
- 擬建的有蓋行人通道
PROPOSED COVERED WALKWAY
- 擬於政府前濱或海床採用明挖或掘削的鐵路設施(地下)
PROPOSED RAILWAY FACILITIES/TUNNEL BY CUT-AND-COVER METHOD ON GOVERNMENT FORESHORE OR SEA BED (OTHER THAN RECLAMATION (NOT FOR THE PURPOSE OF FORMING LAND) OR OTHER WORKS MAY BE CARRIED OUT)
- 擬於政府前濱或海床採用明挖或掘削的鐵路設施(地下) (包括保護層/護面磚)
PROPOSED RAILWAY FACILITIES/TUNNEL BY CUT-AND-COVER METHOD ON GOVERNMENT FORESHORE OR SEA BED (OTHER THAN RECLAMATION (NOT FOR THE PURPOSE OF FORMING LAND) OR OTHER WORKS MAY BE CARRIED OUT) (INCLUDING PROTECTION LAYER/ROCK ARMOUR) BY (IMMERSED TUBE METHOD ON GOVERNMENT FORESHORE OR SEA BED) (OTHER THAN RECLAMATION (NOT FOR THE PURPOSE OF FORMING LAND) OR OTHER WORKS MAY BE CARRIED OUT)
- 擬建的保護結構的鐵路設施 / 隧道(地下)
PROPOSED RAILWAY FACILITIES/TUNNEL(S) UNDERGROUND AT PROTECTION STRUCTURES
- 擬在沙田中環及另一項正在研究的鐵路項目(下列「另一項鐵路項目」)的範圍(地下) / 車站 / 車站大樓 / 車站入口 / 通風大樓 / 通風井 / 其他鐵路設施或永久建築物(下列「設施」) / 設施的永久封閉(下列「封閉」) / 設施的永久封閉(下列「封閉」)
PROPOSED RAILWAY TUNNEL(Underground)/RAILWAY STATION/STATION CONCOURSE/STATION ENTRANCES/VENTILATION BUILDINGS/VENTILATION SHAFTS/OTHER RAILWAY FACILITIES OR PERMANENT STRUCTURES (HEREINAFTER REFERRED TO AS "THE FACILITIES") FOR SHATIN CENTRAL LINK AND ANOTHER RAILWAY PROJECT UNDER PLANNING (HEREINAFTER REFERRED TO AS "ANOTHER RAILWAY PROJECT"). THE LAYOUT OF THE FACILITIES IS GAZETTED UNDER ANOTHER RAILWAY PROJECT
- 受影響的政府前濱或海床的大約範圍
APPROXIMATE EXTENT OF AFFECTED GOVERNMENT FORESHORE OR SEA BED

一般說明 GENERAL NOTES
1. 有關一般說明參閱圖號 SCL-G01.
FOR GENERAL NOTES, REFER TO DRAWING NO. SCL-G01.

修訂表
TABLE OF AMENDMENTS

修訂號	日期	修訂人	修訂內容	說明	
REV	DATE	BY	SUB	APP	DESCRIPTION

SIGNED
簽發日期 DATE OF ISSUE: 27/3/2017
簽署人 ANTHONY YUEN
職銜 CHIEF ENGINEER / 鐵路發展 (1-3) / RAILWAY DEVELOPMENT (1-3) / HIGHWAYS DEPARTMENT

圖則名稱 DRAWING TITLE:
鐵路條例(第519章) 沙田至中環線 暫時封閉龍翔道路段

RAILWAYS ORDINANCE (CHAPTER 519)
SHATIN TO CENTRAL LINK
TEMPORARY CLOSURE OF A SECTION OF LUNG CHEUNG ROAD

圖號 DRAWING NO.: SCL/G12/0016/5
比例 SCALE: 1:1000 (A1)
或顯示 AS SHOWN

香港特別行政區政府
THE GOVERNMENT OF THE HONG KONG
SPECIAL ADMINISTRATIVE REGION
路政署
HIGHWAYS DEPARTMENT
鐵路拓展處
RAILWAY DEVELOPMENT OFFICE

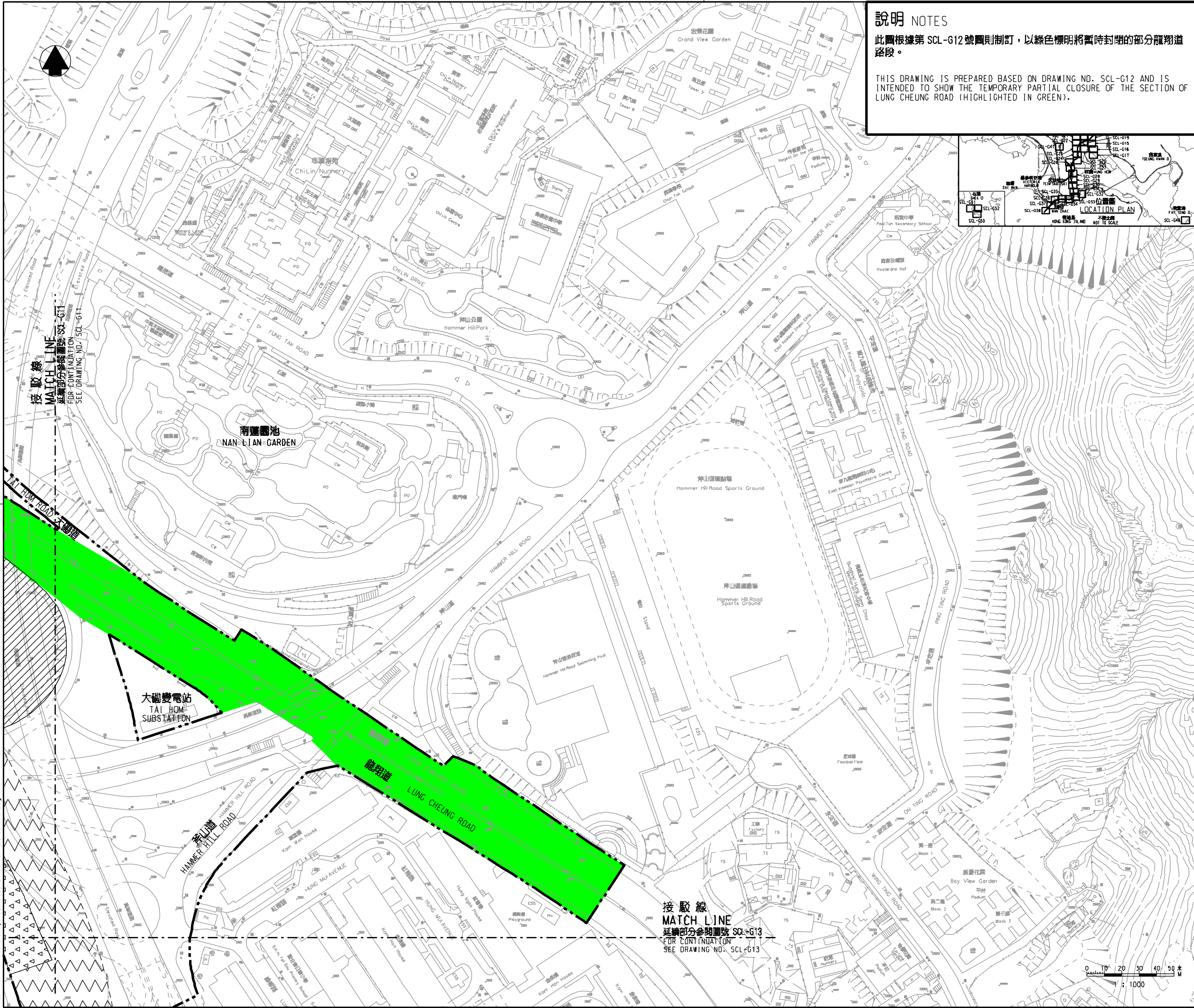

PLOT DRW: E:\lib\Plot\181\81\p1\inter.plt
PRINTED BY: ftko 28/03/2017 05:26:34
FILENAME: x:\lomo\sc1\p1\road closure\rev\web\sc1-02-006-5.dgn