

圖例 LEGEND

- 方案界線
BOUNDARY OF THE SCHEME
- 擬建的車站及其他鐵路設施
PROPOSED STATION AND OTHER RAILWAY FACILITIES
- 擬建的車站及其他鐵路設施(地下)
PROPOSED STATION AND OTHER RAILWAY FACILITIES (UNDERGROUND)
- 擬採用鑽挖或掘鑽的鐵路設施或隧道(地下)
PROPOSED RAILWAY FACILITIES/TUNNEL BY BORED / MINED / DRILL AND BLAST METHOD (UNDERGROUND)
- 擬採用明挖回填法興建的鐵路設施或隧道(地下)
PROPOSED RAILWAY FACILITIES/TUNNEL BY CUT-AND-COVER METHOD (UNDERGROUND)
- 可能永久封閉的道路(包括行車道和行人徑)
ROADS (INCLUDING CARRIAGEWAY AND FOOTPATH) WHICH MAY BE CLOSED PERMANENTLY
- 擬建的鐵路高架橋
PROPOSED RAILWAY VIADUCT
- 現有的行人天橋將受影響
EXISTING FOOTBRIDGE TO BE AFFECTED
- 擬建的臨時行人天橋/地面行人過路處
PROPOSED TEMPORARY FOOTBRIDGE / AT-GRADE PEDESTRIAN CROSSING
- 擬建的行人天橋
PROPOSED FOOTBRIDGE
- 可能在其上進行填海工程或其他工程的政府前灘或海床
GOVERNMENT FORESHORE OR SEA BED OVER OR UPON WHICH RECLAMATION OR OTHER WORKS MAY BE CARRIED OUT
- 現有的車站及其他鐵路設施
EXISTING STATION AND OTHER RAILWAY FACILITIES
- 擬建的臨時架空輸送帶系統
PROPOSED TEMPORARY OVERHEAD CONVEYANCE SYSTEM
- 擬建的鐵路隧道入口
PROPOSED RAILWAY TUNNEL APPROACH
- 以主水平基準為依據之擬建路軌大約水平(米)
PROPOSED APPROXIMATE TRACK LEVEL IN m P.D.
- 圖則修改
DRAWING REVISION
- 修訂參考編號(參考憲報公告)
AMENDMENT REFERENCE NUMBER (SEE GAZETTE NOTICE)
- 修訂範圍
AMENDMENT AREA

說明 NOTES

此圖根據第SILE-G10號(修改1)圖則制訂,以紅色標明將暫時封閉的神神修院附近的行人徑和樓梯。
THIS DRAWING IS PREPARED BASED ON DRAWING NO. SILE-G10 (REVISION 1) AND IS INTENDED TO SHOW THE FOOTPATH AND STAIRCASE NEAR HOLY SPIRIT SEMINARY (HIGHLIGHTED IN RED) TO BE TEMPORARILY CLOSED.

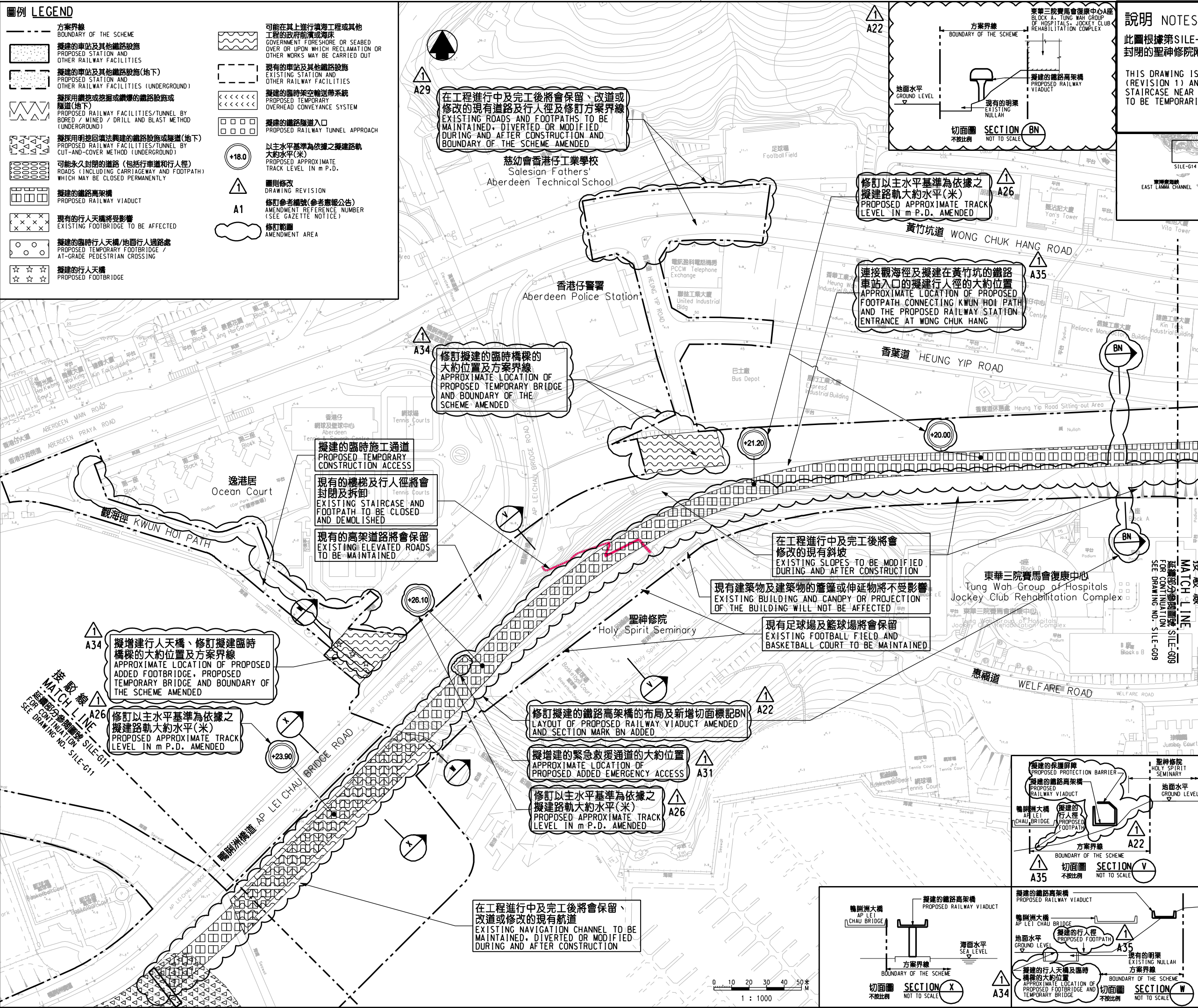
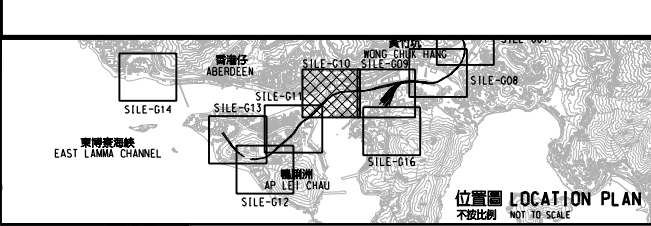

在工程進行中及完工後將會保留、改道或修改的現有道路及行人徑及修訂方案界線
EXISTING ROADS AND FOOTPATHS TO BE MAINTAINED, DIVERTED OR MODIFIED DURING AND AFTER CONSTRUCTION AND BOUNDARY OF THE SCHEME AMENDED

慈幼會香港仔工業學校
Salesian Fathers' Aberdeen Technical School

修訂擬建的臨時橋樑的大約位置及方案界線
APPROXIMATE LOCATION OF PROPOSED TEMPORARY BRIDGE AND BOUNDARY OF THE SCHEME AMENDED

擬建的臨時施工通道
PROPOSED TEMPORARY CONSTRUCTION ACCESS

現有的樓梯及行人徑將會封閉及拆卸
EXISTING STAIRCASE AND FOOTPATH TO BE CLOSED AND DEMOLISHED

現有的高架道路將會保留
EXISTING ELEVATED ROADS TO BE MAINTAINED

在工程進行中及完工後將會修改的現有斜坡
EXISTING SLOPES TO BE MODIFIED DURING AND AFTER CONSTRUCTION

現有建築物及建築物的簷篷或伸延物將不受影響
EXISTING BUILDING AND CANOPY OR PROJECTION OF THE BUILDING WILL NOT BE AFFECTED

現有足球場及籃球場將會保留
EXISTING FOOTBALL FIELD AND BASKETBALL COURT TO BE MAINTAINED

擬增建行人天橋、修訂擬建臨時橋樑的大約位置及方案界線
APPROXIMATE LOCATION OF PROPOSED ADDED FOOTBRIDGE, PROPOSED TEMPORARY BRIDGE AND BOUNDARY OF THE SCHEME AMENDED

修訂以主水平基準為依據之擬建路軌大約水平(米)
PROPOSED APPROXIMATE TRACK LEVEL IN m P.D. AMENDED

修訂擬建的鐵路高架橋的布局及新增切面標記BN
LAYOUT OF PROPOSED RAILWAY VIADUCT AMENDED AND SECTION MARK BN ADDED

擬增建的緊急救援通道的大約位置
APPROXIMATE LOCATION OF PROPOSED ADDED EMERGENCY ACCESS

修訂以主水平基準為依據之擬建路軌大約水平(米)
PROPOSED APPROXIMATE TRACK LEVEL IN m P.D. AMENDED

在工程進行中及完工後將會保留、改道或修改的現有航運
EXISTING NAVIGATION CHANNEL TO BE MAINTAINED, DIVERTED OR MODIFIED DURING AND AFTER CONSTRUCTION

修訂以主水平基準為依據之擬建路軌大約水平(米)
PROPOSED APPROXIMATE TRACK LEVEL IN m P.D. AMENDED

連接觀海徑及擬建在黃竹坑的鐵路車站入口的擬建行人徑的大約位置
APPROXIMATE LOCATION OF PROPOSED FOOTPATH CONNECTING KWUN HOI PATH AND THE PROPOSED RAILWAY STATION ENTRANCE AT WONG CHUK HANG

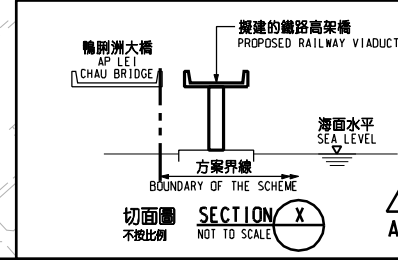
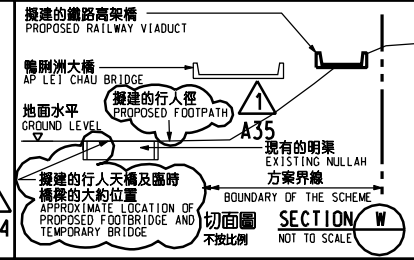
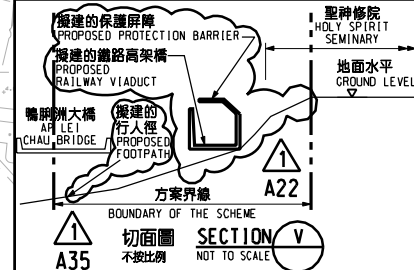

一般說明 GENERAL NOTES
1. 有關一般說明參閱圖號 SILE - G01.
FOR GENERAL NOTES, REFER TO DRAWING NO. SILE - G01.

修訂表 TABLE OF AMENDMENTS					
修訂 REV	日期 DATE	繪製 BY	校對 SUB	負責 APP	說明 DESCRIPTION

SIGNED
簽署發出
APPROVED FOR ISSUE
23/5/2014
發出日期
DATE OF ISSUE

圖則名稱
DRAWING TITLE
鐵路條例(第519章)
SOUTH ISLAND LINE (EAST)
暫時封閉聖神修院附近的行人徑和樓梯
TEMPORARY CLOSURE OF THE FOOTPATH AND STAIRCASE NEAR HOLY SPIRIT SEMINARY

圖號
DRAWING NO.
SILE/G10/0006/3
比例
SCALE
1:1000 (A1)
或如顯示
AS SHOWN

香港特別行政區政府
THE GOVERNMENT OF THE HONG KONG
SPECIAL ADMINISTRATIVE REGION
路政署
HIGHWAYS DEPARTMENT
鐵路拓展處
RAILWAY DEVELOPMENT OFFICE

PLOT NO.: V108 V8 Printer.pht
 PRINTED BY: wilsonwc 27/05/2014 14:25:50
 FILENAME: x:\tms\shp\p000\010\road_closur@rev1\rev1.c:\signed\web\SILE-G10-0006-3.dgn