

圖例 LEGEND

- 方案界線 BOUNDARY OF THE SCHEME
擬建的車站及其他鐵路設施 PROPOSED STATION AND OTHER RAILWAY FACILITIES
擬建的車站及其他鐵路設施(地下) PROPOSED STATION AND OTHER RAILWAY FACILITIES (UNDERGROUND)
擬採用鑽挖或掘鑽的鐵路設施或隧道(地下) PROPOSED RAILWAY FACILITIES/TUNNEL BY BORED / MINED / DRILL AND BLAST METHOD (UNDERGROUND)
擬採用明挖回填法興建的鐵路設施或隧道(地下) PROPOSED RAILWAY FACILITIES/TUNNEL BY CUT-AND-COVER METHOD (UNDERGROUND)
可能永久封閉的道路(包括行車道和行人徑) ROADS (INCLUDING CARRIAGEWAY AND FOOTPATH) WHICH MAY BE CLOSED PERMANENTLY
擬建的鐵路高架橋 PROPOSED RAILWAY VIADUCT
現有的行人天橋將受影響 EXISTING FOOTBRIDGE TO BE AFFECTED
擬建的臨時行人天橋/地面行人過路處 PROPOSED TEMPORARY FOOTBRIDGE / AT-GRADE PEDESTRIAN CROSSING
擬建的行人天橋 PROPOSED FOOTBRIDGE

- 可能在其上進行填海工程或其他工程的地帶或填海工程或填海工程或其他工程的地帶 GOVERNMENT FILLING OR SEABED OVER OR UPON WHICH RECLAMATION OR OTHER WORKS MAY BE CARRIED OUT
現有的車站及其他鐵路設施 EXISTING STATION AND OTHER RAILWAY FACILITIES
擬建的臨時架空輸送帶系統 PROPOSED TEMPORARY OVERHEAD CONVEYANCE SYSTEM
擬建的鐵路隧道入口 PROPOSED RAILWAY TUNNEL APPROACH
以主水平基準為依據之擬建路軌大約水平(米) PROPOSED APPROXIMATE TRACK LEVEL IN m P.D.
圖則修改 DRAWING REVISION
修訂參考編號(參考憲報公告) AMENDMENT REFERENCE NUMBER (SEE GAZETTE NOTICE)
修訂範圍 AMENDMENT AREA

說明 NOTES

此圖根據第 SILE-G10 號 (修改) 圖則訂制, 分別以淺綠色、淺藍色和黃色標明將暫時封閉的部分黃竹坑道、香葉道和觀海徑路段。
THIS DRAWING IS PREPARED BASED ON DRAWING NO. SILE-G10 (REVISION 1) AND IS INTENDED TO SHOW THE TEMPORARY PARTIAL CLOSURE OF SECTIONS OF WONG CHUK HANG ROAD, HEUNG YIP ROAD AND KWUN HOI PATH (HIGHLIGHTED IN LIGHT GREEN, LIGHT BLUE AND YELLOW RESPECTIVELY).

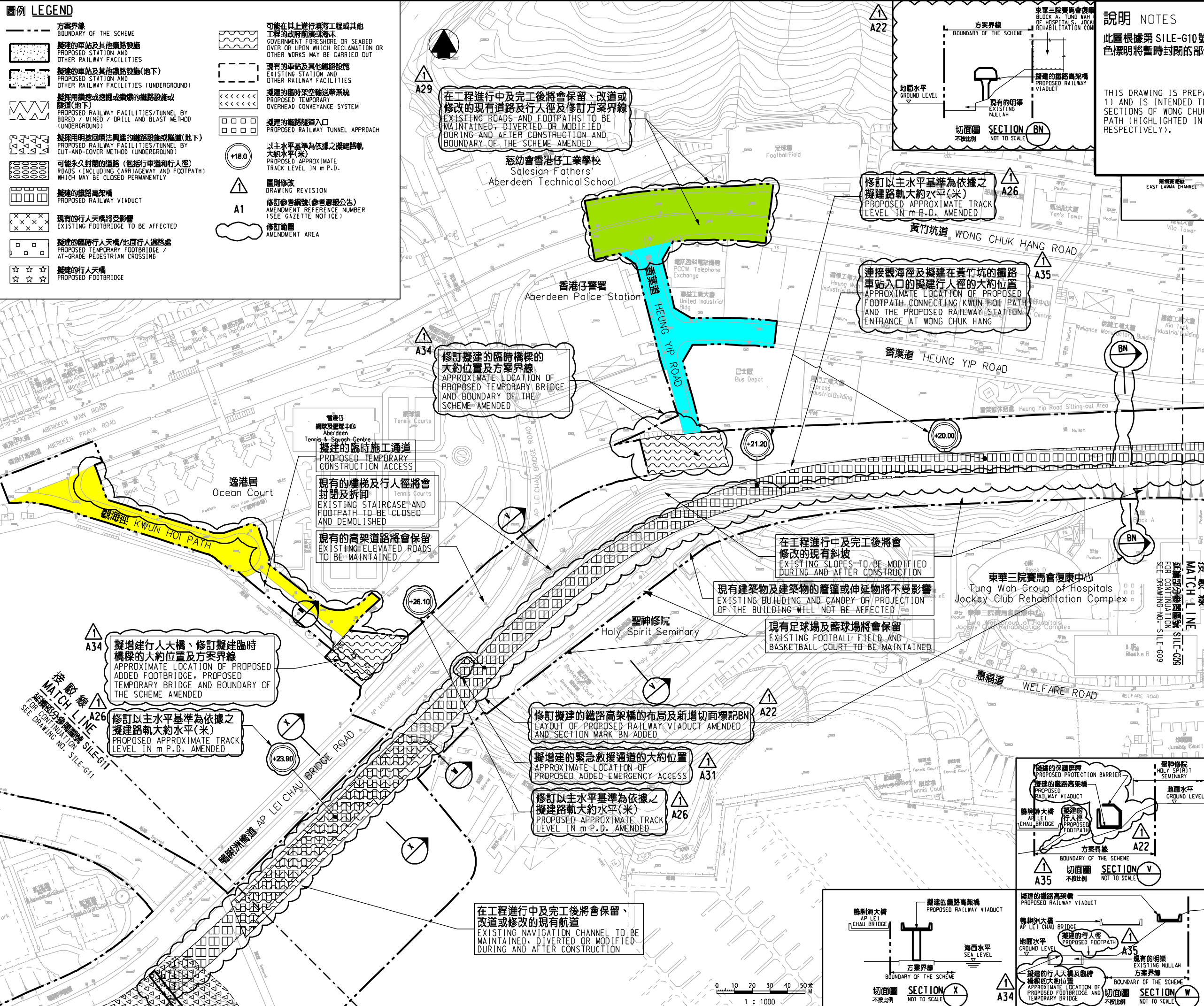

在工程進行中及完工後將會保留、改道或修改的現有道路及行人徑及修訂方案界線 EXISTING ROADS AND FOOTPATHS TO BE MAINTAINED, DIVERTED OR MODIFIED DURING AND AFTER CONSTRUCTION AND BOUNDARY OF THE SCHEME AMENDED

修訂擬建的臨時橋樑的大約位置及方案界線 APPROXIMATE LOCATION OF PROPOSED TEMPORARY BRIDGE AND BOUNDARY OF THE SCHEME AMENDED

擬建的臨時施工通道 PROPOSED TEMPORARY CONSTRUCTION ACCESS
現有的樓梯及行人徑將會封閉及拆卸 EXISTING STAIRCASE AND FOOTPATH TO BE CLOSED AND DEMOLISHED
現有的高架道路將會保留 EXISTING ELEVATED ROADS TO BE MAINTAINED

擬增建行人天橋、修訂擬建臨時橋樑的大約位置及方案界線 APPROXIMATE LOCATION OF PROPOSED ADDED FOOTBRIDGE, PROPOSED TEMPORARY BRIDGE AND BOUNDARY OF THE SCHEME AMENDED

修訂以主水平基準為依據之擬建路軌大約水平(米) PROPOSED APPROXIMATE TRACK LEVEL IN m P.D. AMENDED

修訂擬建的鐵路高架橋的布局及新增切面標記 BN LAYOUT OF PROPOSED RAILWAY VIADUCT AMENDED AND SECTION MARK BN ADDED

擬增建的緊急救援通道的大約位置 APPROXIMATE LOCATION OF PROPOSED ADDED EMERGENCY ACCESS

修訂以主水平基準為依據之擬建路軌大約水平(米) PROPOSED APPROXIMATE TRACK LEVEL IN m P.D. AMENDED

在工程進行中及完工後將會保留、改道或修改的現有航運 EXISTING NAVIGATION CHANNEL TO BE MAINTAINED, DIVERTED OR MODIFIED DURING AND AFTER CONSTRUCTION

在工程進行中及完工後將會修改的現有斜坡 EXISTING SLOPES TO BE MODIFIED DURING AND AFTER CONSTRUCTION

現有建築物及建築物的簷篷或伸延物將不受影響 EXISTING BUILDING AND CANOPY OR PROJECTION OF THE BUILDING WILL NOT BE AFFECTED

現有足球場及籃球場將會保留 EXISTING FOOTBALL FIELD AND BASKETBALL COURT TO BE MAINTAINED

修訂以主水平基準為依據之擬建路軌大約水平(米) PROPOSED APPROXIMATE TRACK LEVEL IN m P.D. AMENDED

連接觀海徑及擬建在黃竹坑的鐵路車站入口的擬建行人徑的大約位置 APPROXIMATE LOCATION OF PROPOSED FOOTPATH, CONNECTING KWUN HOI PATH AND THE PROPOSED RAILWAY STATION ENTRANCE AT WONG CHUK HANG

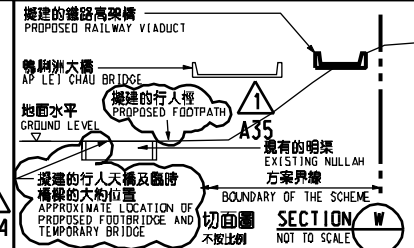
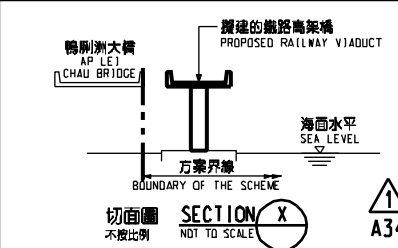
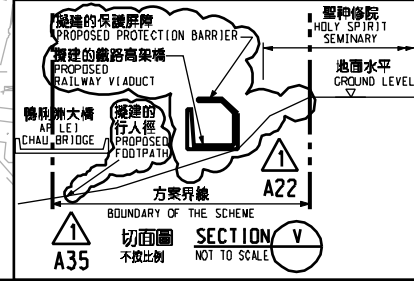

Table with columns for Date, By, Sub, App, Description. Includes 'SIGNED' section with name and date 13/5/2016.

鐵路條例(第519章) 南港島線(東段) 暫時封閉黃竹坑道、香葉道和觀海徑路段
RAILWAYS ORDINANCE (CHAPTER 519) SOUTH ISLAND LINE (EAST) TEMPORARY CLOSURE OF SECTIONS OF WONG CHUK HANG ROAD, HEUNG YIP ROAD AND KWUN HOI PATH

香港特別行政區政府 THE GOVERNMENT OF THE HONG KONG SPECIAL ADMINISTRATIVE REGION
路政署 HIGHWAYS DEPARTMENT
鐵路拓展處 RAILWAY DEVELOPMENT OFFICE

Plot No. 118, 17/05/2016, 09:55:28, x:\london\p000\p01\road_closures\rev1\er_e_signed\websile-co-0001-5.dgn