

圖例 LEGEND

- 方案界線 BOUNDARY OF THE SCHEME
擬建的車站及其他鐵路設施 PROPOSED STATION AND OTHER RAILWAY FACILITIES
擬建的車站及其他鐵路設施(地下) PROPOSED STATION AND OTHER RAILWAY FACILITIES (UNDERGROUND)
擬採用鑽挖或掘鑽的鐵路設施或隧道(地下) PROPOSED RAILWAY FACILITIES/TUNNEL BY BORED / MINED / DRILL AND BLAST METHOD (UNDERGROUND)
擬採用明挖回填法興建的鐵路設施或隧道(地下) PROPOSED RAILWAY FACILITIES/TUNNEL BY CUT-AND-COVER METHOD (UNDERGROUND)
可能永久封閉的道路(包括行人道和行人徑) WHICH MAY BE CLOSED PERMANENTLY
擬建的鐵路高架橋 PROPOSED RAILWAY VIADUCT
現有的行人天橋將受影響 EXISTING FOOTBRIDGE TO BE AFFECTED
擬建的臨時行人天橋/地面行人過路處 AT-GRADE PEDESTRIAN CROSSING / PROPOSED TEMPORARY FOOTBRIDGE
擬建的行人天橋 PROPOSED FOOTBRIDGE

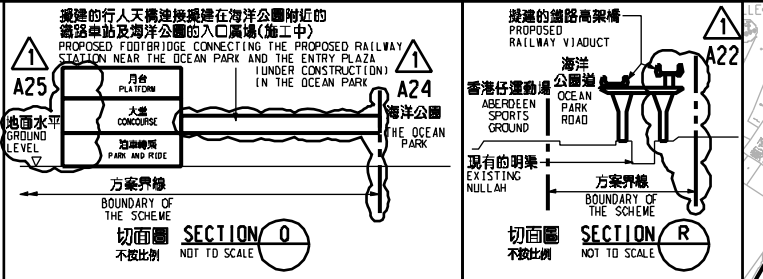

說明 NOTES
此圖根據第 SILE-G08 號(修改)圖則制訂,以黃色標明將永久封閉香港仔隧道引道與黃竹坑道至香港仔隧道的支路交界處附近的部分行人路...

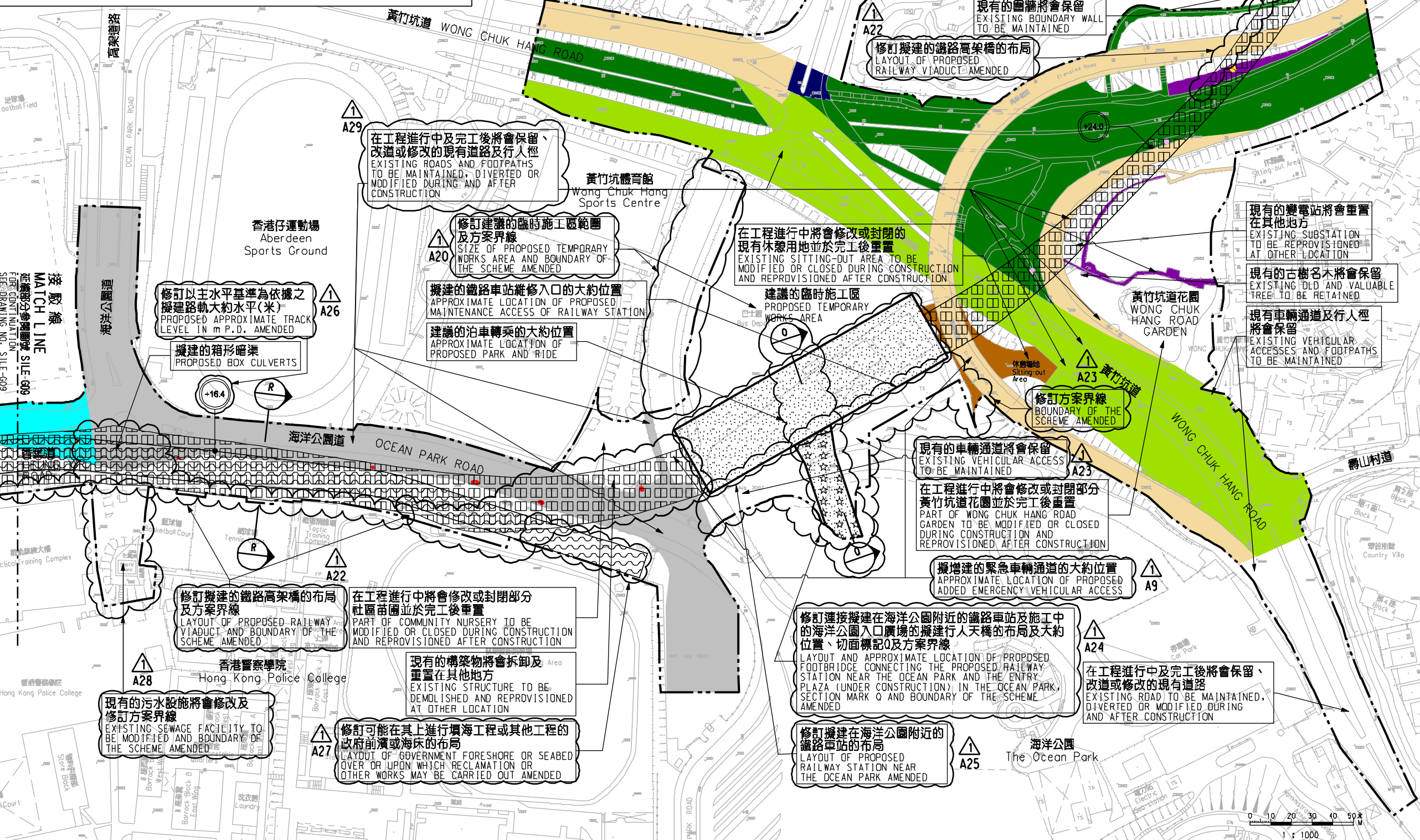

一般說明 GENERAL NOTES
1. 有關一般說明參閱圖號 SILE - G01. FOR GENERAL NOTES, REFER TO DRAWING NO. SILE - G01.

Table with 5 columns: REV, DATE, BY, SUB, APP, DESCRIPTION. It is currently empty.

SIGNED
YUEN MOU KOK, ANTHONY
13/5/2016
HIGHWAYS DEPARTMENT

鐵路條例(第519章)
南港島綫(東段)
SOUTH ISLAND LINE (EAST)
RAILWAY DEVELOPMENT OFFICE

香港特別行政區政府 THE GOVERNMENT OF THE HONG KONG SPECIAL ADMINISTRATIVE REGION
路政署 HIGHWAYS DEPARTMENT
鐵路拓展處 RAILWAY DEVELOPMENT OFFICE

Plot No.: 118, Date: 17/05/2016, File Name: x:\ton\an\p00\p01\tr\ood_closur\view\VER E_SIGNED\WEB\SILE-G08-0003-5.dgn