

一般說明 GENERAL NOTES

- 有關一般說明參閱圖號 SCL-G01。
FOR GENERAL NOTES, REFER TO DRAWING NO. SCL-G01.
- 收回地層的細節在圖則第SCL-U08號顯示。
DETAILS OF UNDERGROUND STRATA RESUMPTION ARE SHOWN IN DRAWING NOS. SCL-U08.
- 收回的地層在圖則第SCL-U01至SCL-U07號中以參線的切面立視圖顯示。
UNDERGROUND STRATA TO BE RESUMED ARE SHOWN IN THE SECTIONAL ELEVATION ALONG THE REFERENCE LINE IN DRAWING NOS. SCL-U01 TO SCL-U07.
- 沿參線的切面立視圖顯示的正/負主水平基準均為約數。
THE +/- mPDs SHOWN IN THE SECTIONAL ELEVATION ALONG REFERENCE LINE ARE APPROXIMATE.
- 圖則顯示於可被收回的地層的任何現有公用設施將不會被收回。
ANY EXISTING UTILITIES LOCATED WITHIN THE UNDERGROUND STRATA PROPOSED TO BE RESUMED WILL NOT BE RESUMED.

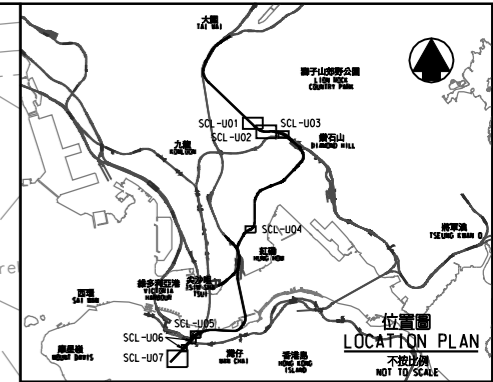
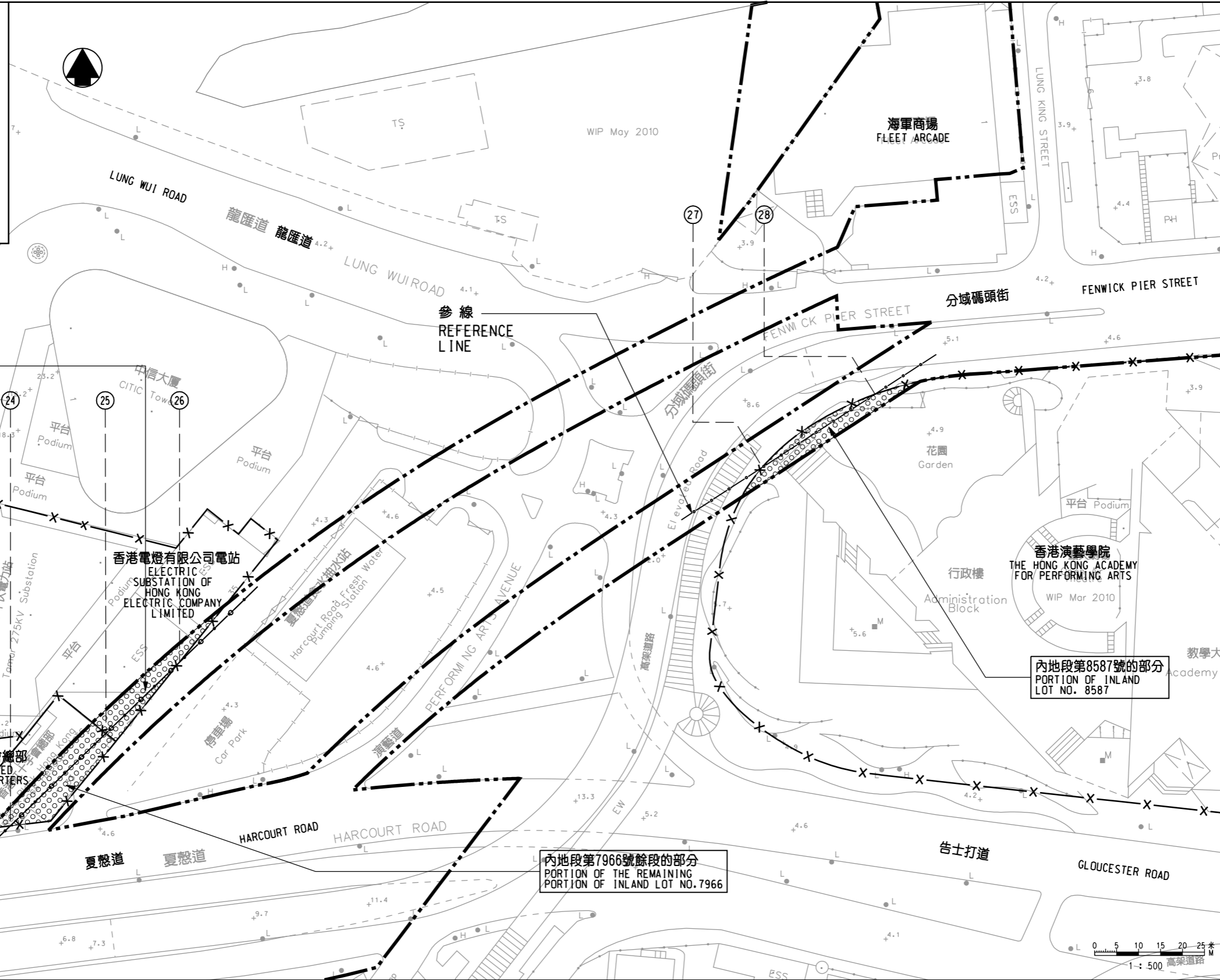

圖例 LEGEND

- 方案界線
BOUNDARY OF THE SCHEME
- 可被收回的地層
UNDERGROUND STRATA PROPOSED TO BE RESUMED
- 可被收回的地層 (在該地層內的任何現有柱及地基將不會被收回)
UNDERGROUND STRATA PROPOSED TO BE RESUMED (ANY EXISTING PILES AND FOUNDATIONS LOCATED WITHIN SUCH STRATA WILL NOT BE RESUMED)
- 擬建的鐵路車站及其他鐵路設施(地下)
PROPOSED RAILWAY STATION AND OTHER RAILWAY FACILITIES (UNDERGROUND)
- 擬建的車站/車站入口/通風大樓/通風井/其他鐵路設施或永久建築物
PROPOSED RAILWAY STATION/STATION ENTRANCES/VENTILATION BUILDINGS/VENTILATION SHAFTS/OTHER RAILWAY FACILITIES OR PERMANENT STRUCTURES
- 地段界線
LOT BOUNDARY
- 參線標記
REFERENCE LINE MARK
- 參線
REFERENCE LINE

修訂表 TABLE OF AMENDMENTS

| 修訂 | 日期 | 繪圖 | 類別 | 負責 | 說明 |
|-----|------|----|-----|-----|-------------|
| REV | DATE | BY | SUB | APP | DESCRIPTION |
| | | | | | |

SIGNED
伍德榮 NG TAK WING
核准發出
APPROVED FOR ISSUE
鐵路署
鐵路拓展處處長(1)
GOVERNMENT ENGINEER/
RAILWAY DEVELOPMENT (1)
HIGHWAYS DEPARTMENT
10 NOV 2010
發出日期 DATE OF ISSUE

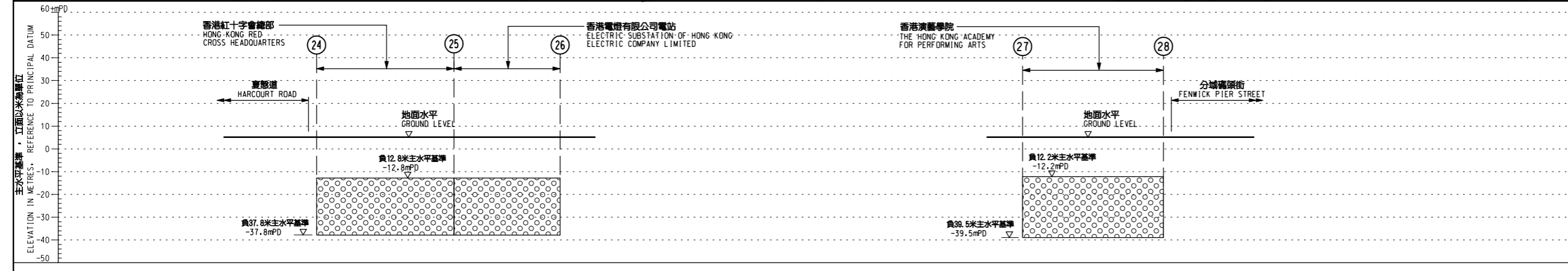

沿參線的切面立視圖 SECTIONAL ELEVATION ALONG REFERENCE LINE

圖則名稱 DRAWING TITLE
**鐵路條例(第519章)
沙田至中環線
收回地層圖則
8頁的第5頁**
RAILWAYS ORDINANCE (CHAPTER 519)
SHATIN TO CENTRAL LINK
UNDERGROUND STRATA RESUMPTION PLAN
SHEET 5 OF 8

圖號 DRAWING NO. SCL-U05 比例 SCALE 1:500 (A1) 或如顯示 AS SHOWN

香港特別行政區政府
THE GOVERNMENT OF THE HONG KONG
SPECIAL ADMINISTRATIVE REGION
路政署
HIGHWAYS DEPARTMENT
鐵路拓展處
RAILWAY DEVELOPMENT OFFICE

不按比例 NOT TO SCALE