

DRAWING NO. SCL-G36

WP Nov 2010

WP Nov 2010

WP Nov 2010

WP Nov 2010

WP Nov 2010

WP Nov 2010

WP Nov 2010

WP Nov 2010

WP Nov 2010

WP Nov 2010

WP Nov 2010

WP Nov 2010

WP Nov 2010

WP Nov 2010

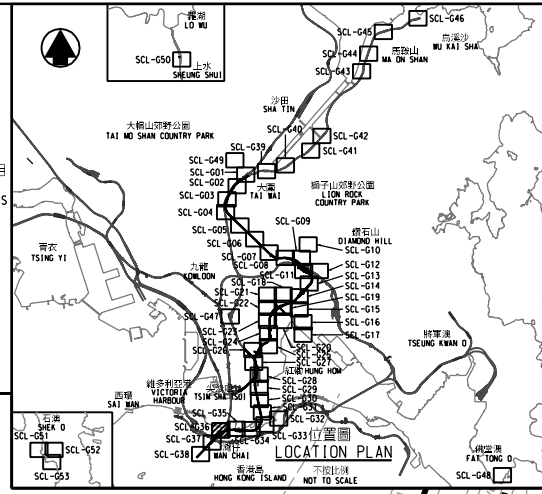
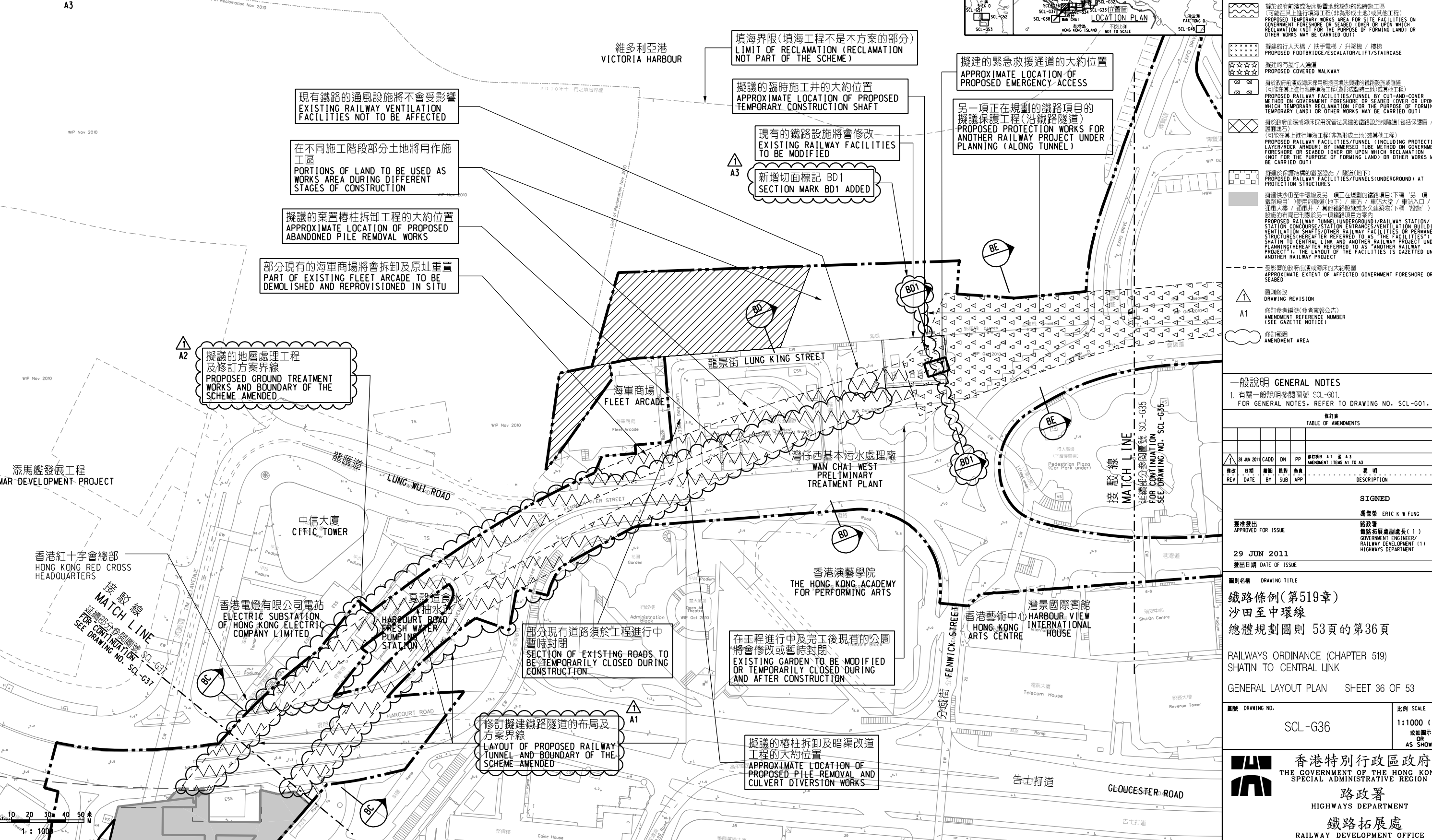
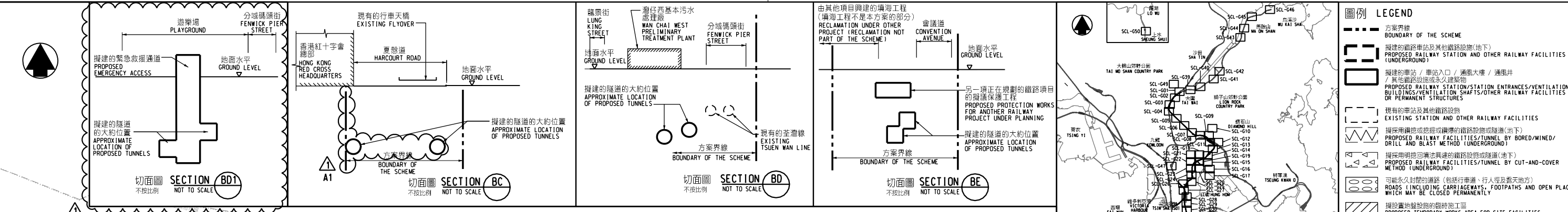

圖例 LEGEND

- 方格界線 BOUNDARY OF THE SCHEME
- 擬建的鐵路車站及其他鐵路設施(地下) PROPOSED RAILWAY STATION AND OTHER RAILWAY FACILITIES (UNDERGROUND)
- 擬建的車站 / 車站入口 / 通風大樓 / 通風井 及其他鐵路設施或永久建築物 PROPOSED RAILWAY STATION/STATION ENTRANCES/VENTILATION BUILDINGS/VENTILATION SHAFTS/OTHER RAILWAY FACILITIES OR PERMANENT STRUCTURES
- 現有的車站及其他鐵路設施 EXISTING STATION AND OTHER RAILWAY FACILITIES
- 擬採用鑽挖或掘鑽的鐵路設施或隧道(地下) PROPOSED RAILWAY FACILITIES/TUNNEL BY BORED/MINED/DRILL AND BLAST METHOD (UNDERGROUND)
- 擬採用明挖法興建的鐵路設施或隧道(地下) PROPOSED RAILWAY FACILITIES/TUNNEL BY CUT-AND-COVER METHOD (UNDERGROUND)
- 可能永久封閉的道路 (包括行人道、行人徑及露天地方) WHICH MAY BE CLOSED PERMANENTLY
- 擬設置地盤設施的臨時施工區 PROPOSED TEMPORARY WORKS AREA FOR SITE FACILITIES
- 擬於政府填海或海床採用明挖法興建的鐵路設施或隧道 (可能在其上進行填海工程(非為形成土地)或其他工程) PROPOSED RAILWAY FACILITIES/TUNNEL BY CUT-AND-COVER METHOD ON GOVERNMENT FORESHORE OR SEABED (OVER OR UPON WHICH RECLAMATION (NOT FOR THE PURPOSE OF FORMING LAND) OR OTHER WORKS MAY BE CARRIED OUT)
- 擬於政府填海或海床採用沉箱法興建的鐵路設施或隧道 (包括保護層 / 護層護石) PROPOSED RAILWAY FACILITIES/TUNNEL (INCLUDING PROTECTION LAYER/ROCK ARMOUR) BY IMMERSED TUBE METHOD ON GOVERNMENT FORESHORE OR SEABED (OVER OR UPON WHICH RECLAMATION (NOT FOR THE PURPOSE OF FORMING LAND) OR OTHER WORKS MAY BE CARRIED OUT)
- 擬建的行人天橋 / 扶手電梯 / 升降機 / 樓梯 PROPOSED FOOTBRIDGE/ESCALATOR/LIFT/STAIRCASE
- 擬建的有蓋行人通道 PROPOSED COVERED WALKWAY
- 擬於政府填海或海床採用明挖法興建的鐵路設施或隧道 (可能在其上進行填海工程(非為形成土地)或其他工程) PROPOSED RAILWAY FACILITIES/TUNNEL BY CUT-AND-COVER METHOD ON GOVERNMENT FORESHORE OR SEABED (OVER OR UPON WHICH RECLAMATION (NOT FOR THE PURPOSE OF FORMING LAND) OR OTHER WORKS MAY BE CARRIED OUT)
- 擬於政府填海或海床採用沉箱法興建的鐵路設施或隧道 (包括保護層 / 護層護石) PROPOSED RAILWAY FACILITIES/TUNNEL (INCLUDING PROTECTION LAYER/ROCK ARMOUR) BY IMMERSED TUBE METHOD ON GOVERNMENT FORESHORE OR SEABED (OVER OR UPON WHICH RECLAMATION (NOT FOR THE PURPOSE OF FORMING LAND) OR OTHER WORKS MAY BE CARRIED OUT)
- 擬建的臨時施工區 PROPOSED TEMPORARY WORKS AREA FOR SITE FACILITIES
- 擬建的鐵路車站及其他鐵路設施(地下) PROPOSED RAILWAY STATION/STATION ENTRANCES/VENTILATION BUILDINGS/VENTILATION SHAFTS/OTHER RAILWAY FACILITIES OR PERMANENT STRUCTURES (HEREINAFTER REFERRED TO AS "THE FACILITIES") FOR SHATIN TO CENTRAL LINK AND ANOTHER RAILWAY PROJECT UNDER PLANNING (HEREINAFTER REFERRED TO AS "ANOTHER RAILWAY PROJECT"). THE LAYOUT OF THE FACILITIES IS GAZETTED UNDER ANOTHER RAILWAY PROJECT.
- 一受影響的政府前濱或海床的大約範圍 APPROXIMATE EXTENT OF AFFECTED GOVERNMENT FORESHORE OR SEABED
- 圖則修改 DRAWING REVISION
- A1 修訂參考編號(參考憲報公告) AMENDMENT REFERENCE NUMBER (SEE GAZETTE NOTICE)
- 修訂範圍 AMENDMENT AREA

一般說明 GENERAL NOTES

- 有關一般說明參閱圖號 SCL-G01. FOR GENERAL NOTES, REFER TO DRAWING NO. SCL-G01.

修訂表 TABLE OF AMENDMENTS

修訂	日期	繪圖	類別	內容	說明	
REV	DATE	DRAWN	BY	SUB	APP	DESCRIPTION
28 JUN 2011	CADD	DN	PP	修訂圖號 A1 至 A3	AMENDMENT ITEMS A1 TO A3	

簽署: 馮傑榮 ERIC K W FUNG
 批准發出 APPROVED FOR ISSUE
 鐵路拓展處處長(1)
 GOVERNMENT ENGINEER/RAILWAY DEVELOPMENT (1)
 HIGHWAYS DEPARTMENT
 29 JUN 2011
 發出日期 DATE OF ISSUE

圖則名稱 DRAWING TITLE

鐵路條例(第519章)
 沙田至中環線
 總體規劃圖則 53頁的第36頁
 RAILWAYS ORDINANCE (CHAPTER 519)
 SHATIN TO CENTRAL LINK
 GENERAL LAYOUT PLAN SHEET 36 OF 53

圖號 DRAWING NO. SCL-G36
 比例 SCALE 1:1000 (A1)
 或如圖示 OR AS SHOWN

香港特別行政區政府
 THE GOVERNMENT OF THE HONG KONG SPECIAL ADMINISTRATIVE REGION
 路政署
 HIGHWAYS DEPARTMENT
 鐵路拓展處
 RAILWAY DEVELOPMENT OFFICE