

說明 NOTES

此圖根據第 SCL-G12 號圖則訂制，以綠色標明將暫時封閉的部分龍翔道路段。

THIS DRAWING IS PREPARED BASED ON DRAWING NO. SCL-G12 AND IS INTENDED TO SHOW THE TEMPORARY PARTIAL CLOSURE OF THE SECTION OF LUNG CHEUNG ROAD (HIGHLIGHTED IN GREEN).

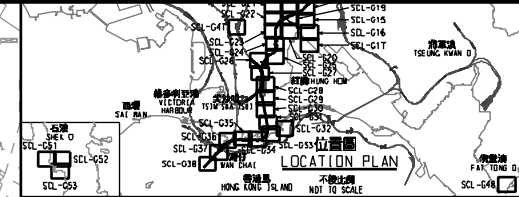

圖例 LEGEND

- 方案界線 (BOUNDARY OF THE SCHEME)
擬建的鐵路車站及其他鐵路設施(地下) (PROPOSED RAILWAY STATION/STATION ENTRANCES/VENTILATION BUILDINGS/OTHER RAILWAY FACILITIES UNDERGROUND)
擬建的車站 / 車站入口 / 通風大樓 / 通風井 / 其他鐵路設施或永久建築物 (PROPOSED RAILWAY STATION/STATION ENTRANCES/VENTILATION BUILDINGS/OTHER RAILWAY FACILITIES OR PERMANENT STRUCTURES)
現有的車站及其他鐵路設施 (EXISTING STATION AND OTHER RAILWAY FACILITIES)
擬採用鑽挖或掘埋的鐵路設施(地下) (PROPOSED RAILWAY FACILITIES/TUNNEL BY BORED/WINED/DRILL AND BLAST METHOD UNDERGROUND)
擬採用明挖法埋設的鐵路設施(地下) (PROPOSED RAILWAY FACILITIES/TUNNEL BY CUT-AND-COVER METHOD UNDERGROUND)
可能永久封閉的道路(包括行車道、行人徑及露天地方) WHICH MAY BE CLOSED PERMANENTLY
擬設置地盤的臨時工程區 (PROPOSED TEMPORARY WORKS AREA FOR SITE FACILITIES)
擬於政府前濱或海床設置地盤的臨時工程區 (PROPOSED TEMPORARY WORKS AREA FOR SITE FACILITIES ON GOVERNMENT FORESHORE OR SEA BED)
擬建的行人天橋 / 扶手電梯 / 升降機 / 樓梯 (PROPOSED FOOTBRIDGE/ESCALATOR/LIFT/STAIRCASE)
擬建的有蓋行人道 (PROPOSED COVERED WALKWAY)
擬於政府前濱或海床採用明挖法埋設的鐵路設施(地下) (PROPOSED RAILWAY FACILITIES/TUNNEL BY CUT-AND-COVER METHOD ON GOVERNMENT FORESHORE OR SEA BED)
擬於政府前濱或海床採用掘埋法埋設的鐵路設施(地下) (PROPOSED RAILWAY FACILITIES/TUNNEL BY BORED/WINED/DRILL AND BLAST METHOD ON GOVERNMENT FORESHORE OR SEA BED)
擬建的保護結構(地下) (PROPOSED RAILWAY FACILITIES/TUNNEL UNDERGROUND) AT PROTECTION STRUCTURES
擬在沙田中環及另一項正在發展的鐵路項目(下列「另一項鐵路項目」)的範圍(地下) / 車站 / 車站大堂 / 車站入口 / 車站大樓 / 其他鐵路設施或永久建築物(下列「鐵路設施」) / 鐵路設施的永久封閉(下列「鐵路設施永久封閉」) (PROPOSED RAILWAY TUNNEL UNDERGROUND / RAILWAY STATION / STATION CONCOURSE / STATION ENTRANCES / VENTILATION BUILDINGS / VENTILATION SHAFTS / OTHER RAILWAY FACILITIES OR PERMANENT STRUCTURES (HEREINAFTER REFERRED TO AS "THE FACILITIES") FOR SHATTIN CENTRAL LINK AND ANOTHER RAILWAY PROJECT UNDER PLANNING (HEREINAFTER REFERRED TO AS "ANOTHER RAILWAY PROJECT"). THE LAYOUT OF THE FACILITIES IS GAZETTED UNDER ANOTHER RAILWAY PROJECT.)
受影響的政府前濱或海床的大約範圍 (APPROXIMATE EXTENT OF AFFECTED GOVERNMENT FORESHORE OR SEA BED)

一般說明 GENERAL NOTES
1. 有關一般說明參閱圖號 SCL-G01. FOR GENERAL NOTES, REFER TO DRAWING NO. SCL-G01.

Table with 5 columns: REV, DATE, BY, SUB, APP, DESCRIPTION. Includes a row for 'SIGNED' and 'APPROVED FOR ISSUE'.

SIGNED
ANTHONY YUEN
CHIEF ENGINEER / RAILWAY DEVELOPMENT (1-3)
HIGHWAYS DEPARTMENT
8/3/2018

圖則名稱 DRAWING TITLE
鐵路條例(第519章)
沙田至中環線
暫時封閉龍翔道路

RAILWAYS ORDINANCE (CHAPTER 519)
SHATTIN TO CENTRAL LINK
TEMPORARY CLOSURE OF A SECTION OF
LUNG CHEUNG ROAD

圖號 DRAWING NO. SCL/G12/0016/6
比例 SCALE 1:1000 (A1)
或部顯示 OR AS SHOWN

香港特別行政區政府
THE GOVERNMENT OF THE HONG KONG
SPECIAL ADMINISTRATIVE REGION
路政署
HIGHWAYS DEPARTMENT
鐵路拓展處
RAILWAY DEVELOPMENT OFFICE

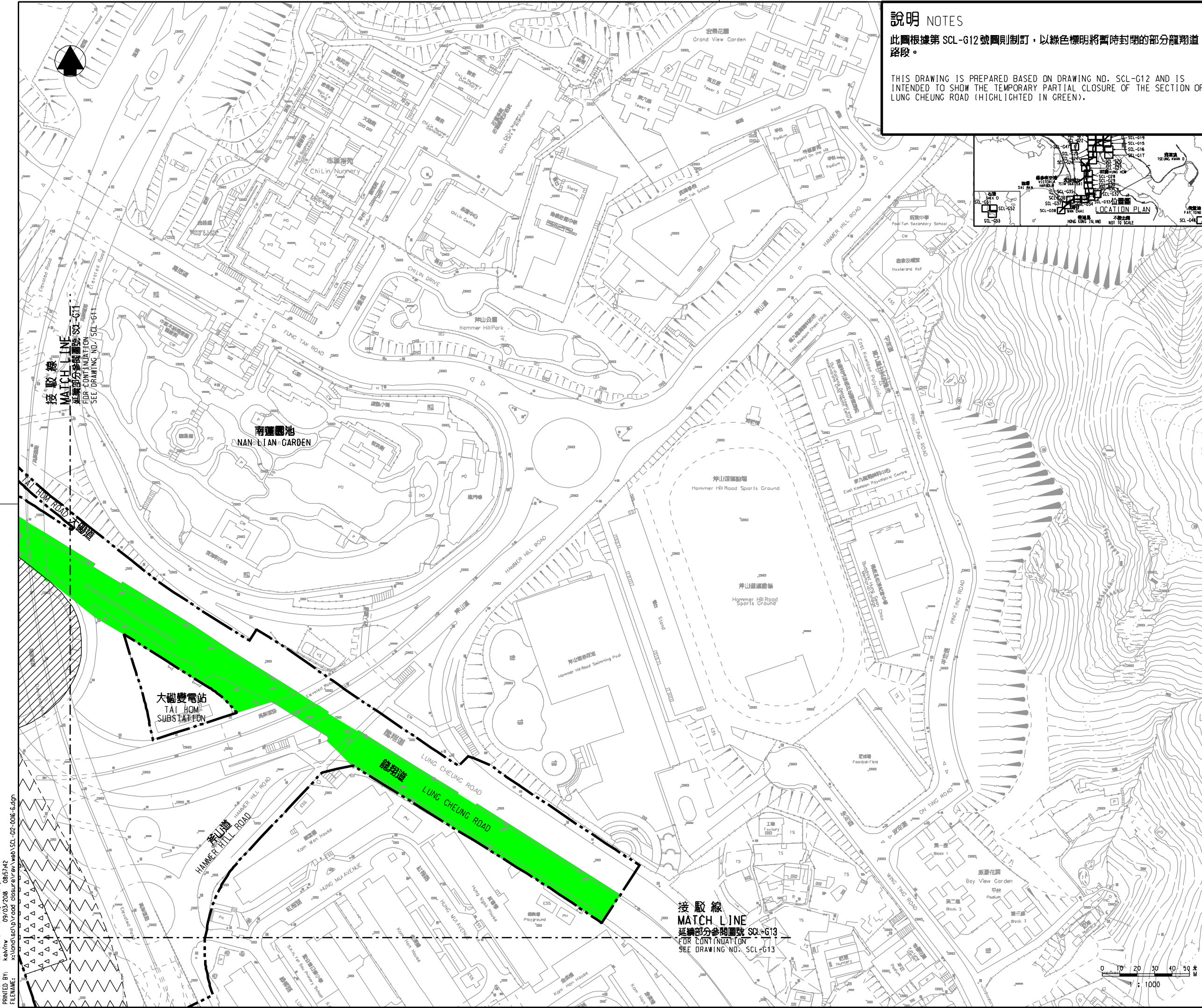

Plot title and drawing information on the left margin.

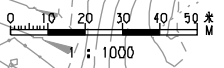

接駁線 MATCH LINE
FOR CONTINUATION SEE DRAWING NO. SCL-G13

接駁線 MATCH LINE
FOR CONTINUATION SEE DRAWING NO. SCL-G11