

說明 NOTES

此圖根據第 SCL-G37 號 (修改1) 圖則制訂, 以紫色標明將暫時封閉的部分香港公園, 及以粉紅色標明將暫時封閉的部分法院道路段。
THIS DRAWING IS PREPARED BASED ON DRAWING NO. SCL-G37 (REVISION 1) AND IS INTENDED TO SHOW THE TEMPORARY CLOSURE OF PART OF HONG KONG PARK (HIGHLIGHTED IN PURPLE), AND THE TEMPORARY PARTIAL CLOSURE OF THE SECTION OF SUPREME COURT ROAD (HIGHLIGHTED IN PINK).

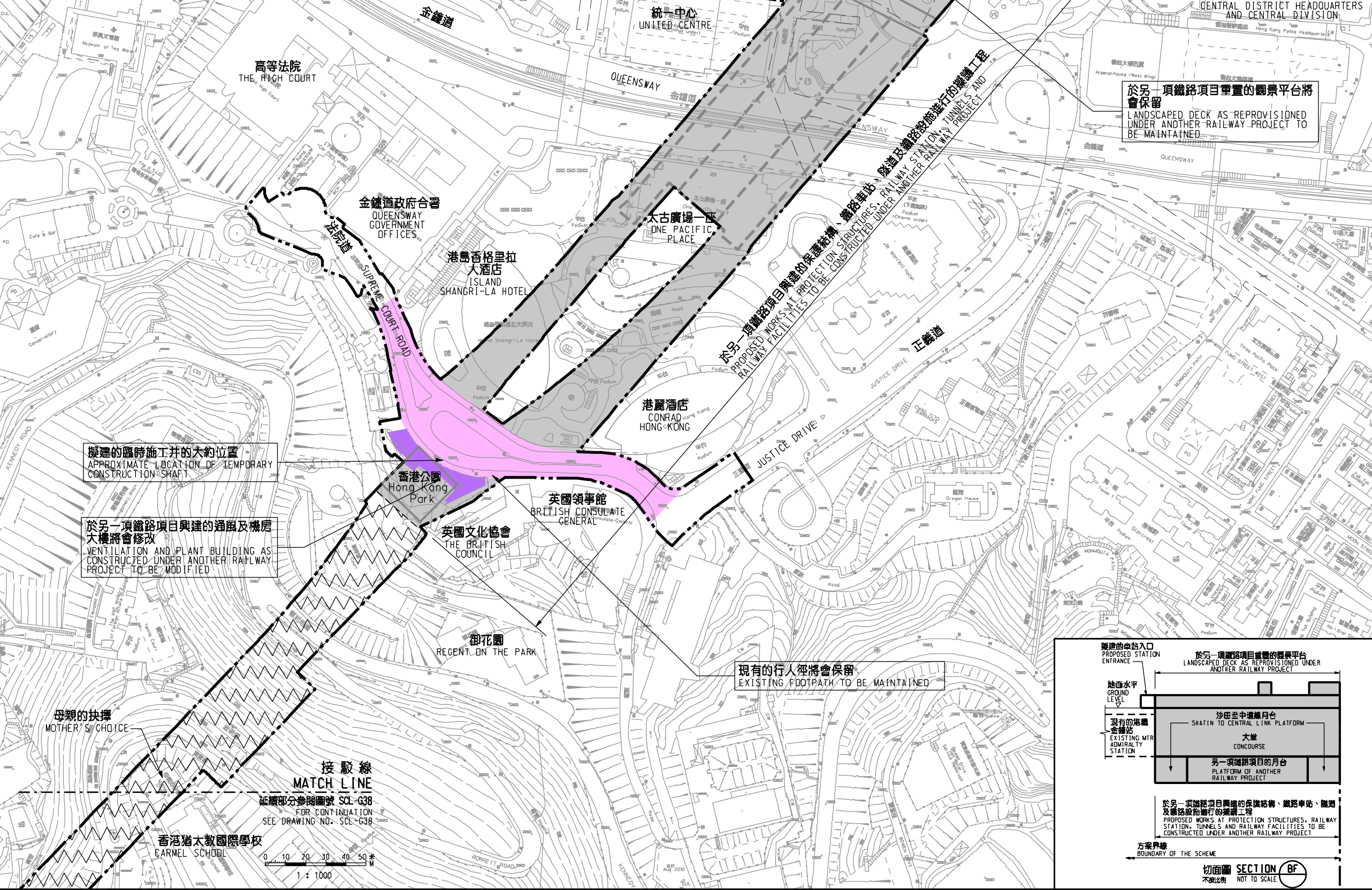
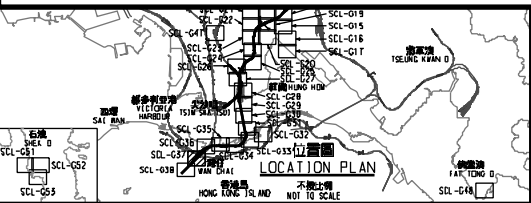

修訂擬建鐵路隧道的布局及方案界線
LAYOUT OF PROPOSED RAILWAY TUNNEL AND BOUNDARY OF THE SCHEME AMENDED

現有的鐵路設施將會拆卸
EXISTING RAILWAY FACILITIES TO BE DEMOLISHED

擬建車站入口的大約位置
APPROXIMATE LOCATION OF PROPOSED STATION ENTRANCE

金鐘停車場(地下)
ADMIRALTY CAR PARK (UNDERGROUND)

香港警察總部 中區總部及中區分區
HONG KONG POLICE HEADQUARTERS, CENTRAL DISTRICT HEADQUARTERS AND CENTRAL DIVISION

於另一項鐵路項目重置的園景平台將會保留
LANDSCAPED DECK AS RE-PROVISIONED UNDER ANOTHER RAILWAY PROJECT TO BE MAINTAINED

金鐘道政府合署
QUEENSWAY GOVERNMENT OFFICES

港島香格里拉大酒店
ISLAND SHANGRI-LA HOTEL

太古廣場一樓
ONE PACIFIC PLACE

港麗酒店
CONRAD HONG-KONG

香港公園
Hong Kong Park

英國領事館
BRITISH CONSULATE GENERAL

英國文化協會
THE BRITISH COUNCIL

御花園
REGENT ON THE PARK

現有的行人徑將會保留
EXISTING FOOTPATH TO BE MAINTAINED

母親的抉擇
MOTHER'S CHOICE

香港猶太教國際學校
CARNEL SCHOOL

接駁線
MATCH LINE
延續部分參閱圖號 SCL-G38
FOR CONTINUATION SEE DRAWING NO. SCL-G38

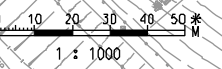

圖例 LEGEND

- 方案界線
BOUNDARY OF THE SCHEME
- 擬建的車站入口及車站設施(地下)
PROPOSED RAILWAY STATION AND OTHER RAILWAY FACILITIES (UNDERGROUND)
- 擬建的車站入口/過路大樓/邊界井/其他鐵路設施或永久建築
PROPOSED RAILWAY STATION/STATION ENTRANCES/VENTILATION BUILDINGS/VENTILATION SHAFTS/OTHER RAILWAY FACILITIES OR PERMANENT STRUCTURES
- 現有的車站及其他鐵路設施
EXISTING STATION AND OTHER RAILWAY FACILITIES
- 擬採用鑽挖或掘削的鐵路設施(地下)
PROPOSED RAILWAY FACILITIES/TUNNEL BY BORED/WINED/DRILL AND BLAST METHOD (UNDERGROUND)
- 擬採用明挖法興建的鐵路設施(地下)
PROPOSED RAILWAY FACILITIES/TUNNEL BY CUT-AND-COVER METHOD (UNDERGROUND)
- 可能永久封閉的道路(包括行車道、行人徑及露天地方) WHICH MAY BE CLOSED PERMANENTLY
- 擬設置地盤的臨時工作區
PROPOSED TEMPORARY WORKS AREA FOR SITE FACILITIES
- 擬於政府前濱或海濱地段興建的臨時工程(可能在其上進行填海工程(非為形成土地)或其他工程)
PROPOSED TEMPORARY WORKS AREA FOR SITE FACILITIES ON GOVERNMENT FORESHORE OR SEABED (OVER OR UPON WHICH RECLAMATION (NOT FOR THE PURPOSE OF FORMING LAND) OR OTHER WORKS MAY BE CARRIED OUT)
- 擬建的行人天橋/扶手电梯/升降機/樓梯
PROPOSED FOOTBRIDGE/ESCALATOR/LIFT/STAIRCASE
- 擬建的有蓋行人道
PROPOSED COVERED WALKWAY
- 擬於政府前濱或海濱地段興建的鐵路設施(包括橋樑/渡輪碼頭)
PROPOSED RAILWAY FACILITIES/TUNNEL (INCLUDING PROTECTION LAYER/PROTECT ARMOUR) BY IMMERSED TUBE METHOD ON GOVERNMENT FORESHORE OR SEABED (OVER OR UPON WHICH RECLAMATION (NOT FOR THE PURPOSE OF FORMING LAND) OR OTHER WORKS MAY BE CARRIED OUT)
- 擬於政府前濱或海濱地段興建的鐵路設施(包括橋樑/渡輪碼頭)
PROPOSED RAILWAY FACILITIES/TUNNEL (INCLUDING PROTECTION LAYER/PROTECT ARMOUR) BY IMMERSED TUBE METHOD ON GOVERNMENT FORESHORE OR SEABED (OVER OR UPON WHICH RECLAMATION (NOT FOR THE PURPOSE OF FORMING LAND) OR OTHER WORKS MAY BE CARRIED OUT)
- 擬建的保護結構的鐵路設施/隧道(地下)
PROPOSED RAILWAY FACILITIES/TUNNELS (UNDERGROUND) AT PROTECTION STRUCTURES
- 擬建快沙中環及另一項正在預備的鐵路項目(下列「另一項鐵路項目」)的園景平台(地下)/車站/車站大堂/車站入口/其他設施(可能於另一項鐵路項目中重置)
PROPOSED RAILWAY TUNNEL (UNDERGROUND)/RAILWAY STATION/STATION CONCOURSE/STATION ENTRANCES/VENTILATION BUILDINGS/VENTILATION SHAFTS/OTHER RAILWAY FACILITIES OR PERMANENT STRUCTURES (HEREAFTER REFERRED TO AS "THE FACILITIES" FOR SHATIN, CENTRAL LINK AND ANOTHER RAILWAY PROJECT UNDER PLANNING (HEREAFTER REFERRED TO AS "ANOTHER RAILWAY PROJECT"). THE LAYOUT OF THE FACILITIES IS GAZETTED UNDER ANOTHER RAILWAY PROJECT.
- 受影響的政府前濱或海濱地段的大約範圍
APPROXIMATE EXTENT OF AFFECTED GOVERNMENT FORESHORE OR SEABED
- 圖則修改
DRAWING REVISION
- A1 修訂參考編號(參閱憲報公告)
AMENDMENT REFERENCE NUMBER (SEE GAZETTE NOTICE)
- 修訂範圍
AMENDMENT AREA

一般說明 GENERAL NOTES
1. 有關一般說明參閱圖號 SCL-G01.
FOR GENERAL NOTES, REFER TO DRAWING NO. SCL-G01.

修訂表
TABLE OF AMENDMENTS

修訂號 REV	日期 DATE	由 BY	核對 CHKD	申請 APP	說明 DESCRIPTION

SIGNED
曹榮平 CHOU WING PING, FRANKIE
總工程師/鐵路發展(1-2)
CHIEF ENGINEER/
RAILWAY DEVELOPMENT (1-2)
HIGHWAYS DEPARTMENT

8/6/2016
發出日期 DATE OF ISSUE

圖則名稱 DRAWING TITLE
鐵路條例(第519章)
沙田至中環線
暫時封閉部分香港公園, 以及法院道
路段
RAILWAYS ORDINANCE (CHAPTER 519)
SHATIN TO CENTRAL LINK
TEMPORARY CLOSURE OF PART OF HONG KONG PARK,
AND A SECTION OF SUPREME COURT ROAD

圖號 DRAWING NO. SCL/G37/0056/1
比例 SCALE 1:1000 (A1)
或顯示
OR AS SHOWN

香港特別行政區政府
THE GOVERNMENT OF THE HONG KONG
SPECIAL ADMINISTRATIVE REGION
路政署
HIGHWAYS DEPARTMENT
鐵路拓展處
RAILWAY DEVELOPMENT OFFICE

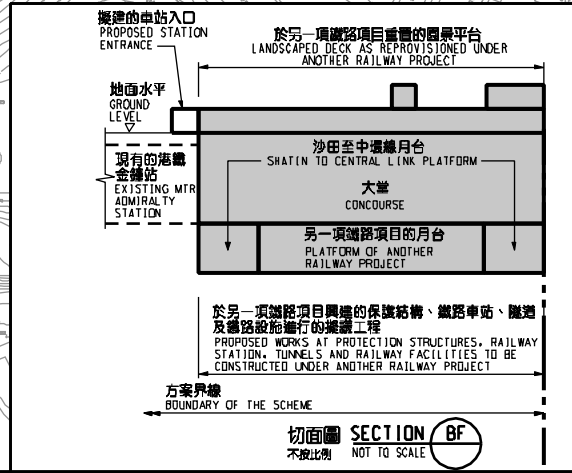

PLOT DRW: E:\lib\Plot\1818\vb\p1818\p1818.plt
 PRINTED BY: ftkk
 FILENAME: X:\Land\SCL\PlRoad\Cosure\Ver1\Web\SCL-G37-0056-1.dwg