

DRAWING NO. KTU-G02

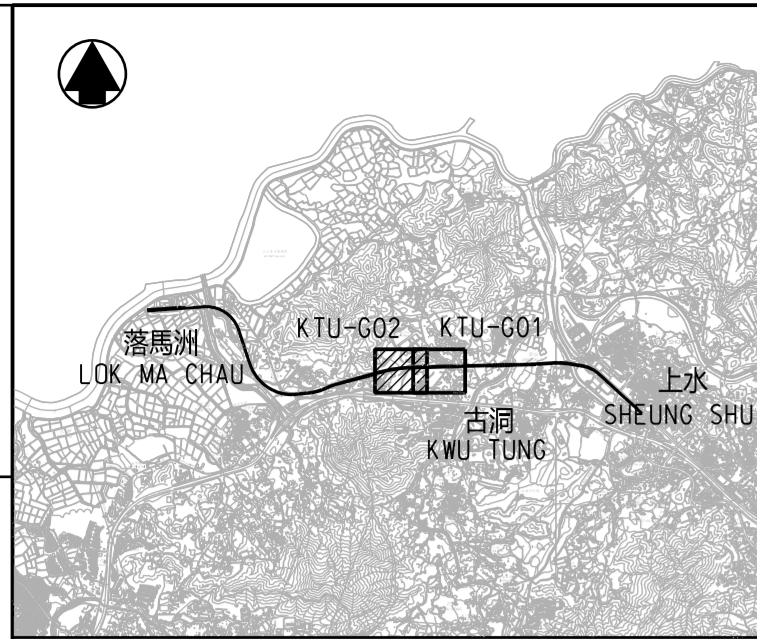

位置圖 LOCATION PLAN NOT TO SCALE

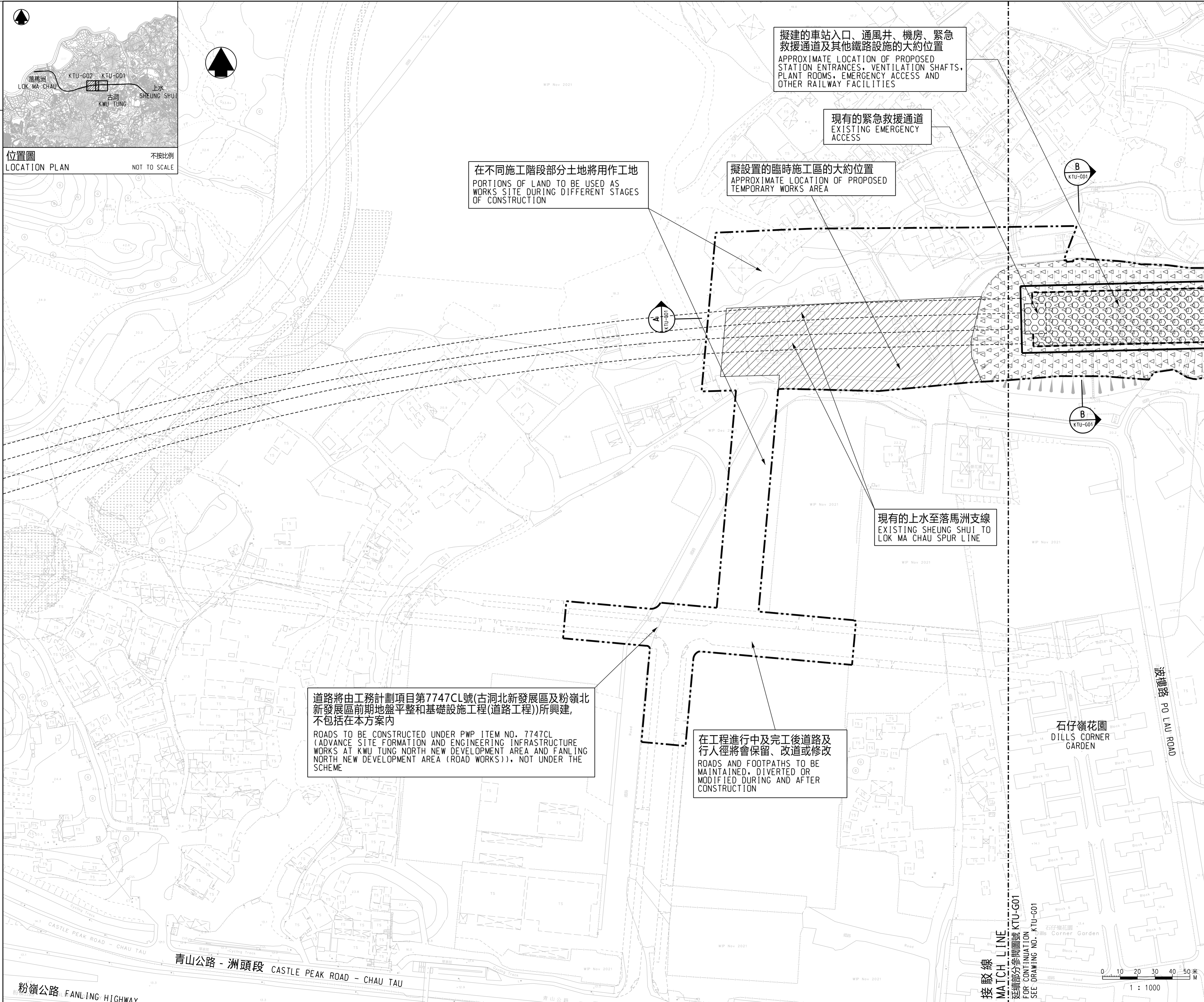

擬建的車站入口、通風井、機房、緊急救援通道及其他鐵路設施的大約位置
APPROXIMATE LOCATION OF PROPOSED STATION ENTRANCES, VENTILATION SHAFTS, PLANT ROOMS, EMERGENCY ACCESS AND OTHER RAILWAY FACILITIES

現有的緊急救援通道
EXISTING EMERGENCY ACCESS

擬設置的臨時施工區的大約位置
APPROXIMATE LOCATION OF PROPOSED TEMPORARY WORKS AREA

在不同施工階段部分土地將用作工地
PORTIONS OF LAND TO BE USED AS WORKS SITE DURING DIFFERENT STAGES OF CONSTRUCTION

現有的上水至落馬洲支線
EXISTING SHEUNG SHUI TO LOK MA CHAU SPUR LINE

道路將由工務計劃項目第7747CL號(古洞北新發展區及粉嶺北新發展區前期地盤平整和基礎設施工程(道路工程))所興建, 不包括在本方案內
ROADS TO BE CONSTRUCTED UNDER PWP ITEM NO. 7747CL (ADVANCE SITE FORMATION AND ENGINEERING INFRASTRUCTURE WORKS AT KWU TUNG NORTH NEW DEVELOPMENT AREA AND FANLING NORTH NEW DEVELOPMENT AREA (ROAD WORKS)), NOT UNDER THE SCHEME

在工程進行中及完工後道路及行人徑將會保留、改道或修改
ROADS AND FOOTPATHS TO BE MAINTAINED, DIVERTED OR MODIFIED DURING AND AFTER CONSTRUCTION

- 圖例 LEGEND :
- 方案界線
BOUNDARY OF THE SCHEME
 - 擬建的鐵路車站及其他鐵路設施(地下)
PROPOSED RAILWAY STATION AND OTHER RAILWAY FACILITIES (UNDERGROUND)
 - 擬建的車站/車站入口/通風井/其他鐵路設施或永久建築物
PROPOSED RAILWAY STATION/STATION ENTRANCES/VENTILATION SHAFTS/OTHER RAILWAY FACILITIES OR PERMANENT STRUCTURES
 - 現有的鐵路設施
EXISTING RAILWAY FACILITIES
 - 擬採用明挖回填法興建的鐵路設施或隧道(地下)
PROPOSED RAILWAY FACILITIES/TUNNELS BY CUT-AND-COVER METHOD (UNDERGROUND)
 - 擬設置地盤設施的臨時施工區
PROPOSED TEMPORARY WORKS AREA FOR SITE FACILITIES
 - 擬進行修改工程的現有上水至落馬洲支線
PROPOSED MODIFICATION WORKS OF THE EXISTING SHEUNG SHUI TO LOK MA CHAU SPUR LINE

一般說明 GENERAL NOTES:
1. 有關一般說明參閱圖號 KTU-G01.
FOR GENERAL NOTES, REFER TO DRAWING NO. KTU-G01.

修訂表
TABLE OF AMENDMENTS

修改 REV	日期 DATE	繪圖 BY	核對 SUB	負責 APP	說明 DESCRIPTION

SIGNED
林雨舟 LAM YU CHAU
路政署
鐵路拓展處副處長(1)
GOVERNMENT ENGINEER/
RAILWAY DEVELOPMENT (1)
HIGHWAYS DEPARTMENT

25 MAR 2022
發出日期 DATE OF ISSUE

圖則名稱 DRAWING TITLE
鐵路條例 (第519章)
位於古洞的鐵路車站
總體規劃圖則 2頁的第2頁

RAILWAYS ORDINANCE (CHAPTER 519)
RAILWAY STATION AT KWU TUNG
GENERAL LAYOUT PLAN SHEET 2 OF 2

圖號 DRAWING NO. KTU-G02
比例 SCALE 1:1000 (A1) 或如圖示 OR AS SHOWN

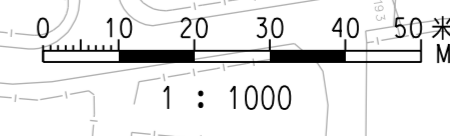

接駁線
MATCH LINE
延續部分參閱圖號 KTU-G01
FOR CONTINUATION
SEE DRAWING NO. KTU-G01

粉嶺公路 FANLING HIGHWAY

青山公路 - 洲頭段 CASTLE PEAK ROAD - CHAU TAU

石仔嶺花園
DILLS CORNER GARDEN

波德路 PO LAU ROAD