

# Temporary Traffic Arrangements on Tseung Kwan O Road

Highways Department Contract No. HY/2007/07  
Retrofitting of Noise Barriers on Tseung Kwan O Road

Issue 4 (May 2008)

## Temporary Traffic Arrangement (Contra-flow) on Tseung Kwan O Road (TKOR): (From 4 June 2008 to 17 June 2008)

In order to carry out noise barriers retrofitting works on TKOR, contra-flow will be implemented on the fast lane of TKOR (TKO bound near Hing Tin Estate), so that a lane towards Kwun Tong will be provided. The temporary traffic arrangements would be implemented as follows:

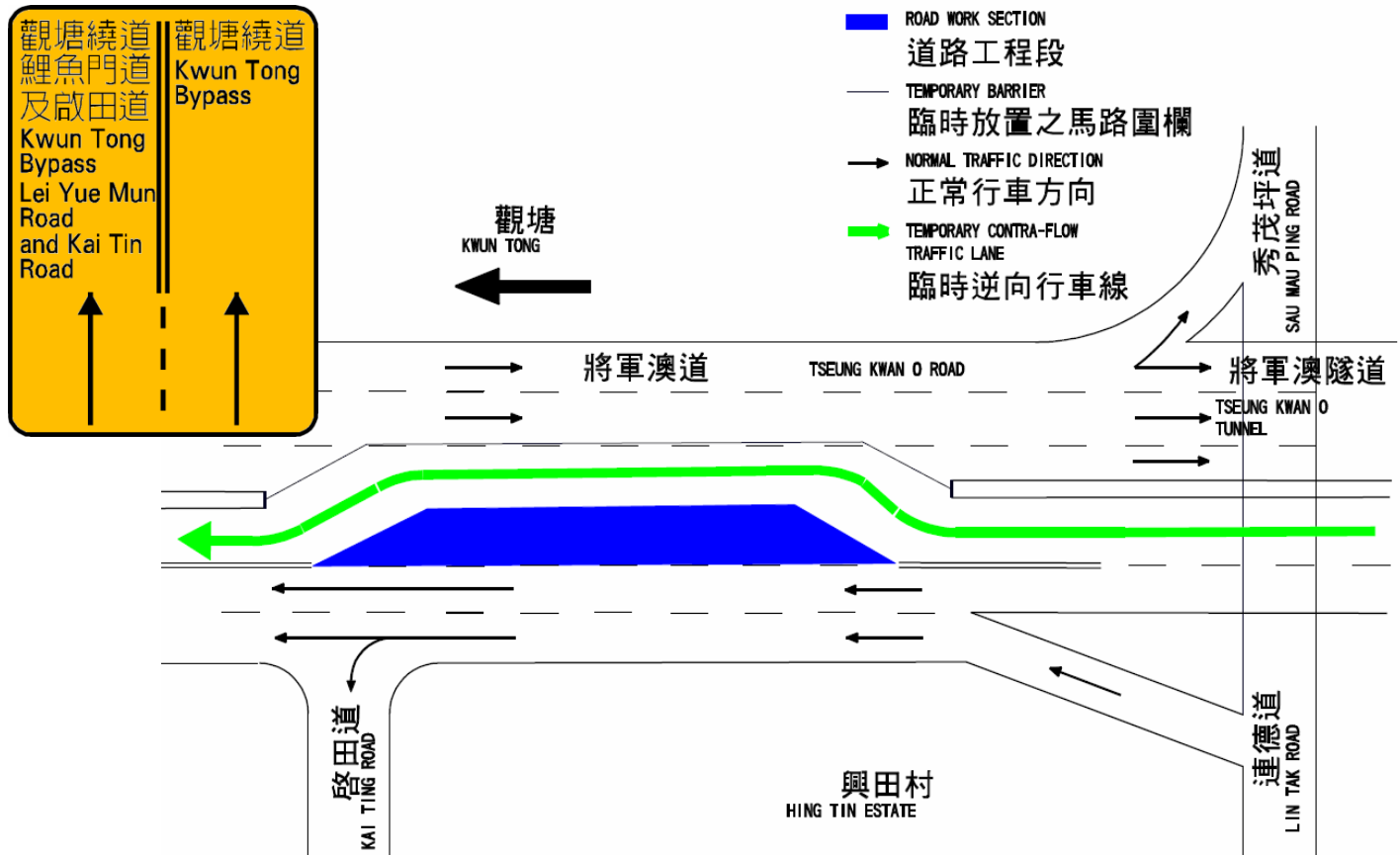

### Motorists to Kwun Tong Bypass:

Can make use of any traffic lanes after exiting Tseung Kwan O Tunnel

### Motorists to Kai Tin Road and

### Lei Yue Mun Road:

Should keep on the slow lane after exiting Tseung Kwan O Tunnel.

### Affected Public Transport Services:

#### (Travelling Time May Be Lengthened)

Bus Routes to and from Tseung Kwan O / Sai Kung  
690, 690P, 692, 692P, 694, 698R, 796B, 796C, 796S, 796X, 296A, 296C, 296D, 297, 93K, 98A, 98C, 98D, 98S, 98P, N691, E22A, N796, 893, N29

#### Bus Routes to Lam Tin

16, 16M, 216M

#### Green Minibus Routes to and from Tseung Kwan O / Sai Kung

10M, 13, 18, 102, 102B, 102S, 103, 105, 105S, 110, 111

#### Green Minibus Routes to Sau Mau Ping / Lam Tin

71A, 71B

#### Green Minibus Routes to Lam Tin / Yau Tong / Sau Mau Ping

76B

#### Red Minibus Routes

Mongkok ↔ Lam Tin

Kwun Tong ↔ Ping Tin

Jordan ↔ Lam Tin

Hip Wo Street ↔ Ko Chun Court Bus Terminus

Hip Wo Street ↔ Lei Yue Mun

Kwun Tong ↔ Sau Mau Ping (Sau Ming Road)

Highways Department will closely monitor the traffic conditions and implement any necessary measures to ensure that traffic impacts are kept to a minimum. If you have any suggestions or enquiries, please do not hesitate to contact us through the 24-hour hotline: 9630 6899.



Sun Fook Kong  
(Civil) Limited



Highways  
Department



Ove Arup & Partners  
HK Ltd